

RINGWOOD STATION ESTATE

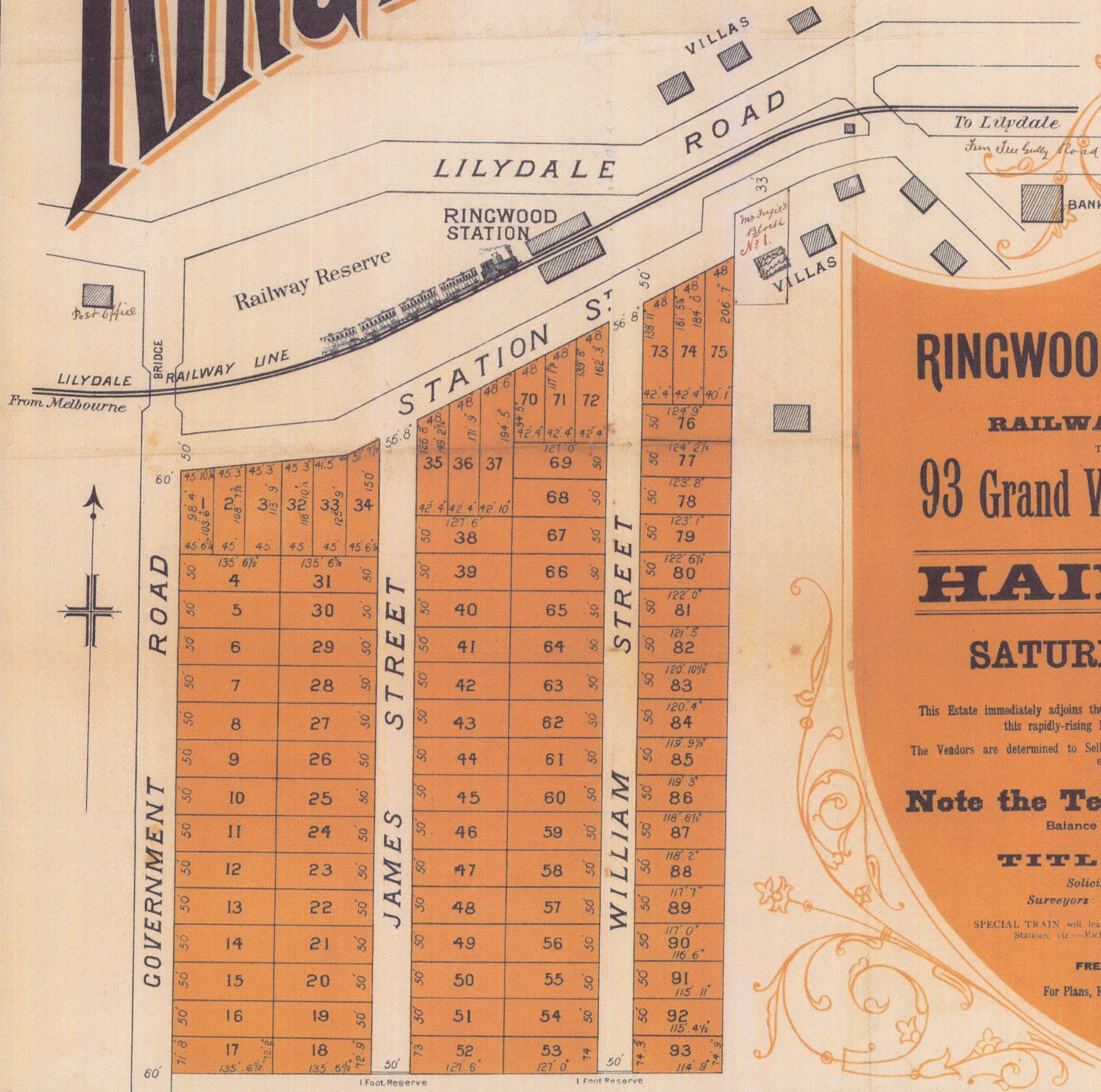

RINGWOOD STATION RESERVE

WITH LARGE FRONTAGES TO
RAILWAY STATION RESERVE

THIS SPLENDID ESTATE SUB-DIVIDED INTO
93 Grand Villa and Business Sites 93

WILL BE OFFERED BY AUCTION BY
HAIR & GILL

ON
SATURDAY, 27th OCTOBER,

AT THREE O'CLOCK, ON THE GROUND.

This Estate immediately adjoins the Station on the south side, which must necessarily become the Township site of this rapidly-rising District. Ringwood is the Junction of the Fern Tree Gully Line.
The Vendors are determined to Sell at anything near a reasonable figure, as the rise in value since their purchase enables them to offer real bargains to the Public.

Note the Terms: £10 per lot DEPOSIT

Balance 3, 6, 9, 12, 15, 18 Months at Six per cent.

TITLE CERTIFICATE.

Solicitor: SEYMOUR FERGIE, Elizabeth Street.
Surveyors: FOWLER & GATWARD, 12 Collins Street West.

SPECIAL TRAIN will leave PRINCE'S BRIDGE at Two o'clock, taking up Passengers at the following Stations, viz.—Richmond, Burnley, Hawthorn, Glenferrie, Auburn, Camberwell, Surrey Hills, Box Hill, and Mitcham.

FREE LUNCHEON IN SPACIOUS MARQUEE.

For Plans, Free Passes, and Full Particulars, apply at Auctioneers' Offices—

**16 COLLINS STREET WEST,
And at GLENFERRIE.**