

20.10.25.

RESIDENCE AT NO 2 HEARTHSTONE,
 COURT NORTH RINGWOOD DESIGNED
 BY IAN NAPIER REG. ARCHITECT,
 FELLOW AUSTRALIAN INSTITUTE OF ARCHITECTS,
 ASSOCIATE AUSTRALIAN INSTITUTE ARBITRATORS

This residence was built for my
 family. Refer also attached
 2 page article Australian Womens
 Weekly - 1968

It was designed when I was
 full of enthusiasm and energy
 at the age of 26 - fresh from
 R.M.I.T. and Melbourne University.
 and at this time I also
 designed a home for my sister -
 in-law Julian Cameron at
 43 WOOLKAT ST, STRATHMORE.

It also is very strong visually
 with pre dominance of brickwork
 Some say Frank Lloyd Wright
 influence - Refer Amayer for
 photos ..

In Melbourne climate I have a
 strong theme in my residential
 buildings - north sun into rooms.
 I couldn't do this here because
 it faced west.

The building has two powerful _____

2.

structures at both ends. They are solid brick walls without windows, single storey (north) double storey (south). These walls enclosed a timber post and beam design and an inviting large entrance porch. Refer notes on double post design. This central area is of timber construction and two storey in part incorporating a double car port. Note: the garage door was not part of the design as it was open when built, and must be replaced by a more sensitive design if necessary ???

The central timber area was nearly all glass (refer notes). Large areas of glass were not included in many modern designs of this era.

A recent visit by me to the residence revealed that the eastern aspect which was excavated material when built has now been planted with wonderful trees, so the atmosphere inside the glassed central area is now life being in a fish bowl with green, green, green, all around!

A feature of the house is a metal fireplace designed by the architect sitting at south end of Living Room (refer notes).

I believe the residence is worthy of preservation for future generations to see.
Ian Napier.

2 HEATHSIDE CRT NORTH RINKWOOD

FACTS AND FEATURES

30.10.25

- ① Freestanding fireplace in metal as brick alternative was not feasible - Refer sketch.
- ② The large windows were made possible as I obtained plate glass from recycled damaged shop fronts, at reasonable prices.
- ③ Brick walls were bagged with special cement based paint
- ④ Birch Box timber flooring was used throughout. refer photos in Womens Weekly
- ⑤ Double O B HW posts were used with padlocks (refer photos) Galvanised bolts were used with plastic tube protection. Oregon beams were used for roof structure.
- ⑥ The Design is,

BOLD

MODERN

TEUTONIC ? ?

1960's

WINTER

NORTH PRESERVING.

Van Napier

FIREPLACE FEATURE

2 Hearthside Court North Ringwood

* Concrete is compressed
& come made into boards.

possibly 'Concrete'

ceiling ↴

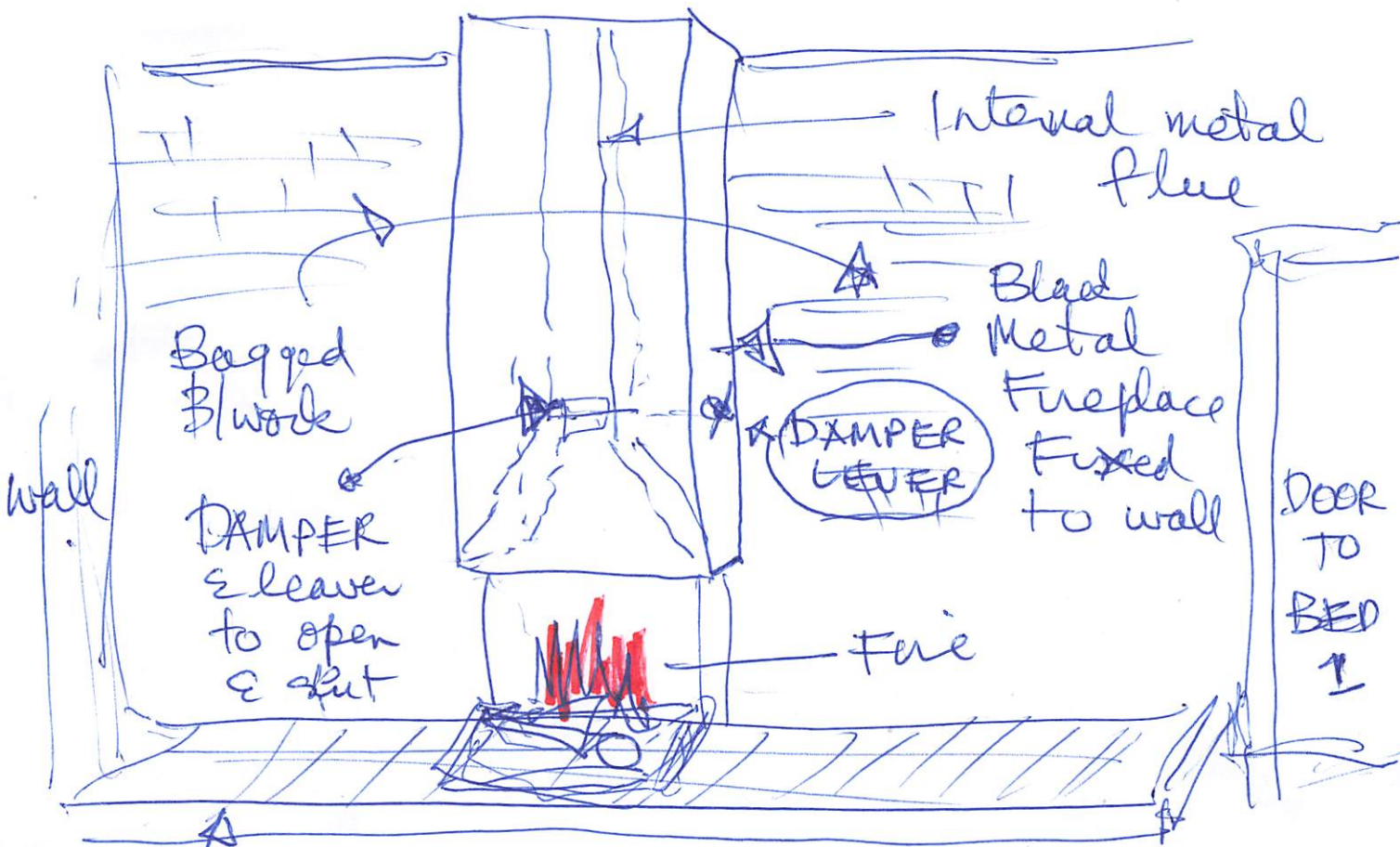

↴ Cantilevered concrete hearth (tiled)

DIAGRAM (1)