

*Recd 29/8*

23rd August, 1979

*8/58/UV.*

SCHEDULE

Attached is the first outline of the Olympic Village sports schedule. It is important to note that this schedule is a starting point and not the ultimate program.

We now invite you to consider the schedule, note your own sporting association's involvement or non/involvement and comment accordingly.

A number of sporting bodies are not in this outline for various reasons, some because they will be involved on their own sites and others because the nature of their activities has not yet been formulated. Please do not feel that your association has been in any way overlooked or treated disproportionately to any other body.

In the weeks ahead we hope to discuss World Sports Expo involvement with you and invite your objections and comments to this schedule.

In the meantime please fill in the attached coupon and forward it to:

World Sports Expo,  
Suite 8,  
350 Victoria Street,  
North Melbourne, 3051

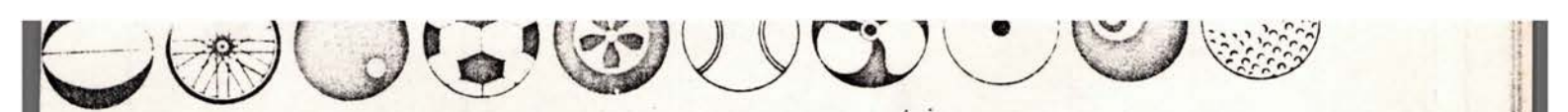

FRIDAY FEBRUARY 15

- 1.00pm City Procession to Exhibition Buildings;  
Sporting activities in the City Square  
(to be arranged).
- 2.00pm Official opening at Exhibition Buildings  
in Olympic Village area.  
Events schedule:
- 2.00pm Opening
- 2.30pm Gymnastics
- 3.15pm Basketball competitive match
- 4.00pm Volleyball competitive match
- 5.00pm Judo
- 6.00pm VFL Junior Football
- 7.00pm Archery
- 7.30pm Athletics
- 8.00pm Olympic Soccer action
- 8.40pm VFL Basketball
- 9.30pm Lacrosse
- 10.00pm Close

\*Note

Police skippers can be used intermittently  
for fill in.

FRIDAY FEBRUARY 15 to  
SUNDAY FEBRUARY 24

---

Olympic activities in other areas :

Cycling  
Boxing  
Wrestling  
Swimming  
Equestrian  
Ice Skating  
Rowing-Canoeing  
Skiing  
Weight Lifting  
Yachting  
Bowls

SATURDAY FEBRUARY 16  
TELEVISION DAY

---

Olympic Sporting Area Only :

10.00am	VFL Junior Football
11.00	Junior Basketball
12noon	Gymnastics to open telecast
12.15	Volleyball
1.00	Basketball
1.40	Archery
2.00	Soccer
2.40	VFL Olympics - Footy
3.00	Lacrosse
3.40	Indoor Cricket
4.40	Fencing
5.10	Fishing
5.30	Paravics wheelchair basketball
6.00	Badminton
7.00	Athletics
7.30	Soccer
8.15	Hockey
9.00	Volleyball
9.40	Judo
10.00	Close

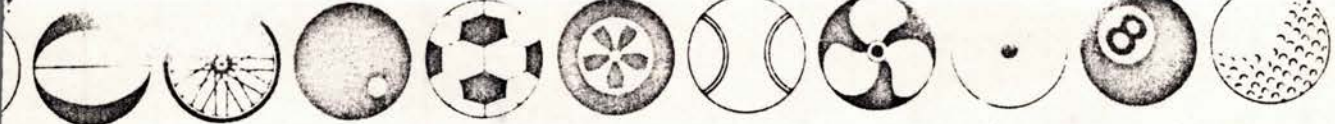

SUNDAY FEBRUARY 17  
TELEVISION DAY

---

Olympic Sporting Area Only :

- |         |   |
|---------|---|
| 10.00am | Junior Basketball   |
| 11.00   | Junior Football   |
| Noon    | In association with normal World Of Sport program; Carlton Bluebirds or a skating display to open |
| 12.15   | Hockey  |
| 1.00    | Indoor Cricket  |
| 2.00    | Gymnastics  |
| 2.15    | Volleyball  |
| 3.00    | Archery   |
| 3.15    | VFL Basketball  |
| 4.00    | Fly Casting   |
| 4.15    | Lacrosse  |
| 5.00    | Softball  |
| 5.45    | Soccer competition  |
| 6.30    | Gymnastics  |
| 7.30    | Badminton   |
| 8.00    | Volleyball  |
| 8.40    | Basketball  |
| 9.30    | Hockey  |
| 10.00   | Close   |

MONDAY FEBRUARY 18  
OFFICIAL TRADE DAY

---

From noon to 6.00pm the Olympic area will be available to any Olympic sporting group making application for its use

6.00pm	Badminton
6.45	Soccer
7.30	Volleyball
8.30	Indoor Cricket
9.30	Gymnastics or Lacrosse
10.00	Close



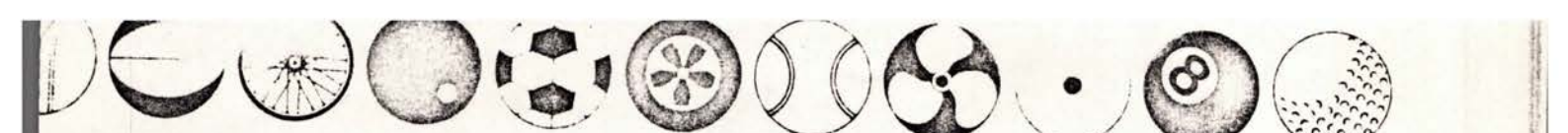

WEDNESDAY FEBRUARY 20

---

We would encourage the Wednesday afternoon to be a special effort for womens sports.

Noon	Netball
1.00pm	Judo
2.00	VFL Junior Football
3.00	Basketball
4.00	Volleyball
5.00	Lacrosse
6.00	Soccer
7.00	Indoor Cricket
8.00	VFL Basketball
9.00	Gymnastics
10.00	Close

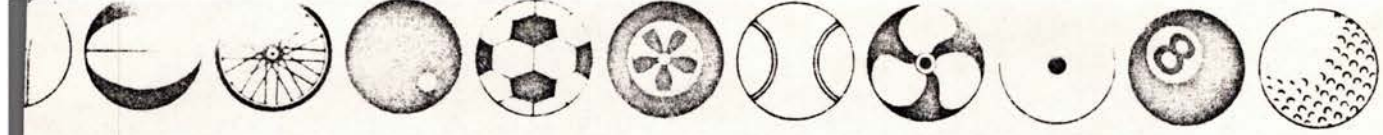

THURSDAY FEBRUARY 21

---

Noon	Netball
1.00pm	Hockey
2.00	Athletics
3.00	Badminton
4.00	Gymnastics
5.00	Junior Basketball
6.00	VFL Footy Olympics
7.00	Paravics
7.30	Archery
8.00	Volleyball
9.00	Basketball
10.00	Close

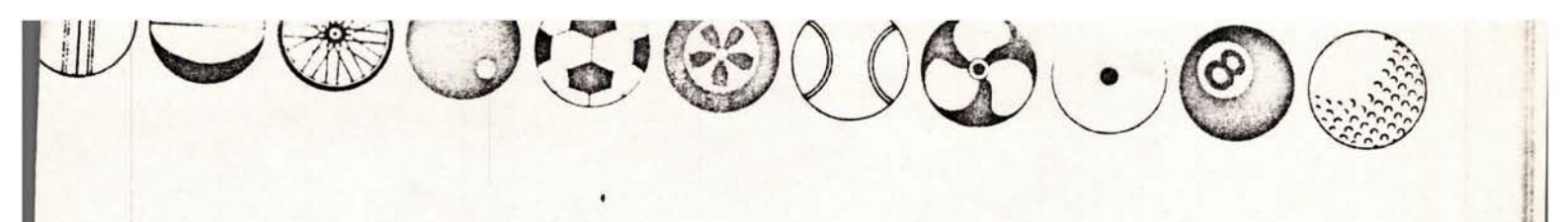

FRIDAY FEBRUARY 22

---

Noon	Police Skipping, Gymnastics Judo
1.00pm	Junior Football
2.00	Softball
3.00	Badminton
4.00	Various events: Fencing, fly casting etc.
5.00	Netball
6.00	Indoor Cricket
7.00	Volleyball or VFL Basketball
8.00	Soccer
9.00	Lacrosse
10.00	Close

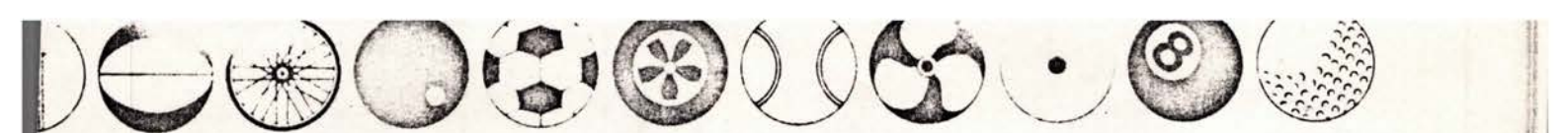

SATURDAY FEBRUARY 23  
TELEVISION DAY

---

Telecasts will be intermittent with crosses to Winter Olympics and Caulfield Races.

10.00am	Junior Football
11.00	Junior Basketball
Noon	Open Telecast on Gymnastics
1.00	Indoor Cricket
2.00	Volleyball
2.40	Basketball
3.30	Athletics
4.00	Archery
5.00	Lacrosse
6.00	Paravics
6.40	Fly Casting
7.00	VFL Basketball
8.00	Hockey
9.00	Judo
10.00	Close



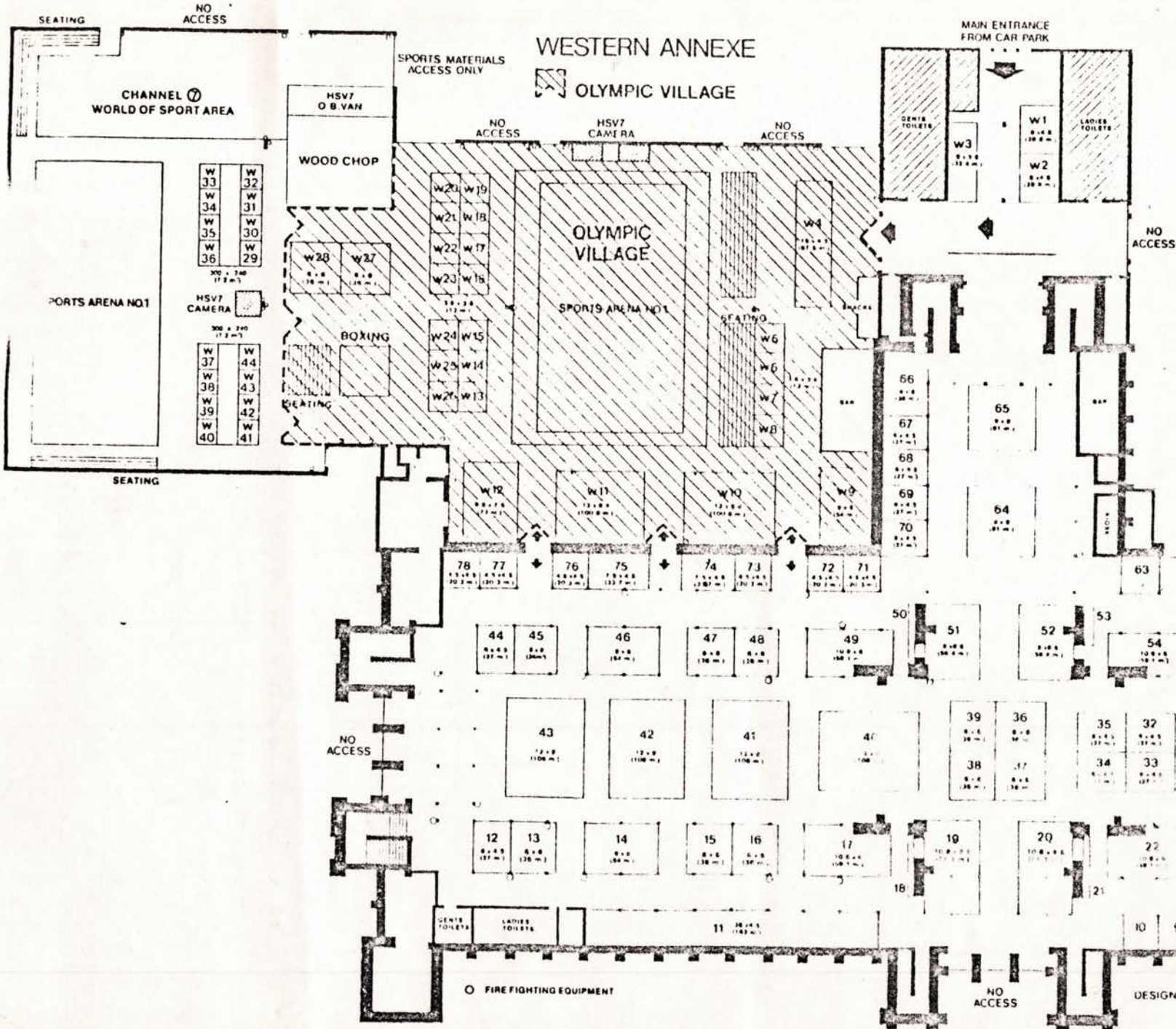

FEBRUARY 16 - 24, 1980  
 EXHIBITION BUILDINGS, MELBOURNE  
 ENQUIRIES  
 WORLD SPORTS EXPO  
 SUITE B, 350 VICTORIA STREET, NORTH MELBOURNE. 3  
 TELEPHONE (03) 329 9699

DESIGN CONSULTANT PETER MATTHEWS DESIGN

23rd August, 1979

VOLLEYBALL

General discussions have already taken place with your association and we can see no reason why the presentation of your sport shouldn't be a highlight of World Sports Expo.

We will undertake to supply sufficient permanent space to suit your requirements and we will be in touch with you in the near future to finalise arrangements and adjust the preliminary time schedule to suit your own requirements.

The times scheduled are:

Friday	February	15	4.00 - 5.00pm	
Saturday	"	16	12.15 - 1.00pm	(television period)
			9.00 - 9.40pm	
Sunday	"	17	2.15 - 3.00pm	(television period)
			8.00 - 8.40pm	
Monday	"	18	7.30 - 8.30pm	
Tuesday	"	19	7.00 - 8.00pm	(special school clinic day)
Wednesday	"	20	4.00 - 5.00pm	
Thursday	"	21	8.00 - 9.00pm	
Friday	"	22	7.00 - 8.00pm	
Saturday	"	23	2.00 - 2.40pm	(television period)
Sunday	"	24	12.40 - 1.20pm	(television period)
			8.30 - 9.30pm	