



FORTUNA VILLA IN GROUND FLOOR

MUSIC ROOM

This large room with its impressive decorative ceiling was the main drawing room of the Villa. Musical homilies, such as 'If music be the food of love-play on', can still be seen on the remaining stained glass windows. The original open colonnade at the eastern end of the room was enclosed by a previous renovation during the 1890's. Further work in 1904 extended the room to its current size.

CONSERVATORY

The conservatory with its etched glass and Italian theme dates from 1876, following a trip to Europe by Lansell. The conservatory features glass workmanship of the highest quality, regarded as among the most important examples of its type in Australia. The Design features panels of Ruby Flashed Seedless French Antique glass, as well as frosted acid-etched glass walls, containing a variety of artistic designs, including mining scenes, Australiana and heraldic symbols.

RECEPTION ROOM

On arrival at Fortuna, Lansell's guests were ushered into the reception room after being received in the entrance foyer. Part of the original Villa, the bay window was added in 1875. The niche, pressed metal ceilings, cut glass skylight and parquetry are thought to have been added around 1895.

STAIRCASE

The main staircase with hall seat is cedar and blackwood, and was added in 1888 to gain access to the newly added third floor. Remodelled to its present form in 1907, the upper balcony can be seen cutting across the large stained leadlight window of an earlier period.

BEDROOMS

On either side of this passageway were the main bedrooms, each with its own bathroom containing a marble bath, toilet basin and cedar cabinet work.

POMPEII FOUNTAIN

The Pompeii Fountain was constructed in 1879 and is a scale replica of the Great Fountain in Pompeii, Italy. It is believed that Lansell saw the Great Fountain on a trip to Europe in 1875 and requested the construction of a replica soon after his return to Fortuna. Comprising a number of water features, statues and a tall Roman column surmounted by a statue of a small boy, the fountain has outstanding aesthetic qualities and is believed to be unique in Australia. It is possibly the only scale replica of the Great Fountain in the world.

CRUSHING BATTERY

The main mining plant, a 30 head stamper battery constructed in 1874, was attached to the northern end of the villa complex. For many years the tall chimney stack of the plant stood side by side with the villa. The chimney and the plant's machinery were removed in the 1940s when the structure was converted for use as the Survey Regiment's printing press. Despite the removal of the machinery, the battery remains essentially in its original condition.

FORMATION HANDOUT

2 - PART 2 OF TOUR

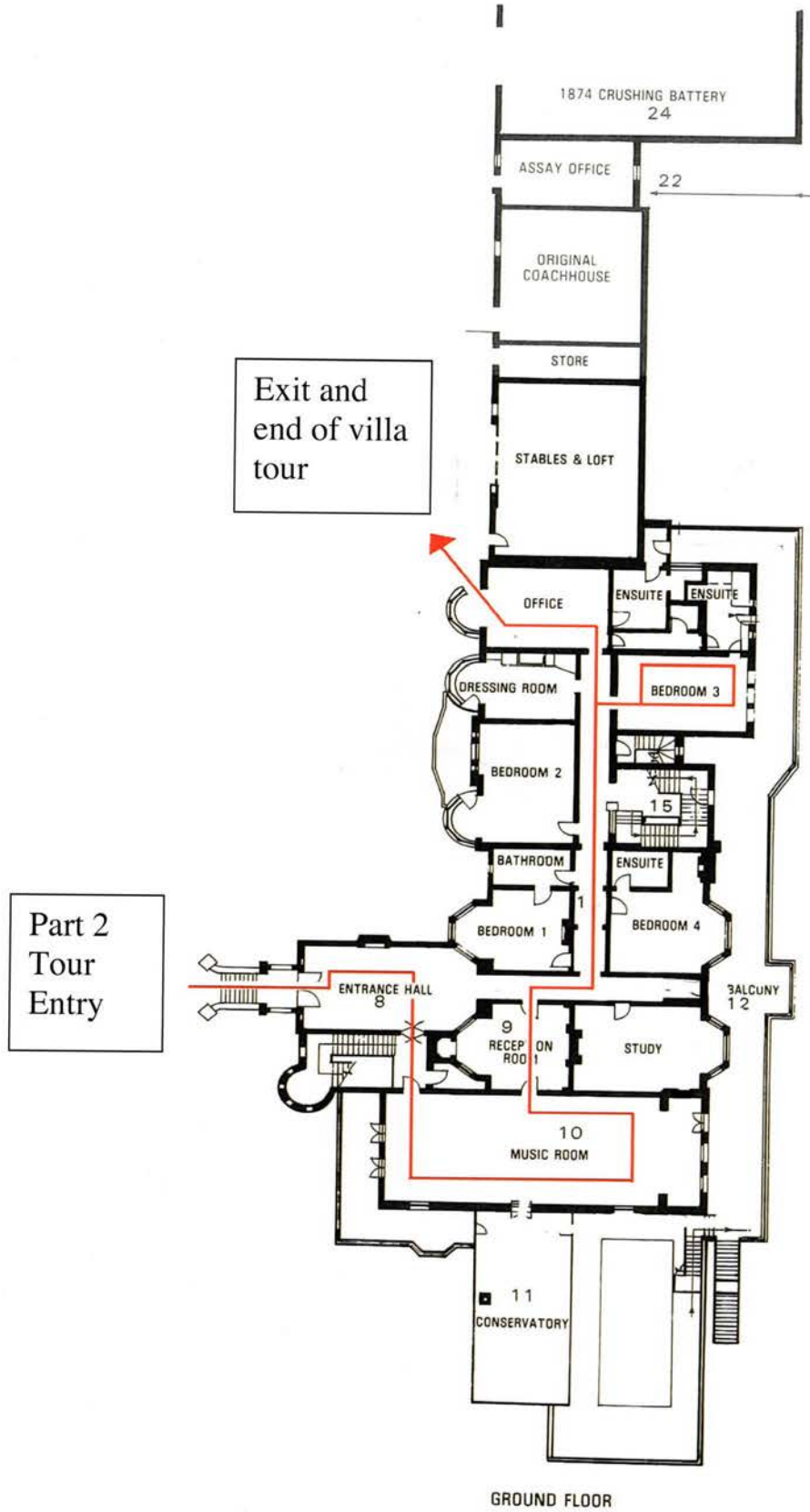



FORTUNA VILLA IN LOWER FLOOR

ARCHITECTURAL DETAILS of the VILLA

The villa is 'flamboyant', representative of a conglomeration of contemporary architectural styles orchestrated over a considerable period (1861—1934) by some of Bendigo's finest architects including Vahland, Getzschmann and Beebe. Fortuna is a physical expression of Lansell's wealth over a long period and his passion for the villa and the grounds.

'ROMAN BATH'

From the east entrance to the villa the former swimming pool known as the 'Roman Bath' can be seen. The building was possibly built as early as 1870 and was originally used as a tailings treatment plant. It was converted into a pool after 1888. The ten foot high brick wall was roofed and a floor built by the Army in 1942, and the building was used for photographic processing.

ORIGINAL ENTRANCE

The villa was originally constructed by the Ballerstedt family as a large red brick, two-storey house which faced east with a commanding view over the township of Sandhurst. The Ballerstedt villa was remodelled extensively by George Lansell over decades, and a new main entrance was created on the western side.

TURRET & STAIRWELL

The turret and stairwell are of Second Empire influence with its rounded tower, stained glass windows and decorative lead roof. The cupola is one of many architectural features that, combined with the other significant features of the house, give Fortuna its distinctive appearance. An interesting feature is the inscription on the leadlight windows - 'East or West Home is Best'.

DINING ROOM

Added in 1869 by the Ballerstedts, this dining room was extended in 1900 and again in 1904. It is now referred to as 'the Ballroom'. Solid doors, elaborate parquette flooring and a large square bay window with fine examples of free style lead-lighting are features of this room.

BILLIARD ROOM

Built in 1893 this was the last of three billiard rooms constructed by Lansell. In recent years the split level floor was raised to the same level as the adjoining rooms. The ornamental principal ceiling was at one time reputed to be the finest piece of craftsmanship of its type in Victoria.

ENTRANCE HALL

The main entrance hall, which replaced the original Ballerstedt entrance on the eastern side of the villa, was constructed in 1895. Lansell commissioned many conceptual architectural drawings throughout the time of his occupancy at Fortuna.

INFORMATION HANDOUT PART 1 OF TOUR

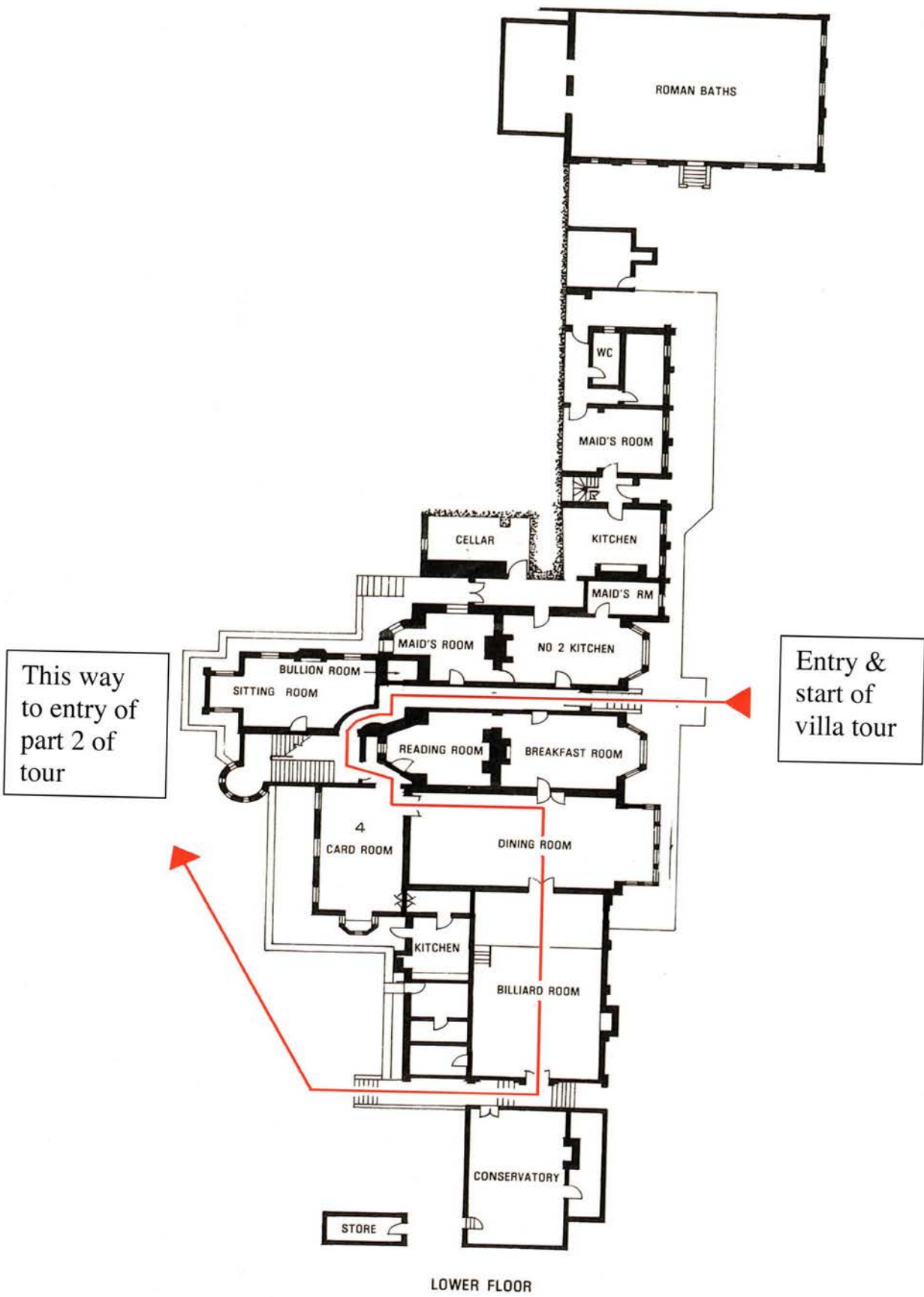

LOWER FLOOR