

Dear Wal,  
I got your parcel away tonight from Birmingham as it might be at Ballard on Sat. morning, here's hoping, freight 5/3.

Have been working on "Mare" of late. Got the smoketank shaped up and it makes the boiler look a length. 18" + 4". Since then it has been nose down to the drawing board and I think I have knocked out a fair free-lance design. I never wanted to stick to the letter as I like outside piston valves & Baker gear like our 620's. Because my method of construction is slightly different the smoketank externally is the same length but the distance "E" becomes 1" longer (originally telescoped 1") "F" increased 1/2" (stack) to equal 14" leading G. also about 9" wide. Because of "E" A, B, C were lengthened to (1) allow piston v. cylinders of a 3 1/2" Biltmore (B.R. standard class 7 4-6-2) to fit comfortably between boiler wheels and lining the line of cylinders beneath line of stack set 2 1/2" from front of "smoketank". "D" may be lengthened with to fit good looking coil. Note high running board. As these cylinders are 5" longer in stroke than originally specified I have scrapped ideas of 3 cyls. & compounds. But will try and make provision for a small angle cylinder booster on the trailing pony truck. It will retain its VR type dome. But features I will be taken at random from here class such as I have stated, I think heading, auto coupler and Pilot could make here an advice to the ground

31 Down Rd,  
Billie S. S.  
6<sup>th</sup> Jan 1955.

Diagram I sent last time of structure is not correct, part of roof is new on and 300 will look like this if OK L L L L L.

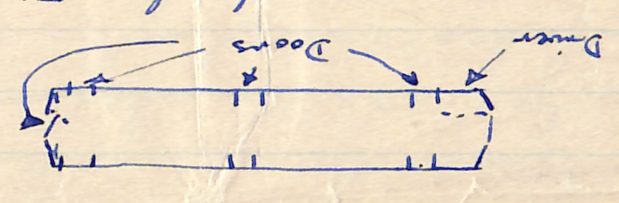
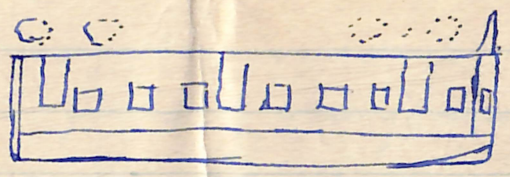

I hear some of the Fi are due for rebuilding soon so looks like the end of the road. I am not asking for it yet, but would it be possible for you to get some yellow bricks for me and pay and then over in a foot box or part there off. This is a favorite place for live steamers in Sydney and I would like to try come later on when the boiler is finished.

Heck! when the sparks was on your train either the noise was mighty loud or you got yourself a hearing aid, I see where they are going to put ballast on the 1's

One of our members was going to buy and film the Calce NG these holidays, last time he got the 5 on the 50P up at Tallarook a day before I was at Seymour, (I was up at Bothung a spinal) and before that he got some good shots of Gumbrook line.

The Gyner, delicatessen & paper shops have have changed hands lately, the latter two for the latter, a hardware shop has opened alongside. The shaft mill also a great loss. Bush fire held on Onkaparinga River about 300yds from Benthams house but it broke thru moorlandside and circled Baltham and went towards Moirne. Upper Stuart Station burnt down. I have not forgotten negs for you. Yours. <sup>Over</sup>

of. Any suggestions and comments welcome.  
 On Dec 23<sup>rd</sup> was called into Adel Sta and quite unexpectedly went on trial run with #250 & #252 the latter is only a trailer as yet. went out to Bowmans and back via Hamley Bridge. anyway I got muck in my L-eye, ~~so~~ "I could have pulled a cinder out" but I went to the Adel. Hospt. on the Friday and they dug it out but tied my eye up. and had to go back on Xmas Day and they tied it up again and I was on my way to Mt Compass for Xmas Dinner, by this time I was getting used to using one eye for driving. When I returned to work on Wed 29<sup>th</sup> damn if I did not collect another lot of muck in same eye. but not so bad this time. On Jan 2<sup>nd</sup>

On Jan 2<sup>nd</sup> Besides being Black Sunday a service of twice on Sundays 2<sup>nd</sup>, 9<sup>th</sup>, 23<sup>rd</sup> 20<sup>th</sup> of a train to Reynella, I think it is an F class, must go to Reynella next Sunday!  
 Fo, They work 13<sup>3</sup>/<sub>4</sub> M to Outer Harb., 16 M to Penfield and looks like 17<sup>1</sup>/<sub>2</sub> M to Reynella, one regular run is the M-F up 446 pm to Adel. from Penfield.

What was the Melb. meeting like? Our (ARRS) branch this year had a 16 M movie show with films on VR. ("ON TIME") (Melb. suburban working SAR (?) (railway in general), LMSR (building a Duchess class 6207 at Crewe, and South Bank Exhib in London 1951 (~~Model~~ Miniature railway (2ft 6) with locos by cartoonist Emmett of Nellie, Neptune (paddle-Single wheeler and Snow Goose, trains to Jar-Twittering every few minutes, also a film by S. Railway on Waterloo Station. Then a night royal supper with a cake with a railway motif m-----! also played recordings of "Sparky and his talking train" and Choo-choo train to give the atmosphere. No business this night.