

## HISTORICAL SEARCH STATEMENT

## Land Use Victoria

Produced 10/06/2024 10:06 PM

Volume 8768 Folio 192

Folio Creation: Created as paper folio continued as computer folio

Parent title Volume 07613 Folio 143

THE IMAGE OF THE FOLIO CEASED TO BE THE DIAGRAM LOCATION ON 12/06/2002 08:30:15 PM

### RECORD OF HISTORICAL DEALINGS

Date Lodged for Registration	Date Recorded on Register	Dealing	Imaged	Dealing Type and Details
------------------------------	---------------------------	---------	--------	--------------------------

### RECORD OF VOTS DEALINGS

Date Lodged for Registration	Date Recorded on Register	Dealing	Imaged
------------------------------	---------------------------	---------	--------

22/12/2021	22/12/2021	AV181017P (E)	N
------------	------------	---------------	---

DISCHARGE OF MORTGAGE  
AFFECTED ENCUMBRANCE(S) AND REMOVED MORTGAGE(S)  
MORTGAGE R326617H

22/12/2021	22/12/2021	AV181018M (E)	N
------------	------------	---------------	---

DISCHARGE OF MORTGAGE  
AFFECTED ENCUMBRANCE(S) AND REMOVED MORTGAGE(S)  
MORTGAGE M956842Y

22/12/2021	22/12/2021	AV181019K (E)	N
------------	------------	---------------	---

TRANSFER OF LAND BY ENDORSEMENT

FROM:

PAULINE BOX

ALLEN DAVID CRAWLEY

TO:

RESULTING PROPRIETORSHIP:

Estate Fee Simple

Joint Proprietors

BENJAMIN PAUL NEAGLE

NICOLE LOUISE NEAGLE both of 5 JUMPING CREEK ROAD WONGA PARK VIC 3115

AV181019K 22/12/2021

22/12/2021	22/12/2021	AV181020B (E)	N
------------	------------	---------------	---

MORTGAGE OF LAND

MORTGAGE AV181020B 22/12/2021

SECURE FUNDING PTY LTD

STATEMENT END

### VOTS Snapshot

VOLUME 08768 FOLIO 192  
124094589713X

**LAND DESCRIPTION**

Lot 3 on Plan of Subdivision 084020.  
PARENT TITLE Volume 07613 Folio 143  
Created by instrument LP084020 01/04/1969

**REGISTERED PROPRIETOR**

Estate Fee Simple  
TENANTS IN COMMON  
As to 1 of a total of 2 equal undivided shares  
Sole Proprietor  
    PAULINE BOX of 5 JUMPING CREEK RD WONGA PARK  
As to 1 of a total of 2 equal undivided shares  
Sole Proprietor  
    ALLEN DAVID CRAWLEY of 5 JUMPING CREEK RD WONGA PARK  
    M956841C 27/07/1987

**ENCUMBRANCES, CAVEATS AND NOTICES**

MORTGAGE M956842Y 27/07/1987  
    THE COMMISSIONERS OF THE STATE BANK OF VICTORIA  
  
MORTGAGE R326617H 07/05/1991  
    COMMONWEALTH BANK OF AUSTRALIA

Any encumbrances created by Section 98 Transfer of Land Act 1958 or Section 24 Subdivision Act 1988 and any other encumbrances shown or entered on the plan or imaged folio set out under DIAGRAM LOCATION below.

**DIAGRAM LOCATION**

SEE LP084020 FOR FURTHER DETAILS AND BOUNDARIES

VOLUME 08768 FOLIO 192  
VOLUME 08768 FOLIO 192  
VOLUME 08768 FOLIO 192  
124094589714W  
124094589715V  
124094589716U  
Produced 22/12/2021 03:52 PM  
Produced 22/12/2021 03:52 PM  
Produced 22/12/2021 03:52 PM

**HISTORICAL SEARCH STATEMENT**

**Land Use Victoria**

LAND DESCRIPTION  
LAND DESCRIPTION

**LAND DESCRIPTION**

-----

Lot 3 on Plan of Subdivision 084020.  
Lot 3 on Plan of Subdivision 084020.  
Lot 3 on Plan of Subdivision 084020.  
PARENT TITLE Volume 07613 Folio 143  
PARENT TITLE Volume 07613 Folio 143  
PARENT TITLE Volume 07613 Folio 143  
Created by instrument LP084020 01/04/1969  
Created by instrument LP084020 01/04/1969  
Created by instrument LP084020 01/04/1969

REGISTERED PROPRIETOR  
REGISTERED PROPRIETOR

**REGISTERED PROPRIETOR**

-----

Estate Fee Simple  
Estate Fee Simple  
Estate Fee Simple  
TENANTS IN COMMON  
TENANTS IN COMMON  
TENANTS IN COMMON  
As to 1 of a total of 2 equal undivided shares  
As to 1 of a total of 2 equal undivided shares  
As to 1 of a total of 2 equal undivided shares  
Sole Proprietor  
Sole Proprietor  
Sole Proprietor  
    PAULINE BOX of 5 JUMPING CREEK RD WONGA PARK  
    PAULINE BOX of 5 JUMPING CREEK RD WONGA PARK  
    PAULINE BOX of 5 JUMPING CREEK RD WONGA PARK  
As to 1 of a total of 2 equal undivided shares  
As to 1 of a total of 2 equal undivided shares  
As to 1 of a total of 2 equal undivided shares  
Sole Proprietor  
Sole Proprietor  
Sole Proprietor  
    ALLEN DAVID CRAWLEY of 5 JUMPING CREEK RD WONGA PARK  
    ALLEN DAVID CRAWLEY of 5 JUMPING CREEK RD WONGA PARK  
    ALLEN DAVID CRAWLEY of 5 JUMPING CREEK RD WONGA PARK  
M956841C 27/07/1987  
M956841C 27/07/1987  
M956841C 27/07/1987

ENCUMBRANCES, CAVEATS AND NOTICES  
ENCUMBRANCES, CAVEATS AND NOTICES

**ENCUMBRANCES, CAVEATS AND NOTICES**

-----  
MORTGAGE M956842Y 27/07/1987  
MORTGAGE M956842Y 27/07/1987  
MORTGAGE M956842Y 27/07/1987  
THE COMMISSIONERS OF THE STATE BANK OF VICTORIA  
THE COMMISSIONERS OF THE STATE BANK OF VICTORIA  
THE COMMISSIONERS OF THE STATE BANK OF VICTORIA

MORTGAGE R326617H 07/05/1991  
MORTGAGE R326617H 07/05/1991  
MORTGAGE R326617H 07/05/1991  
COMMONWEALTH BANK OF AUSTRALIA  
COMMONWEALTH BANK OF AUSTRALIA  
COMMONWEALTH BANK OF AUSTRALIA

Any encumbrances created by Section 98 Transfer of Land Act 1958 or Section  
Any encumbrances created by Section 98 Transfer of Land Act 1958 or Section  
Any encumbrances created by Section 98 Transfer of Land Act 1958 or Section  
24 Subdivision Act 1988 and any other encumbrances shown or entered on the  
24 Subdivision Act 1988 and any other encumbrances shown or entered on the  
24 Subdivision Act 1988 and any other encumbrances shown or entered on the  
plan or imaged folio set out under DIAGRAM LOCATION below.  
plan or imaged folio set out under DIAGRAM LOCATION below.  
plan or imaged folio set out under DIAGRAM LOCATION below.

DIAGRAM LOCATION  
DIAGRAM LOCATION

**DIAGRAM LOCATION**

-----  
SEE LP084020 FOR FURTHER DETAILS AND BOUNDARIES  
SEE LP084020 FOR FURTHER DETAILS AND BOUNDARIES  
SEE LP084020 FOR FURTHER DETAILS AND BOUNDARIES

---

**Paper Title Images**

8768/192 - Version 0, Date 05/02/2000

**ORIGINAL**

**NOT TO BE TAKEN FROM THE OFFICE  
OF TITLES**



VICTORIA

REGISTER BOOK

VOL. 8768 FOL. 192

# Certificate of Title

UNDER THE "TRANSFER OF LAND ACT"

VOL. 8768 FOL. 192

MAXWELL LESLIE SWIFT Builder and LORNA MARIA SWIFT Home Duties - - - -  
both of Yarra Road Wonga Park are joint proprietors of an estate in ----  
fee simple subject to the encumbrances notified hereunder in so much as ---  
lies above the depth of Fifty feet below the surface of ALL THAT piece ----  
of land coloured on the map hereon being Lot 3 on Plan of Subdivision ----  
No.84020 Parish of Warrandyte County of Evelyn - - - - -

Issued under Regulation 12 on the approval of the above Plan of Subdivision

*H.B. Spencer*



Assistant Registrar of Titles

ENCUMBRANCES REFERRED TO

MORTGAGE A.255422 - - -

THE ABOVE MORTGAGE IS  
**DISCHARGED**  
21 APR 1969

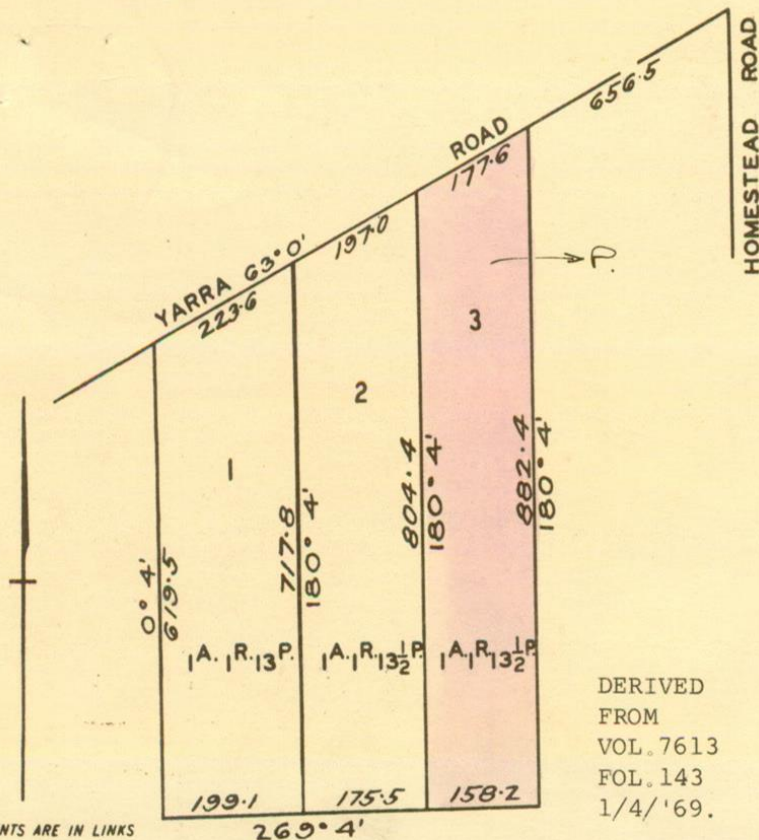

DERIVED  
FROM  
VOL. 7613  
FOL. 143  
1/4/'69.



RIACHELLA PROPRIETARY LIMITED of 472  
Bourke Street Melbourne is now the  
proprietor  
Registered 21st April 1969  
No. D369337



MORTGAGE  
THE COMMISSIONERS OF THE STATE BANK OF  
VICTORIA  
REGISTERED 27/7/87  
M956842Y



ALAN HARRY BOX Solicitor and PAULINE  
BOX Married Woman both of Yarra Road  
Wonga Park are now JOINT PROPRIETORS  
Registered 28th September 1973  
No. F22959



MORTGAGE TO COMMONWEALTH  
BANK OF AUSTRALIA  
Registered - 7 MAY 1991  
No. R326617H



MORTGAGE TO THE COMMERCIAL SAVINGS  
BANK OF AUSTRALIA LIMITED

Registered 13 AUG 1974  
No. F420100

DISCHARGED  
3 APR 1986

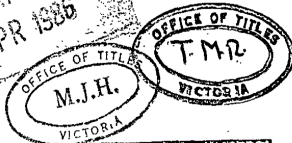

PROPRIETOR  
PAULINE BOX OF 5 JUMPING CREEK RD.  
WONGA PARK  
REGISTERED 9/4/86  
M215816W



MORTGAGE  
NATIONAL AUSTRALIA BANK LIMITED  
REGISTERED 9/4/86  
M215817T

DISCHARGED  
27 APR 1987



PROPRIETORS  
TENANTS IN COMMON IN EQUAL SHARES  
PAULINE BOX & ALLEN DAVID CRAWLEY OF 5  
JUMPING CREEK RD. WONGA PARK  
REGISTERED 27/7/87  
M956841C



T08768-192-1-1

V.8768 F. 192