



# Imaged Document Cover Sheet

The document following this cover sheet is an imaged document supplied by LANDATA®, Secure Electronic Registries Victoria.

Document Type	<b>Cancelled Title</b>
Document Identification	<b>8280/488</b>
Number of Pages (excluding this cover sheet)	<b>4</b>
Document Assembled	<b>10/05/2024 14:00</b>

**Copyright and disclaimer notice:**

© State of Victoria. This publication is copyright and includes confidential information. No part may be reproduced by any process except in accordance with the provisions of the Copyright Act or pursuant to a written agreement. The State of Victoria does not warrant the accuracy or completeness of the information in this publication and any person using or relying upon such information does so on the basis that the State of Victoria shall bear no responsibility or liability whatsoever for any errors, faults, defects or omissions in the information.

The document is invalid if this cover sheet is removed or altered.

NOT TO BE TAKEN FROM THE  
OFFICE OF TITLES



CANCELLED  
REGISTER BOOK

VOL. 8280 FOL. 488

20-3-1961

CERTIFICATE OF TITLE UNDER THE "TRANSFER OF LAND ACT"

MARY JOYCE GRAY of 97 Broughton Road Surrey Hills Married Woman is now the proprietor of an estate in fee simple subject to the encumbrances notified hereunder in so much as lies above the depth of Fifty feet below the surface of ALL THAT piece of land delineated and coloured purple on the map in the margin containing Twenty acres Three roods Six perches and eight-tenths of a perch or thereabouts being part of Crown Allotment 9<sup>H</sup> Parish of Warrandyte

DATED the 24th day of October 1960.

ORIGINAL

*A. H. Hall*

Assistant Registrar of Titles

ENCUMBRANCES REFERRED TO

THE WHOLE OR PART OF THE WITHIN LAND HAS BEEN SUBDIVIDED SEE Unregistered Plan Misc. Plan L. P. 45637 N<sup>o</sup>A 766740

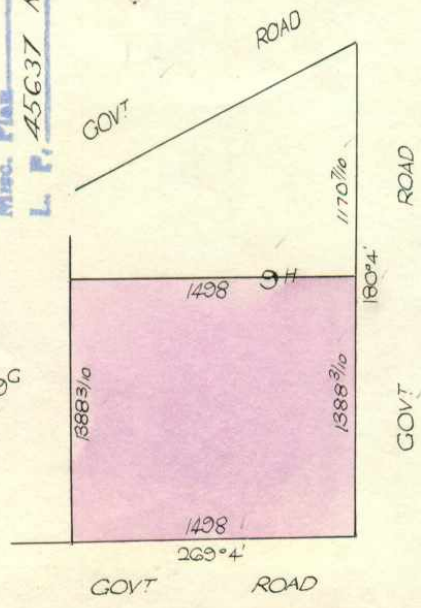

MEASUREMENTS ARE IN LINKS

Delivered on-line by LANDATA®

WARNING This document provides an image of a cancelled folio of the Register. It is not a statement from the register of subsisting information in relation to the land to which it refers.



VOL. 8280 FOL. 488

VOL. 3850 FOL. 822

INSTRUMENT B86317

APPLICATION

6578/50

TRANSFER AS TO PART No. B430739

registered 30<sup>th</sup> May 1962

CANCELLED AS TO PART

See Vol. 8445 Fol. 444

Lot 2



TRANSFER AS TO BALANCE No. D387272

registered 12<sup>th</sup> May 1969

243

CANCELLED See Vol. 87860L



CANCELLED

Delivered on-line by LANDATA®  
This document provides an image of a cancelled folio of the register. It is not a statement from the register of existing information in relation to the land to which it refers.

WARNING



SCALE: 6 CHAINS. to one inch

Volume 8280. Folio - 488.

Delivered on-line by LANDATA®

WARNING This document provides an image of a cancelled folio of the Register. It is not a statement from the register of subsisting information in relation to the land to which it refers.

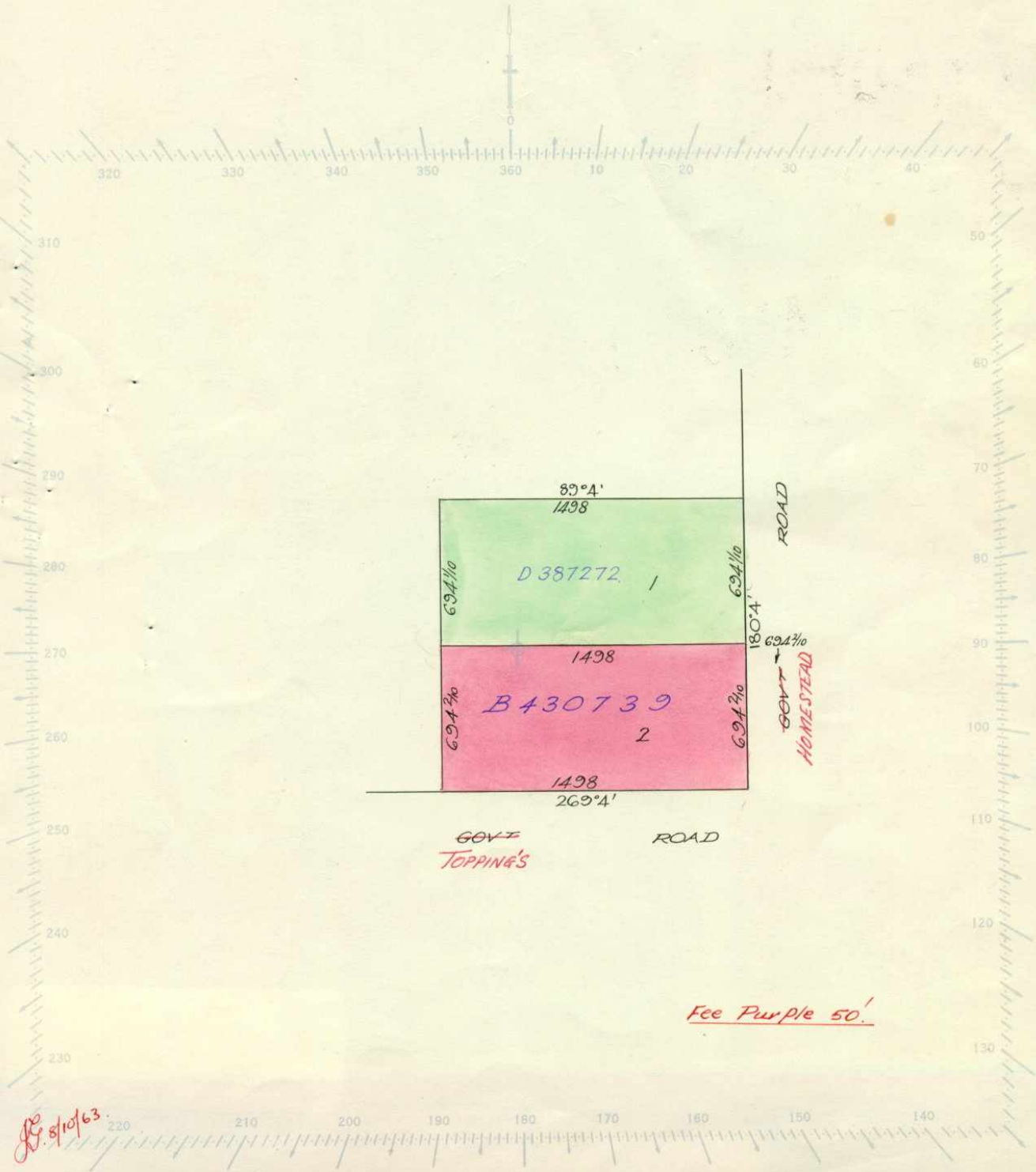

Delivered  
on-line by  
LANDATA®

WARNING  
This document provides an image of a cancelled folio of the Register. It is not a statement  
from the register of subsisting mortgages in relation to the land to which it refers.

