

HISTORICAL SEARCH STATEMENT

Land Use Victoria

Produced 03/06/2024 08:03 AM

Volume 8893 Folio 535

Folio Creation: Created as paper folio continued as computer folio

Parent title Volume 06387 Folio 366

THE IMAGE OF THE FOLIO CEASED TO BE THE DIAGRAM LOCATION ON 23/05/2002 05:01:59 AM

RECORD OF HISTORICAL DEALINGS

Date Lodged for Registration	Date Recorded on Register	Dealing	Imaged	Dealing Type and Details
------------------------------	---------------------------	---------	--------	--------------------------

RECORD OF VOTS DEALINGS

Date Lodged for Registration	Date Recorded on Register	Dealing	Imaged
------------------------------	---------------------------	---------	--------

27/11/2017	27/11/2017	AQ489100F (E)	N
------------	------------	---------------	---

LAND TAX CHARGE

STATUTORY CHARGE Section 96(1) Land Tax Act 2005
AQ489100F 27/11/2017

16/03/2018	16/03/2018	AQ827521Y (E)	N
------------	------------	---------------	---

DISCHARGE LAND TAX CHARGE

STATUTORY CHARGE AQ489100F REMOVED

06/06/2018	06/06/2018	AR097535T (O)	Y
------------	------------	---------------	---

TRANSFER OF LAND BY ENDORSEMENT

FROM:

LYNDA ALICE TAYLOR

TO:

KATHERINE LOUISE ELMER

RESULTING PROPRIETORSHIP:

Estate Fee Simple

Sole Proprietor

KATHERINE LOUISE ELMER of 16 FULFORD ROAD WONGA PARK VIC 3115
AR097535T 06/06/2018

06/06/2018	06/06/2018	AR097536R (O)	Y
------------	------------	---------------	---

MORTGAGE OF LAND

MORTGAGE AR097536R 06/06/2018

AUSTRALIA AND NEW ZEALAND BANKING GROUP LTD

28/10/2021	28/10/2021	AU958631Y (E)	N
------------	------------	---------------	---

APPLICATION TO NOMINATE AN ECT TO AN ELECTRONIC INSTRUMENT

ELF Id: 293298730

Removed by Dealing AV016122T

15/11/2021	15/11/2021	AV016122T (E)	N
------------	------------	---------------	---

HISTORICAL SEARCH STATEMENT

Land Use Victoria

TRANSFER OF LAND BY ENDORSEMENT

FROM:

KATHERINE LOUISE ELMER

TO:

RESULTING PROPRIETORSHIP:

Estate Fee Simple

Joint Proprietors

JAMES ANDREW ELMER

KATHERINE LOUISE ELMER both of 16 FULFORD ROAD WONGA PARK VIC 3115

AV016122T 15/11/2021

01/11/2022 01/11/2022 AW222806C (E) N

DISCHARGE OF MORTGAGE

AFFECTED ENCUMBRANCE(S) AND REMOVED MORTGAGE(S)

MORTGAGE AR097536R

01/11/2022 01/11/2022 AW222807A (E) N

MORTGAGE OF LAND

MORTGAGE AW222807A 01/11/2022

NATIONAL AUSTRALIA BANK LTD

STATEMENT END

VOTS Snapshot

VOLUME 08893 FOLIO 535

124069285287J

Produced 27/11/2017 05:40 pm

LAND DESCRIPTION

Lot 1 on Plan of Subdivision 091577.

PARENT TITLE Volume 06387 Folio 366

Created by instrument LP091577 19/08/1971

REGISTERED PROPRIETOR

Estate Fee Simple

Sole Proprietor

LYNDA ALICE TAYLOR of 96 PARTRIDGE WAY MOOROOLBARK 3138

X417361F 12/04/2001

ENCUMBRANCES, CAVEATS AND NOTICES

Any encumbrances created by Section 98 Transfer of Land Act 1958 or Section 24 Subdivision Act 1988 and any other encumbrances shown or entered on the plan or imaged folio set out under DIAGRAM LOCATION below.

DIAGRAM LOCATION

SEE LP091577 FOR FURTHER DETAILS AND BOUNDARIES



Copyright State of Victoria. No part of this publication may be reproduced except as permitted by the Copyright Act 1968 (Cth), to comply with a statutory requirement or pursuant to a written agreement. The information is only valid at the time and in the form obtained from the LANDATA REGD TM System. None of the State of Victoria, its agents or contractors, accepts responsibility for any subsequent publication or reproduction of the information.

The Victorian Government acknowledges the Traditional Owners of Victoria and pays respects to their ongoing connection to their Country, History and Culture. The Victorian Government extends this respect to their Elders, past, present and emerging.

Paper Title Images

8893/535 - Version 3, Date 07/03/2002

ORIGINAL

**NOT TO BE TAKEN FROM THE OFFICE
OF TITLES**



VICTORIA

REGISTER BOOK

VOL. **8893** FOL. **535**

Certificate of Title

UNDER THE "TRANSFER OF LAND ACT"

VOL. **8893** FOL. **535**

STANLEY PAUL MOSER Director and LYLA MURIEL JEAN MOSER Married --
Woman both of 8 Field Street Caulfield are joint proprietors of ---
an estate in fee simple subject to the encumbrances notified hereunder ----
in so much as lies above the depth of Fifty feet below the surface of -----
ALL THAT piece of land coloured purple on the map hereon being Lot 1 on --
Plan of Subdivision No.91577 Parish of Warrandyte County of Evelyn -----

Issued under Regulation 12 on the approval of the above Plan of Subdivision



E. Harris

Assistant Registrar of Titles

ENCUMBRANCES REFERRED TO

MORTGAGE C.676525 -

THE ABOVE MORTGAGE IS

DISCHARGED

15 JAN 1982

J. J. 4484

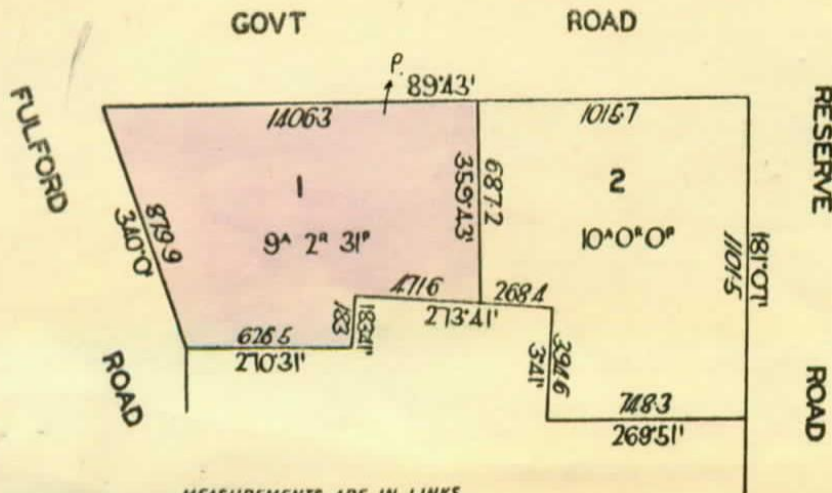

MEASUREMENTS ARE IN LINKS

DERIVED FROM VOL. 6387 FOL. 366 19/8/'71.

U.S.

JOINT PROPRIETORS

DOUGLAS BARRY MOSER & LEE-ANNE MARGARET MOSER

OF "AVONLEIGH" FULFORD RD. WONGA PARK

REGISTERED 24/12/87

N212917X



MORTGAGE

ZÜRICH AUSTRALIAN LIFE INSURANCE LIMITED

REGISTERED 24/12/89

N212918U

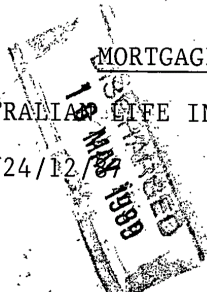

PROPRIETOR

LYNDA ALICE TAYLOR

96 PARTRIDGE WAY MOOROOLBARK 3138

X417361F

12/04/01



PROPRIETOR

F.W. WESTMORE INVESTMENTS PTY. LTD. OF

DAVIS RD. WONGA PARK

REGISTERED 16/5/89

P193443W

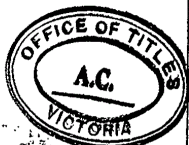

MORTGAGE

AUSTRALIA AND NEW ZEALAND BANKING GROUP

LIMITED

REGISTERED 16/5/89

P193444T

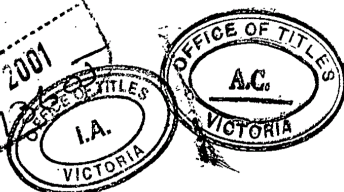

CAVEAT

CAVEATOR: LYNDA ALICE TAYLOR

CAPACITY: PURCHASER/FEE SIMPLE
LODGED BY: McCRAKEN & McCRAKEN

NOTICE TO: 208 WHITEHORSE RD. BLACKBURN
3130

X345596P 02/03/01



CAVEAT WILL LAPSE ON

REGISTRATION OF 417361F

23/4/01

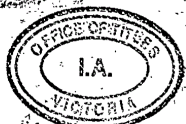

T08893-535-1-3

T8893 F. 535