

**HISTORICAL SEARCH STATEMENT**

**Land Use Victoria**

Produced 07/06/2024 05:54 PM

Volume 8893 Folio 536

Folio Creation: Created as paper folio continued as computer folio

Parent title Volume 06387 Folio 366

THE IMAGE OF THE FOLIO CEASED TO BE THE DIAGRAM LOCATION ON 23/05/2002 05:01:59 AM

**RECORD OF HISTORICAL DEALINGS**

Date Lodged for Registration	Date Recorded on Register	Dealing	Imaged	Dealing Type and Details
------------------------------	---------------------------	---------	--------	--------------------------

**RECORD OF VOTS DEALINGS**

Date Lodged for Registration	Date Recorded on Register	Dealing	Imaged
10/09/2004	13/09/2004	AD108121Q	Y

TRANSFER OF LAND BY ENDORSEMENT

FROM:

STANLEY PAUL MOSER

TO:

ELIZABETH MARY CESA

RESULTING PROPRIETORSHIP:

Estate Fee Simple

Sole Proprietor

ELIZABETH MARY CESA of 50-52 TOPPINGS ROAD WONGA PARK VIC 3115

AD108121Q 10/09/2004

10/09/2004	13/09/2004	AD108122N	Y
------------	------------	-----------	---

MORTGAGE OF LAND

MORTGAGE AD108122N 10/09/2004

AUSTRALIA AND NEW ZEALAND BANKING GROUP LIMITED

06/04/2005	06/04/2005	AD539621N	Y
------------	------------	-----------	---

MORTGAGE OF LAND

MORTGAGE AD539621N 06/04/2005

AUSTRALIA AND NEW ZEALAND BANKING GROUP LIMITED

09/11/2009	09/11/2009	AG856079K	Y
------------	------------	-----------	---

DISCHARGE OF MORTGAGE

AFFECTED ENCUMBRANCE(S) AND REMOVED MORTGAGE(S)

MORTGAGE AD108122N

MORTGAGE AD539621N

09/11/2009	09/11/2009	AG856080B	Y
------------	------------	-----------	---

MORTGAGE OF LAND

MORTGAGE AG856080B 09/11/2009

BANK OF QUEENSLAND LTD

**HISTORICAL SEARCH STATEMENT**

**Land Use Victoria**

29/06/2015            29/06/2015            AL992947E            Y

DISCHARGE OF MORTGAGE  
AFFECTED ENCUMBRANCE(S) AND REMOVED MORTGAGE(S)  
MORTGAGE AG856080B

11/09/2015            11/09/2015            AM172312R            Y

TRANSFER OF LAND BY ENDORSEMENT

FROM:  
ELIZABETH MARY CESA  
TO:  
KEVIN JOHN WALLACE

RESULTING PROPRIETORSHIP:  
Estate Fee Simple  
Sole Proprietor  
KEVIN JOHN WALLACE of 47 RESERVE ROAD WONGA PARK VIC 3115  
AM172312R 11/09/2015

STATEMENT END

**VOTS Snapshot**

Volume 08893 Folio 536  
124011704008F  
Produced 13/09/2004 08:51 am

**LAND DESCRIPTION**

Lot 2 on Plan of Subdivision 091577.  
PARENT TITLE Volume 06387 Folio 366  
Created by instrument LP091577 19/08/1971

**REGISTERED PROPRIETOR**

Estate Fee Simple  
Sole Proprietor  
STANLEY PAUL MOSER of 47 RESERVE RD WONGA PARK 3115  
U519025J 22/11/1996

**ENCUMBRANCES, CAVEATS AND NOTICES**

Any encumbrances created by Section 98 Transfer of Land Act 1958 or Section 24 Subdivision Act 1988 and any other encumbrances shown or entered on the plan or imaged folio set out under DIAGRAM LOCATION below.

**DIAGRAM LOCATION**

SEE LP091577 FOR FURTHER DETAILS AND BOUNDARIES

---

**Paper Title Images**



Copyright State of Victoria. No part of this publication may be reproduced except as permitted by the Copyright Act 1968 (Cth), to comply with a statutory requirement or pursuant to a written agreement. The information is only valid at the time and in the form obtained from the LANDATA REGD TM System. None of the State of Victoria, its agents or contractors, accepts responsibility for any subsequent publication or reproduction of the information.

The Victorian Government acknowledges the Traditional Owners of Victoria and pays respects to their ongoing connection to their Country, History and Culture. The Victorian Government extends this respect to their Elders, past, present and emerging.

## **HISTORICAL SEARCH STATEMENT**

## **Land Use Victoria**

Page 3 of 5

---

8893/536 - Version 0, Date 27/02/2000

**ORIGINAL**

**NOT TO BE TAKEN FROM THE OFFICE  
OF TITLES**



VICTORIA

REGISTER BOOK

VOL. **8893** FOL. **536**

# Certificate of Title

UNDER THE "TRANSFER OF LAND ACT"

VOL. **8893** FOL. **536**

STANLEY PAUL MOSER Director and LYLA MURIEL JEAN MOSER Married --  
Woman both of 8 Field Street Caulfield are joint proprietors of ----  
an estate in fee simple subject to the encumbrances notified hereunder ----  
in so much as lies above the depth of Fifty feet below the surface of -----  
ALL THAT piece of land coloured purple on the map hereon being Lot 2 on --  
Plan of Subdivision No.91577 Parish of Warrandyte County of Evelyn -----

Issued under Regulation 12 on the approval of the above Plan of Subdivision



*E. Harris*

Assistant Registrar of Titles

ENCUMBRANCES REFERRED TO

MORTGAGE C.676525 -

*THIS ABOVE MORTGAGE IS  
DISCHARGED  
15 JAN 1982*

*J784484*

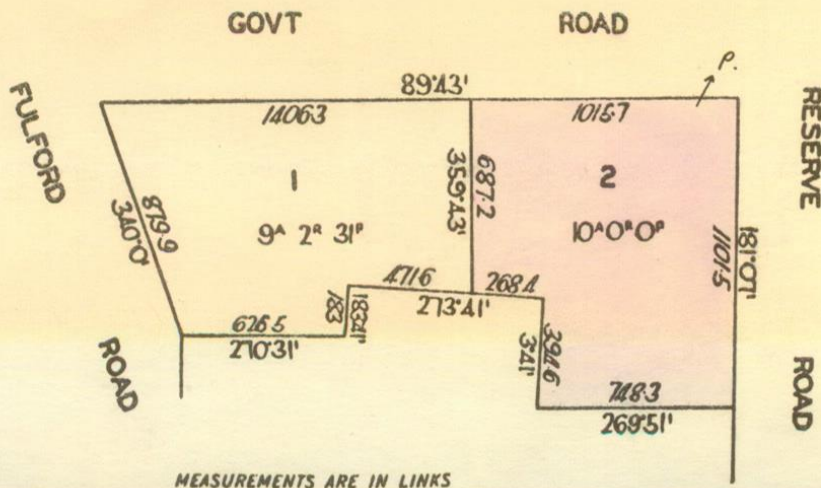

DERIVED  
FROM  
VOL. 6387  
FOL. 366  
19/8/'71.

*u.s.*

SURVIVING PROPRIETOR  
STANLEY PAUL MOSER  
47 RESERVE RD. WONGA PARK 3115

U519025J 22/11/96

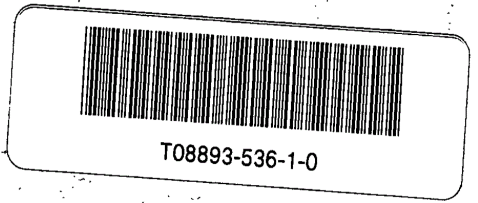

V.8893 F.536