

HISTORICAL SEARCH STATEMENT

Land Use Victoria

Produced 29/06/2024 11:06 PM

Volume 9036 Folio 690

Folio Creation: Created as paper folio continued as computer folio

Parent title Volume 08728 Folio 273

RECORD OF HISTORICAL DEALINGS

Date Lodged for Registration	Date Recorded on Register	Dealing	Imaged	Dealing Type and Details
19/11/2001	12/12/2001	X889189F	Y	TRANSFER CHERRY, ANNETTE MARGARET
19/11/2001	12/12/2001	X889190F	Y	MORTGAGE NATIONAL AUSTRALIA BANK LIMITED

RECORD OF VOTS DEALINGS

Date Lodged for Registration	Date Recorded on Register	Dealing	Imaged	
18/01/2005	18/01/2005	AD374811Y	Y	
DISCHARGE OF MORTGAGE MORTGAGE(S) REMOVED X889190F				
18/01/2005	18/01/2005	AD374812W	Y	
TRANSFER OF LAND BY ENDORSEMENT FROM: ANNETTE MARGARET CHERRY TO: ANTHONY GORDON ELIOTT RESULTING PROPRIETORSHIP: Estate Fee Simple Sole Proprietor ANTHONY GORDON ELIOTT of 131-133 JUMPING CREEK ROAD WONGA PARK VIC 3115 AD374812W 18/01/2005				
18/01/2005	18/01/2005	AD374813U	Y	
MORTGAGE OF LAND MORTGAGE AD374813U 18/01/2005 WESTPAC BANKING CORPORATION				
22/07/2009	22/07/2009	AG646737T	Y	
DISCHARGE OF MORTGAGE AFFECTED ENCUMBRANCE(S) AND REMOVED MORTGAGE(S) MORTGAGE AD374813U				

HISTORICAL SEARCH STATEMENT

Land Use Victoria

22/07/2009 22/07/2009 AG646738R Y

TRANSFER OF LAND BY ENDORSEMENT

FROM:

ANTHONY GORDON ELIOTT

TO:

EVA ANKE ELIOTT

RESULTING PROPRIETORSHIP:

Estate Fee Simple

Sole Proprietor

EVA ANKE ELIOTT of 131-133 JUMPING CREEK ROAD WONGA PARK VIC 3115
AG646738R 22/07/2009

02/06/2010 02/06/2010 AH268354J Y

MORTGAGE OF LAND

MORTGAGE AH268354J 02/06/2010

NATIONAL AUSTRALIA BANK LTD

25/10/2011 25/10/2011 AJ275647K Y

DISCHARGE OF MORTGAGE

AFFECTED ENCUMBRANCE(S) AND REMOVED MORTGAGE(S)

MORTGAGE AH268354J

25/10/2011 25/10/2011 AJ275648H Y

MORTGAGE OF LAND

MORTGAGE AJ275648H 25/10/2011

SUNCORP-METWAY LTD

13/02/2014 13/02/2014 AK898590E (O) Y

DISCHARGE OF MORTGAGE

AFFECTED ENCUMBRANCE(S) AND REMOVED MORTGAGE(S)

MORTGAGE AJ275648H

13/02/2014 13/02/2014 AK898591C (O) Y

TRANSFER OF LAND BY ENDORSEMENT

FROM:

EVA ANKE ELIOTT

TO:

CHARLES MALCOLM STEWART

CAROL ANNE STEWART

RESULTING PROPRIETORSHIP:

Estate Fee Simple

Joint Proprietors

CHARLES MALCOLM STEWART

CAROL ANNE STEWART both of 131-133 JUMPING CREEK ROAD WONGA PARK
VIC 3115

AK898591C 13/02/2014

13/02/2014 13/02/2014 AK898592A (O) Y

MORTGAGE OF LAND

MORTGAGE AK898592A 13/02/2014

COMMONWEALTH BANK OF AUSTRALIA

STATEMENT END

VOTS Snapshot

Volume 09036 Folio 690

124012925878L

Produced 18/01/2005 03:26 pm

LAND DESCRIPTION

Lot 2 on Plan of Subdivision 112004.
PARENT TITLE Volume 08728 Folio 273
Created by instrument LP112004 02/07/1974

REGISTERED PROPRIETOR

Estate Fee Simple
Sole Proprietor

ANNETTE MARGARET CHERRY of 9 ST JAMES AV. MONT ALBERT 3127
X889189F 19/11/2001

ENCUMBRANCES, CAVEATS AND NOTICES

MORTGAGE X889190F 19/11/2001
NATIONAL AUSTRALIA BANK LIMITED

Any encumbrances created by Section 98 Transfer of Land Act 1958 or Section 24 Subdivision Act 1988 and any other encumbrances shown or entered on the plan or imaged folio set out under DIAGRAM LOCATION below.

DIAGRAM LOCATION

SEE LP112004 FOR FURTHER DETAILS AND BOUNDARIES

HISTORICAL REPRINT(S)

Volume 09036 Folio 690

123460612357U Page 1

Produced 12/12/2001 11:32 am

LOT 2 on Plan of Subdivision 112004.
PARENT TITLE Volume 08728 Folio 273
Created by instrument LP112004 02/07/1974

REGISTERED PROPRIETOR

ESTATE FEE SIMPLE

SOLE PROPRIETOR

CHERRY, ANNETTE MARGARET; 9 ST JAMES AV. MONT ALBERT 3127
X889189F 19/11/2001

ENCUMBRANCES, CAVEATS AND NOTICES

MORTGAGES AND CHARGES IN PRIORITY RANKING

1 X889190F 19/11/2001 MORTGAGE
NATIONAL AUSTRALIA BANK LIMITED

Any encumbrances created by Section 98 Transfer of Land Act 1958 or Section 24 Subdivision Act 1988 and any other encumbrances shown or entered on the plan or imaged folio set out under DIAGRAM LOCATION below.

DIAGRAM LOCATION

SEE LP112004 FOR FURTHER DETAILS AND BOUNDARIES

END OF CERTIFICATE

Paper Title Images

9036/690 - Version 0, Date 10/08/1999

ORIGINAL

**NOT TO BE TAKEN FROM THE OFFICE
OF TITLES**



VICTORIA

REGISTER BOOK

VOL. 9036 FOL. 690

Certificate of Title

UNDER THE "TRANSFER OF LAND ACT"

LEONIE ST. CLAIR AYTOUN of "Somerset" Jumping Creek Road Wonga Park-Gentlewoman is the proprietor of an estate in fee simple subject to - the encumbrances notified hereunder in ALL THAT piece of land coloured on the map hereon being Lot 2 on Plan of Subdivision No.112004 - - - Parish of Warrandyte County of Evelyn - - - - -

Issued under Regulation 12 on the approval of the above - - Plan of Subdivision -

J.W. Staggart



Assistant Registrar of Titles
ENCUMBRANCES REFERRED TO
MORTGAGE E711346 -

VOL 9036 FOL 690

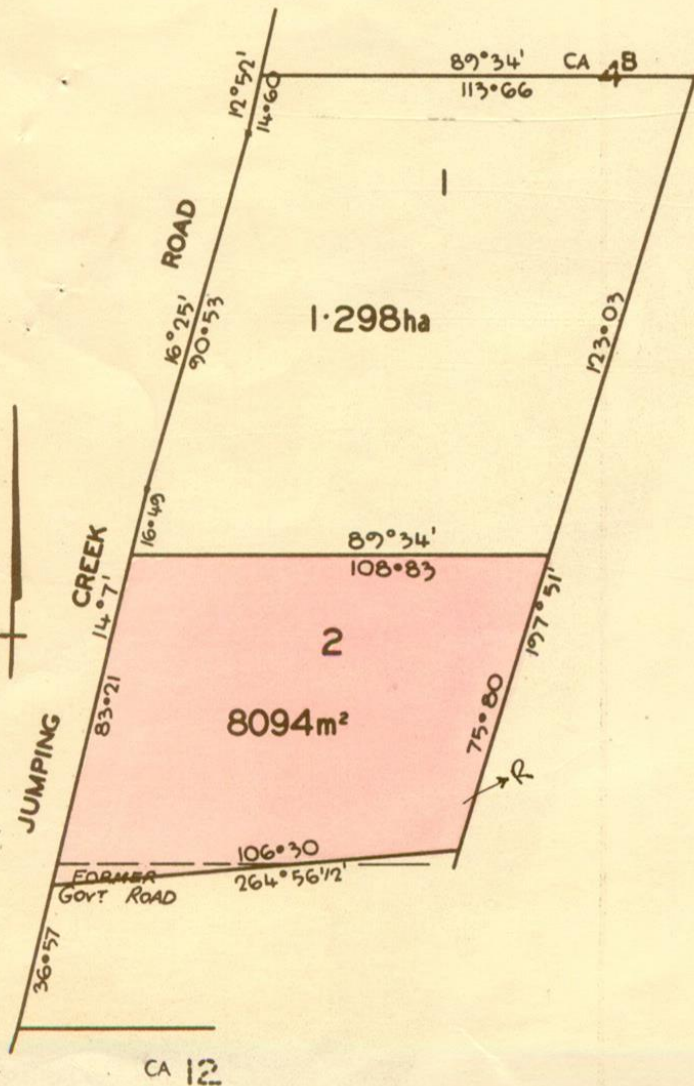

THE ABOVE MORTGAGE IS
DISCHARGED
24 JUL 1974



LENGTHS ARE IN METRES
AREAS (IF SHOWN) ARE IN HECTARES (ha)
OR IN SQUARE METRES (m²)

DERIVED FROM
VOL.8728 FOL.273
2/7/74

u.s.

PLAN No. F363904

1ST JUL. '74

LANDISD

NOTICE OF MORTGAGE OF TEN
PART 20

CAVEAT LAPSED 3 APR 1975



MARTIN HOBKIRK RIDDELL Finance Controller
and JILLIAN NANCY RIDDELL Married Woman
both of 38 Granard Avenue Park Orchards
are now JOINT PROPRIETORS
Registered 17th March 1975
No. F634653



MORTGAGE TO THE COMMISSIONERS OF THE BANK OF VICTORIA

Registered 30 JUL 1975 ~~DISCHARGED 19 JUL 1995~~

No. F 792552



PROPRIETOR
MARTIN HOBKIRK RIDDELL OF 131 JUMPING CREEK RD.
WONGA PARK
REGISTERED 16/10/91
R594331C



PROPRIETORS
TENANTS IN COMMON IN EQUAL SHARES
MARTIN HOBKIRK RIDDELL & MERILYN FAYE
RIDDELL OF 131 JUMPING CREEK RD. WONGA PARK
REGISTERED 16/10/91
R594332Y



MORTGAGE TO COMMONWEALTH BANK OF AUSTRALIA

Registered 29 OCT 1987 ~~DISCHARGED 19 JUL 1993~~

No. R612861



V.9036 F.690