



Imaged Document Cover Sheet

The document following this cover sheet is an imaged document supplied by LANDATA®, Secure Electronic Registries Victoria.

Document Type	Cancelled Title
Document Identification	9251/112
Number of Pages (excluding this cover sheet)	2
Document Assembled	15/05/2024 07:29

Copyright and disclaimer notice:

© State of Victoria. This publication is copyright and includes confidential information. No part may be reproduced by any process except in accordance with the provisions of the Copyright Act or pursuant to a written agreement. The State of Victoria does not warrant the accuracy or completeness of the information in this publication and any person using or relying upon such information does so on the basis that the State of Victoria shall bear no responsibility or liability whatsoever for any errors, faults, defects or omissions in the information.

The document is invalid if this cover sheet is removed or altered.

ORIGINAL

NOT TO BE TAKEN FROM THE OFFICE OF TITLES



VICTORIA

CANCELLED

REGISTER BOOK

VOL. 9251 FOL. 112

Certificate of Title

UNDER THE "TRANSFER OF LAND ACT"

GRAHAM ALEXANDER CAMPBELL and MARGARET JOYCE CAMPBELL both of "Gramer -
 Lodge" Jumping Creek Road Wonga Park Thoroughbred Breeders are the - - -
 joint proprietors of an estate in fee simple subject to the encumbrances - -
 notified hereunder in ALL THAT piece of land coloured red on the map hereon
 being the land in Plan of Consolidation No.106603 and being part of Crown -
 Section 12 Parish of Warrandyte County of Evelyn - - - - -

FOL.

VOL.

Delivered on-line by LANDATA®

WARNING
This document provides an image of a cancelled folio of the Register. It is not a statement from the register of subsisting information in relation to the land to which it refers.

Issued pursuant to Section 97A (2) of the Transfer of Land Act 1958 -

PLAN C107905 AFFECTS LAND HEREIN

R. Ingate
Assistant Registrar of Titles



ENCUMBRANCES REFERRED TO

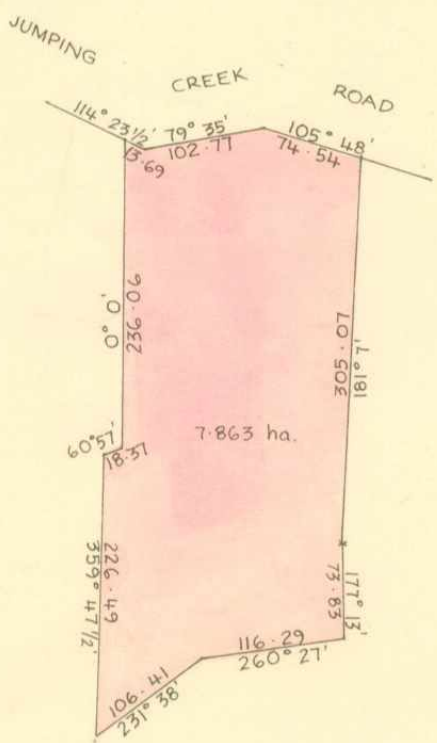

AREA IS IN HECTARES (ha)

Derived from Vols. 8970 Fols. 945
9231 486

13th February 1978

MEASUREMENTS ARE IN METRES

SM

VOL 9251 FOL 112

INSTRUMENT

APPLICATION

-PL

MORTGAGE

to EDWARD VERGERS

Registered 3rd February 1978

No. G953145

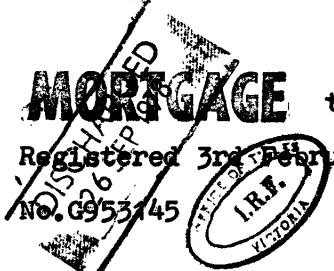

MORTGAGE

to EDWARD VERGERS

Registered 1st December 1978

No. H327307



CANCELLED

PURSUANT TO PLAN OF CONSOLIDATION

No. C. P. 107905

See Vol. 9314 Fols. 650

14 MAR 1979



CANCELLED

Delivered on-line by LANDATA®
WARNING
The document provides an image of a cancelled folio of the Register. It is not a statement from the register of subsisting information in relation to the land to which it refers.



T09251-112-1-7