



# Imaged Document Cover Sheet

The document following this cover sheet is an imaged document supplied by LANDATA®, Secure Electronic Registries Victoria.

Document Type	<b>Plan</b>
Document Identification	<b>LP207147G</b>
Number of Pages (excluding this cover sheet)	<b>1</b>
Document Assembled	<b>07/08/2024 23:00</b>

**Copyright and disclaimer notice:**

© State of Victoria. This publication is copyright. No part may be reproduced by any process except in accordance with the provisions of the Copyright Act 1968 (Cth) and for the purposes of Section 32 of the Sale of Land Act 1962 or pursuant to a written agreement. The information is only valid at the time and in the form obtained from the LANDATA® System. None of the State of Victoria, LANDATA®, Secure Electronic Registries Victoria Pty Ltd (ABN 86 627 986 396) as trustee for the Secure Electronic Registries Victoria Trust (ABN 83 206 746 897) accept responsibility for any subsequent release, publication or reproduction of the information.

The document is invalid if this cover sheet is removed or altered.

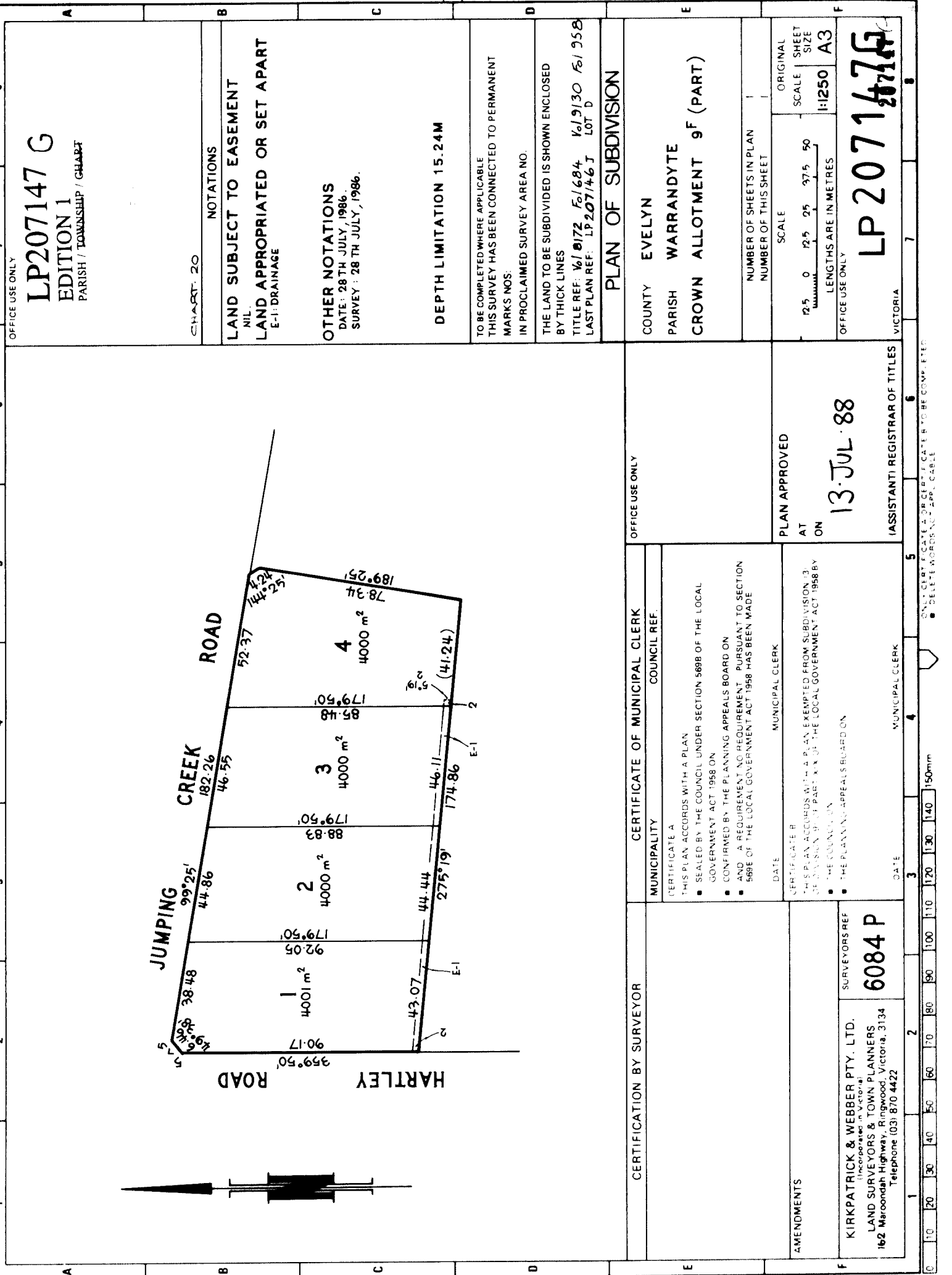

**LP207147 G**  
**EDITION 1**  
 PARISH / TOWNSHIP / CHART

CHART: 20

NOTATIONS  
 LAND SUBJECT TO EASEMENT  
 NIL  
 LAND APPROPRIATED OR SET APART  
 E-1: DRAINAGE

OTHER NOTATIONS  
 DATE: 28 TH JULY, 1986.  
 SURVEY: 28 TH JULY, 1986.

DEPTH LIMITATION 15.24M

TO BE COMPLETED WHERE APPLICABLE  
 THIS SURVEY HAS BEEN CONNECTED TO PERMANENT  
 MARKS NOS:  
 IN PROCLAIMED SURVEY AREA NO.

THE LAND TO BE SUBDIVIDED IS SHOWN ENCLOSED  
 BY THICK LINES

TITLE REF:  $\frac{1}{2}$  / 972  $\frac{1}{2}$  / 684  $\frac{1}{2}$  / 930  $\frac{1}{2}$  / 958  
 LAST PLAN REF: LP 207146 J LOT D

**PLAN OF SUBDIVISION**

COUNTY **EVELYN**  
 PARISH **WARRANTYTE**  
 CROWN ALLOTMENT **9 F (PART)**

NUMBER OF SHEETS IN PLAN  
 NUMBER OF THIS SHEET

SCALE

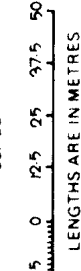

ORIGINAL  
 SCALE  
 SHEET  
 SIZE  
**1:1250 A3**

**LP 207147 G**

OFFICE USE ONLY  
 VICTORIA

OFFICE USE ONLY

CERTIFICATE OF MUNICIPAL CLERK  
 MUNICIPAL CLERK  
 COUNCIL REF.

CERTIFICATE A  
 THIS PLAN ACCORDS WITH A PLAN  
 SEALED BY THE COUNCIL UNDER SECTION 569B OF THE LOCAL  
 GOVERNMENT ACT 1958 ON  
 CONFIRMED BY THE PLANNING APPEALS BOARD ON  
 AND A REQUIREMENT NO REQUIREMENT PURSUANT TO SECTION  
 569E OF THE LOCAL GOVERNMENT ACT 1958 HAS BEEN MADE

CERTIFICATE B  
 THIS PLAN ACCORDS WITH A PLAN EXEMPTED FROM SUBDIVISION 13  
 OF DIVISION 9 OF PART 1X OF THE LOCAL GOVERNMENT ACT 1958 BY  
 THE COUNCIL ON  
 THE PLANNING APPEALS BOARD ON

DATE

MUNICIPAL CLERK

PLAN APPROVED  
 AT  
 ON

13 JUL 88

(ASSISTANT) REGISTRAR OF TITLES

CERTIFICATION BY SURVEYOR

AMENDMENTS

SURVEYORS REF  
**6084 P**  
 KIRKPATRICK & WEBBER PTY. LTD.  
(Incorporated in Victoria)  
 LAND SURVEYORS & TOWN PLANNERS  
 162 Maroondah Highway, Ringwood, Victoria, 3134  
 Telephone (03) 870 4422

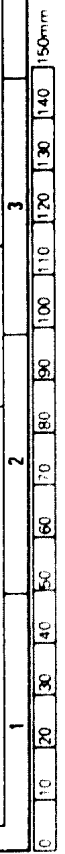

ONLY CERTIFICATE A OR CERTIFICATE B TO BE COMPLETED  
 • DELETE WORDS NOT APPLICABLE