



Imaged Document Cover Sheet

The document following this cover sheet is an imaged document supplied by LANDATA®, Secure Electronic Registries Victoria.

Document Type	Plan
Document Identification	LP207148E
Number of Pages (excluding this cover sheet)	1
Document Assembled	09/08/2024 23:34

Copyright and disclaimer notice:

© State of Victoria. This publication is copyright. No part may be reproduced by any process except in accordance with the provisions of the Copyright Act 1968 (Cth) and for the purposes of Section 32 of the Sale of Land Act 1962 or pursuant to a written agreement. The information is only valid at the time and in the form obtained from the LANDATA® System. None of the State of Victoria, LANDATA®, Secure Electronic Registries Victoria Pty Ltd (ABN 86 627 986 396) as trustee for the Secure Electronic Registries Victoria Trust (ABN 83 206 746 897) accept responsibility for any subsequent release, publication or reproduction of the information.

The document is invalid if this cover sheet is removed or altered.

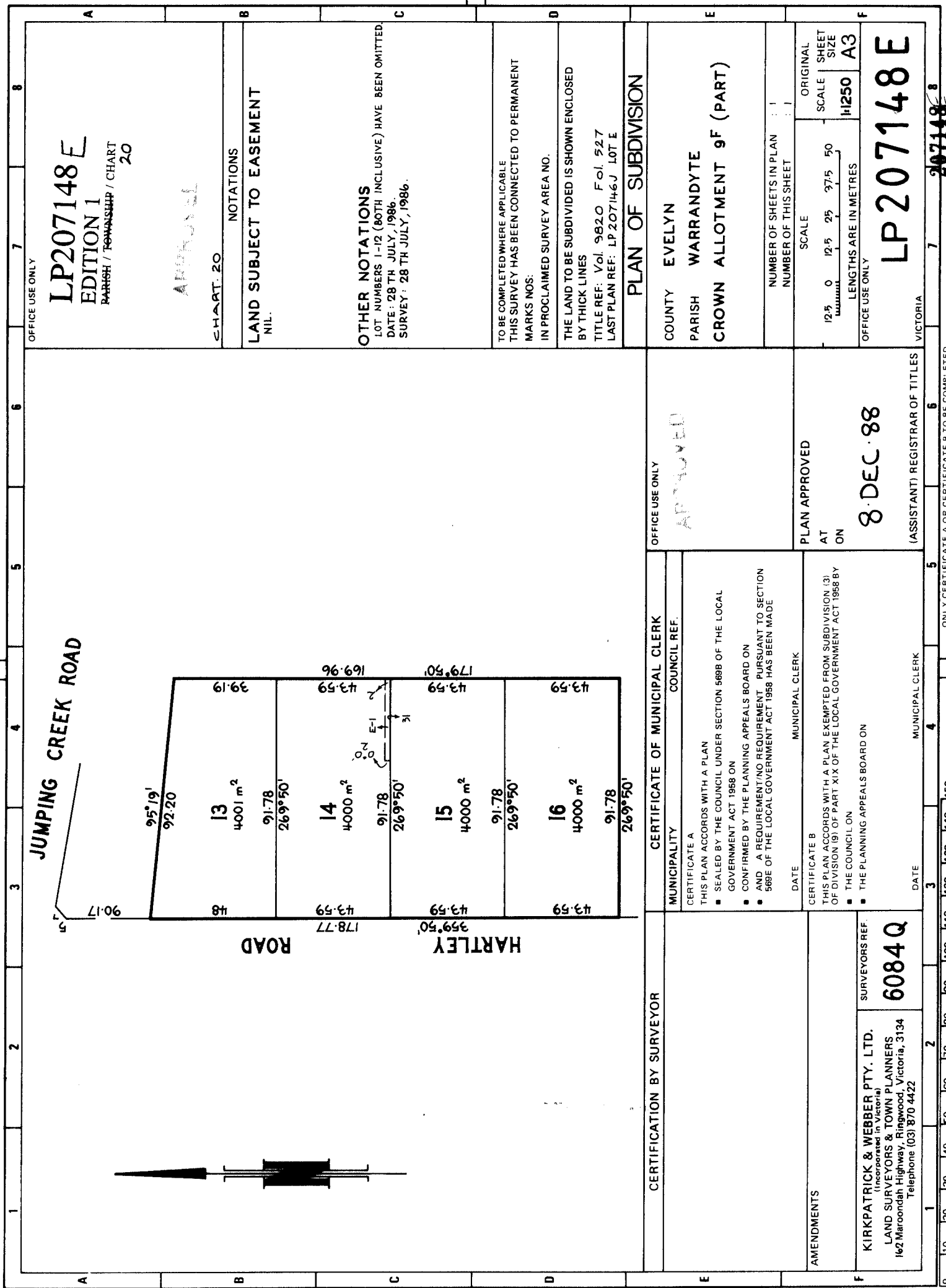

OFFICE USE ONLY
LP207148 E
 EDITION 1
 PARISH / TOWNSHIP / CHART 20
 APPROVAL

CHART 20
 NOTATIONS
LAND SUBJECT TO EASEMENT
 NIL.

OTHER NOTATIONS
 LOT NUMBERS 1-12 (BOTH INCLUSIVE) HAVE BEEN OMITTED.
 DATE: 28 TH JULY, 1986.
 SURVEY: 28 TH JULY, 1986.

TO BE COMPLETED WHERE APPLICABLE
 THIS SURVEY HAS BEEN CONNECTED TO PERMANENT
 MARKS NOS:
 IN PROCLAIMED SURVEY AREA NO.

THE LAND TO BE SUBDIVIDED IS SHOWN ENCLOSED
 BY THICK LINES
 TITLE REF: Vol. 9820 Fol. 527
 LAST PLAN REF: LP207146J LOT E

PLAN OF SUBDIVISION
 COUNTY **EVELYN**
 PARISH **WARRANTYTE**
CROWN ALLOTMENT 9F (PART)

NUMBER OF SHEETS IN PLAN : 1
 NUMBER OF THIS SHEET : 1
 SCALE
 12.5 0 12.5 25 37.5 50
 LENGTHS ARE IN METRES
 ORIGINAL SHEET SIZE
 1:1250 A3
 OFFICE USE ONLY
LP207148 E
 VICTORIA

OFFICE USE ONLY
APPROVED
8 DEC 88
 (ASSISTANT) REGISTRAR OF TITLES

CERTIFICATE OF MUNICIPAL CLERK
 MUNICIPAL CLERK
 COUNCIL REF.
 CERTIFICATE A
 THIS PLAN ACCORDS WITH A PLAN
 SEALED BY THE COUNCIL UNDER SECTION 568B OF THE LOCAL
 GOVERNMENT ACT 1958 ON
 CONFIRMED BY THE PLANNING APPEALS BOARD ON
 AND A REQUIREMENT/NO REQUIREMENT PURSUANT TO SECTION
 569E OF THE LOCAL GOVERNMENT ACT 1958 HAS BEEN MADE
 DATE
 MUNICIPAL CLERK

CERTIFICATION BY SURVEYOR
 SURVEYORS REF.
6084 Q
KIRKPATRICK & WEBBER PTY. LTD.
 (Incorporated in Victoria)
 LAND SURVEYORS & TOWN PLANNERS
 162 Maroondah Highway, Ringwood, Victoria, 3134
 Telephone (03) 870 4422

ONLY CERTIFICATE A OR CERTIFICATE B TO BE COMPLETED
 DELETE WORDS NOT APPLICABLE