



Imaged Document Cover Sheet

The document following this cover sheet is an imaged document supplied by LANDATA®, Secure Electronic Registries Victoria.

Document Type	Cancelled Title
Document Identification	8188/608
Number of Pages (excluding this cover sheet)	4
Document Assembled	28/07/2024 10:07

Copyright and disclaimer notice:

© State of Victoria. This publication is copyright and includes confidential information. No part may be reproduced by any process except in accordance with the provisions of the Copyright Act or pursuant to a written agreement. The State of Victoria does not warrant the accuracy or completeness of the information in this publication and any person using or relying upon such information does so on the basis that the State of Victoria shall bear no responsibility or liability whatsoever for any errors, faults, defects or omissions in the information.

The document is invalid if this cover sheet is removed or altered.

CANCELLED

ORIGINAL

NOT TO BE TAKEN FROM THE OFFICE OF TITLES

Entered in the Register Book

Vol. 8188 Fol. 608



VICTORIA

Certificate of Title

UNDER THE "TRANSFER OF LAND ACT 1954"

17/10/58
Bd

Delivered on-line by LANDATA®

AMENDED 19486 11.59

WARNING This document provides an image of a cancelled folio of the Register. It is not a statement from the register of subsisting information in relation to the land to which it refers.

-Evington- Horace Albert/Smith of Homestead Road Wonga Park Orchardist is

now the proprietor

of an Estate in Fee-simple subject to the Encumbrances notified hereunder in so much as lies above the depth of Fifty feet below the surface of

All that piece of Land, delineated and coloured purple on the map in the

margin containing Twenty-eight acres Three roods and Thirty-six perches or

thereabouts being part of Crown Allotment 9^J Parish of Warrandyte

County of Evelyn

338 2233

Dated the Twenty-fifth day of February One thousand nine hundred and fifty-eight.

W. J. G. [Signature]
Assistant Registrar of Titles



ENCUMBRANCES REFERRED TO

except 2 lot N.S. [unclear] by [unclear] [unclear] lot 1 [unclear] in extreme [unclear] corner.

27.3.68

bound lot 1 to abutting corner by [unclear]

5/10/68

THE WHOLE OR PART OF THE WITHIN LAND HAS BEEN SUBDIVIDED SEE Unregistered Plan 222/0 Misc. Plan L.P. 82300

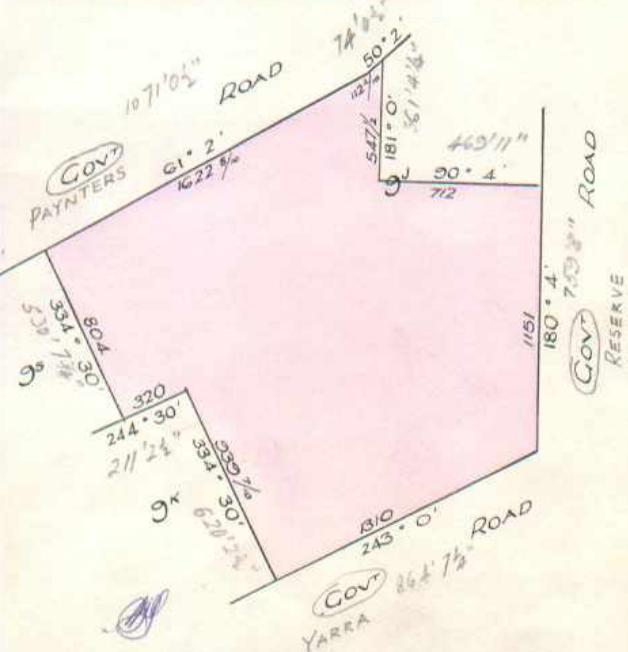

THE MEASUREMENTS ARE IN Links.

Vol. 3191 Fol. 044

Transfer A/485331

Application

MORTGAGE to COMMONWEALTH SAVINGS BANK
 OF AUSTRALIA
 Registered 18th September 1959
 Numbered A819487

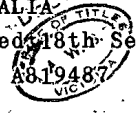

CAVEAT No. 634875 **LODGED** 29th OCT. 1965
 Affecting part of the land herein *Plan*

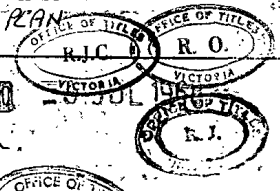

CAVEAT LAPSED 16 JAN 1970
CAVEAT No. D121672 **LODGED**
 Affecting part of the land herein *Plan*

CAVEAT LAPSED 18 FEB 1970



CAVEAT No. D375428 **LODGED** 29 APR 1969
 Affecting part of the land herein *Plan*



CAVEAT LAPSED 23 JUL 1969

TRANSFER AS TO PART No. D415234
 registered 10th June 1969

CANCELLED AS TO PART
 See Vol 8785 Fol. 224
Lot one



TRANSFER AS TO BALANCE No. D561186
 registered 14th November 1969

CANCELLED See Vol. 8812 FOL. 396



CANCELLED

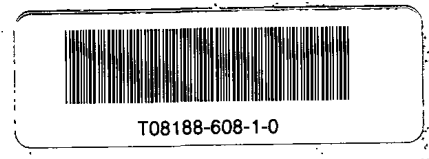

Delivered on-line by LANDATA®
 This document provides an image of a cancelled folio of the Register. It is not a document from the register of subsisting information in relation to the thing to which it refers.
 WARNING

SCALE 300 feet to one inch
Volume 8188 Folio 608

Delivered
on-line by
LANDATA®

WARNING
This document provides an image of a cancelled folio of the Register. It is not a statement
from the register of subsisting information in relation to the land to which it refers.

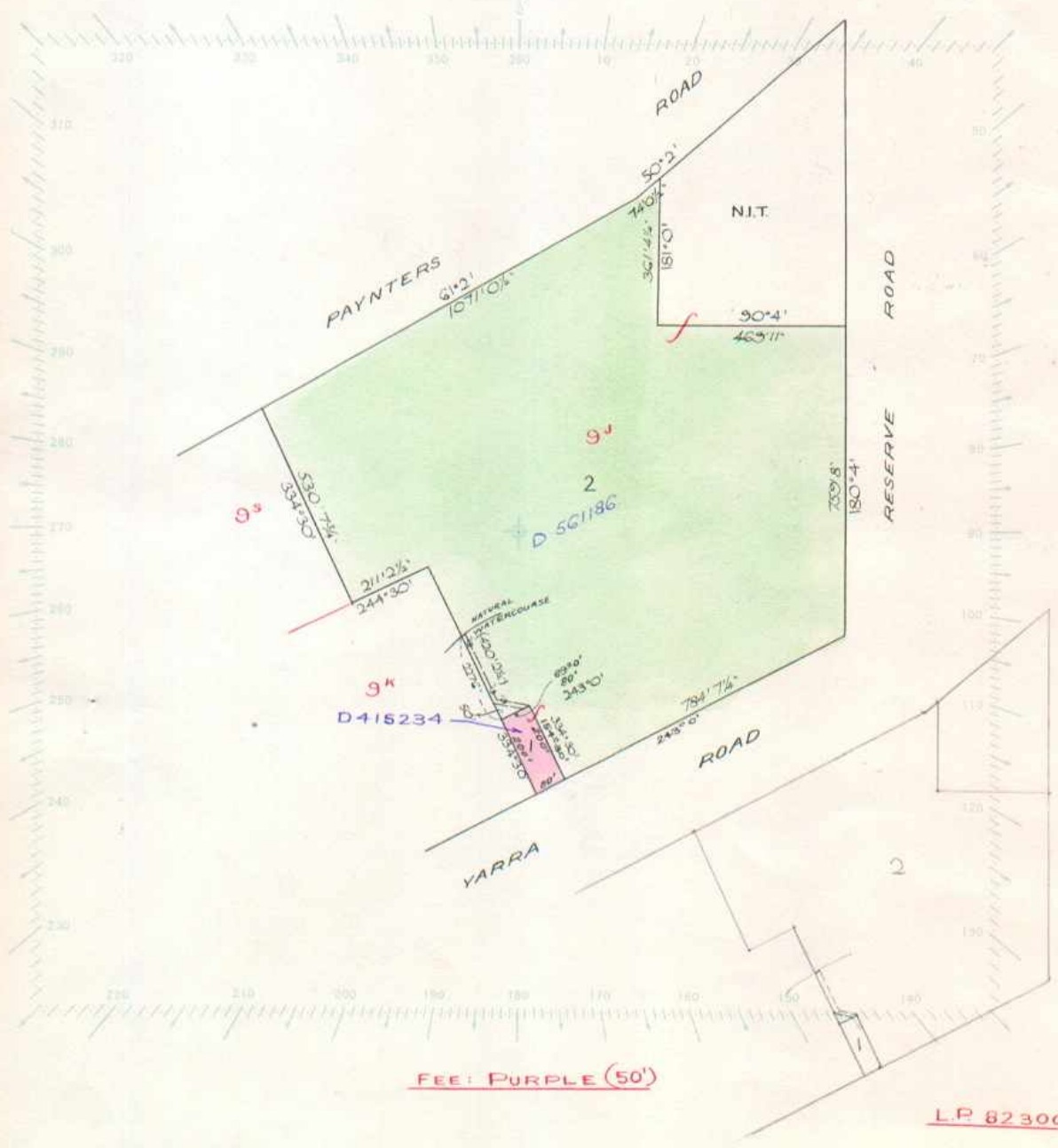

FEE: PURPLE (50')

LP 82300

Delivered
on-line by
LANDATA®

WARNING
This document provides an image of a cancelled folio of the Register. It is not a statement.
from the register of subsisting information in relation to the land to which it refers.

 **Natural Resources and Environment**
AGRICULTURE · REQUIRIMENT · CONSERVATION · LAND MANAGEMENT

**INTENTIONALLY
BLANK**

