



# Imaged Document Cover Sheet

The document following this cover sheet is an imaged document supplied by LANDATA®, Secure Electronic Registries Victoria.

Document Type	<b>Plan</b>
Document Identification	<b>PS336802N</b>
Number of Pages (excluding this cover sheet)	<b>1</b>
Document Assembled	<b>28/07/2024 19:27</b>

**Copyright and disclaimer notice:**

© State of Victoria. This publication is copyright. No part may be reproduced by any process except in accordance with the provisions of the Copyright Act 1968 (Cth) and for the purposes of Section 32 of the Sale of Land Act 1962 or pursuant to a written agreement. The information is only valid at the time and in the form obtained from the LANDATA® System. None of the State of Victoria, LANDATA®, Secure Electronic Registries Victoria Pty Ltd (ABN 86 627 986 396) as trustee for the Secure Electronic Registries Victoria Trust (ABN 83 206 746 897) accept responsibility for any subsequent release, publication or reproduction of the information.

The document is invalid if this cover sheet is removed or altered.

<b>PLAN OF SUBDIVISION</b>	STAGE No. --	LTO USE ONLY <b>EDITION 1</b>	PLAN NUMBER <b>PS 336802N</b>
----------------------------	-----------------	----------------------------------	----------------------------------

**LOCATION OF LAND**  
 PARISH: WARRANDYTE  
 TOWNSHIP: -----  
 SECTION: -----  
 CROWN ALLOTMENT: 9J (PART)  
 CROWN PORTION: -----  
 LTO BASE RECORD: CHART 20 (3753)  
 TITLE REFERENCES: VOL 9120 FOL 474  
 LAST PLAN REFERENCE: LOT 6 L.P.116246  
 POSTAL ADDRESS: JUMPING CREEK ROAD  
 (AT TIME OF SUBDIVISION) WONGA PARK 3115  
 AMG CO-ORDINATES: E 348400  
 (OF APPROX. CENTRE OF PLAN) N 5822000 ZONE: 55

VESTING OF ROADS OR RESERVES	
IDENTIFIER	COUNCIL/BODY/PERSON
NIL	NIL
NOTATIONS	
CONNECTION SHOWN IS NOT TO SCALE	

**COUNCIL CERTIFICATION AND ENDORSEMENT**

**COUNCIL NAME :** MANNINGHAM CITY COUNCIL      **REF :** 247-3367

- THIS PLAN IS CERTIFIED UNDER SECTION 6 OF THE SUBDIVISION ACT 1988.
- ~~THIS PLAN IS CERTIFIED UNDER SECTION 11(7) OF THE SUBDIVISION ACT 1988. DATE OF THE ORIGINAL CERTIFICATION UNDER SECTION 6 / / .~~
- ~~THIS IS A STATEMENT OF COMPLIANCE ISSUED UNDER SECTION 21 OF THE SUBDIVISION ACT 1988.~~

**OPEN SPACE**

- A REQUIREMENT FOR PUBLIC OPEN SPACE UNDER SECTION 18 OF THE SUBDIVISION ACT 1988 ~~HAS / HAS NOT BEEN MADE.~~
- ~~THE REQUIREMENT HAS BEEN SATISFIED.~~
- ~~THE REQUIREMENT IS TO BE SATISFIED IN STAGE.~~

COUNCIL DELEGATE  
~~COUNCIL SEAL~~  
 DATE 21 / 11 / 95  
~~RE CERTIFIED UNDER SECTION 11(7) OF THE SUBDIVISION ACT 1988~~  
~~COUNCIL DELEGATE~~  
~~COUNCIL SEAL~~  
~~DATE / /~~

EASEMENT INFORMATION				
<b>LEGEND:</b> A - APPURTENANT    E - ENCUMBERING EASEMENT    R - ENCUMBERING EASEMENT (ROAD)				
EASEMENT REFERENCE	PURPOSE	WIDTH (METRES)	ORIGIN	LAND BENEFITED/IN FAVOUR OF
(E-1)	DRAINAGE AND SEWERAGE DRAINAGE	3.05 3.05	L.P.116246 THIS PLAN	LAND IN L.P.116246 CITY OF MANNINGHAM

**DEPTH LIMITATION**  
 15.24 METRES BELOW SURFACE  
 APPLIES TO ALL LAND IN THIS PLAN

THIS SURVEY HAS BEEN CONNECTED TO PERMANENT MARKS No(s).  
 PROCLAIMED SURVEY AREA No.

**STAGING:**  
 THIS IS NOT A STAGED SUBDIVISION  
 PLANNING PERMIT No. 7830

**SURVEY:**  
 THIS PLAN IS BASED ON SURVEY

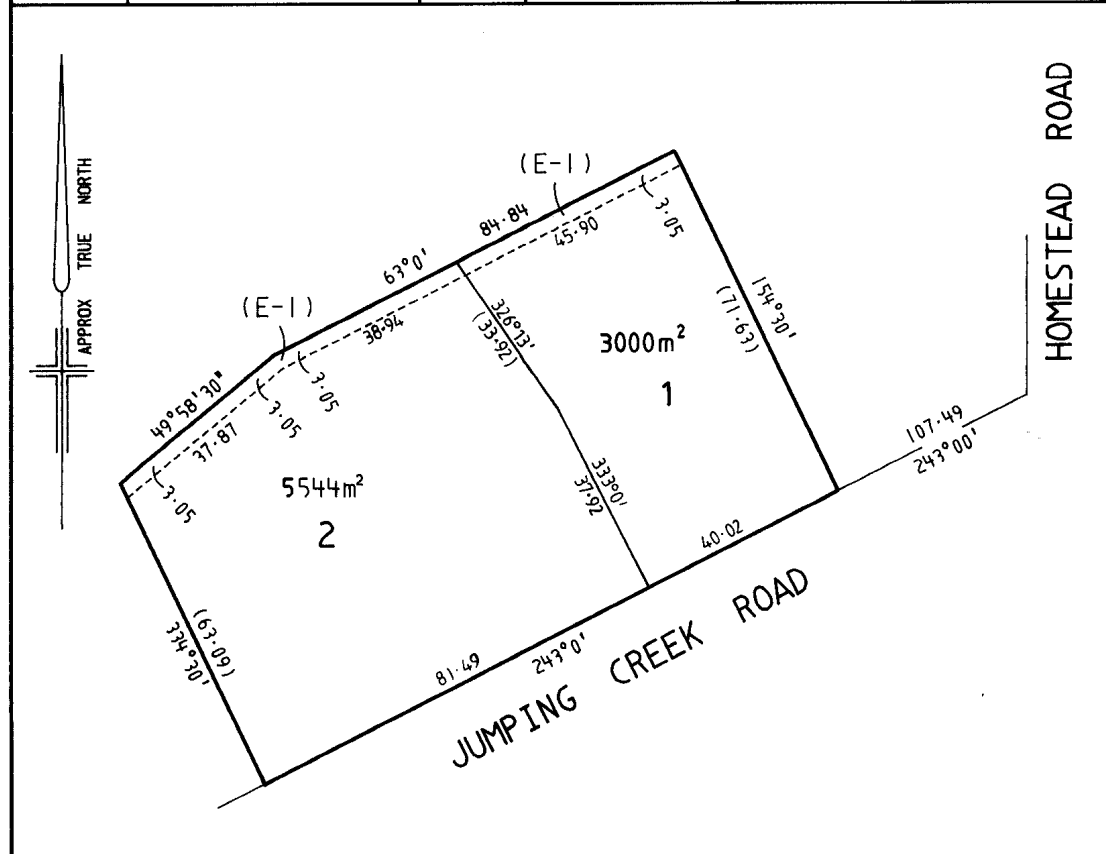

SCALE	
SCALE 1:1000	SHEET SIZE A3
SCALE	
<p>10 0 10 20 30 40 50 LENGTHS ARE IN METRES</p>	

**LTO USE ONLY**

STATEMENT OF COMPLIANCE/  
 EXEMPTION STATEMENT

RECEIVED

DATE 13 / 2 / 95

**LTO USE ONLY**

PLAN REGISTERED

TIME 8:30AM

DATE 19 / 2 / 96

ASSISTANT REGISTRAR OF TITLES

*John D. Turner*

SHEET 1 OF 1 SHEETS

breese pitt dixon Pty Ltd  
 1 Alfred Street, Hawthorn, Vic 3122  
 ph:818 0301 fax:819 5597

CHECKED \_\_\_\_\_ DATE 31/10/95

LICENSED SURVEYOR    EVAN E. PITT

SIGNATURE ..... DATE 31/10/95

REF: 5024      VERSION 3

.....

DATE 21 / 11 / 95

COUNCIL DELEGATE SIGNATURE

ORIGINAL SHEET SIZE A3