

## HISTORICAL SEARCH STATEMENT

## Land Use Victoria

Page 1 of 4

Produced 17/08/2024 02:19 PM

Volume 8981 Folio 077

Folio Creation: Created as paper folio continued as computer folio

Parent title Volume 06971 Folio 048

THE IMAGE OF THE FOLIO CEASED TO BE THE DIAGRAM LOCATION ON 13/06/2002 05:00:16 AM

### RECORD OF HISTORICAL DEALINGS

Date Lodged for Registration	Date Recorded on Register	Dealing	Imaged	Dealing Type and Details
---------------------------------	------------------------------	---------	--------	-----------------------------

### RECORD OF VOTS DEALINGS

Date Lodged for Registration	Date Recorded on Register	Dealing	Imaged
---------------------------------	------------------------------	---------	--------

02/03/2007	02/03/2007	AE930017P	Y
------------	------------	-----------	---

DISCHARGE OF MORTGAGE  
MORTGAGE(S) REMOVED  
S976184P

02/03/2007	02/03/2007	AE930018M	Y
------------	------------	-----------	---

MORTGAGE OF LAND  
MORTGAGE AE930018M 02/03/2007  
AUSTRALIA AND NEW ZEALAND BANKING GROUP LIMITED

29/04/2010	29/04/2010	AH190350Y	Y
------------	------------	-----------	---

MORTGAGE OF LAND  
MORTGAGE AH190350Y 29/04/2010  
AUSTRALIA AND NEW ZEALAND BANKING GROUP LTD

03/03/2014	03/03/2014	AK940720M (O)	Y
------------	------------	---------------	---

DISCHARGE OF MORTGAGE  
AFFECTED ENCUMBRANCE(S) AND REMOVED MORTGAGE(S)  
MORTGAGE AH190350Y

03/03/2014	03/03/2014	AK940721K (O)	Y
------------	------------	---------------	---

DISCHARGE OF MORTGAGE  
AFFECTED ENCUMBRANCE(S) AND REMOVED MORTGAGE(S)  
MORTGAGE AE930018M

03/03/2014	03/03/2014	AK940722H (O)	Y
------------	------------	---------------	---

MORTGAGE OF LAND  
MORTGAGE AK940722H 03/03/2014  
NATIONAL AUSTRALIA BANK LTD

19/09/2018	19/09/2018	AR467774N (E)	N
------------	------------	---------------	---

DISCHARGE OF MORTGAGE

## **HISTORICAL SEARCH STATEMENT**

## **Land Use Victoria**

Page 2 of 4

AFFECTED ENCUMBRANCE(S) AND REMOVED MORTGAGE(S)  
MORTGAGE AK940722H

STATEMENT END

## **VOTS Snapshot**

Volume 08981 Folio 077  
124020971574P  
Produced 02/03/2007 12:04 pm

## **LAND DESCRIPTION**

Lot 2 on Plan of Subdivision 066704.  
PARENT TITLE Volume 06971 Folio 048  
Created by instrument E814898 16/05/1973

## **REGISTERED PROPRIETOR**

Estate Fee Simple  
Joint Proprietors  
KEITH WILLIAM RITCHIE  
FOTINA RITCHIE both of FLAT 21 NO 86 GRAHAM ROAD ROSANNA  
H365281 09/01/1979

## **ENCUMBRANCES, CAVEATS AND NOTICES**

MORTGAGE S976184P 09/03/1994  
NATIONAL AUSTRALIA BANK LIMITED

Any encumbrances created by Section 98 Transfer of Land Act 1958 or Section 24 Subdivision Act 1988 and any other encumbrances shown or entered on the plan or imaged folio set out under DIAGRAM LOCATION below.

## **DIAGRAM LOCATION**

SEE LP066704 FOR FURTHER DETAILS AND BOUNDARIES

---

## **Paper Title Images**

8981/077 - Version 0, Date 09/03/2000

ORIGINAL

NOT TO BE TAKEN FROM THE OFFICE  
OF TITLES



VICTORIA

REGISTER BOOK

VOL. 8981 FOL. 077

# Certificate of Title

UNDER THE "TRANSFER OF LAND ACT"

VOL. 8981 FOL. 077

DONALD LESLIE NELSON Brick layer and SHARON FRANCES NELSON Married- -  
Woman both of 63 Balmoral Avenue Springvale are now joint proprietors  
of an estate in fee simple subject to the encumbrances notified hereunder  
in so much as lies above the depth of Fifty feet below the surface of - -  
ALL THAT piece of land delineated and coloured purple on the map hereon -  
containing One acre or thereabouts being Lot 2 on Plan of Subdivision - -  
No.66704 and being part of Crown Allotment 14<sup>H</sup> Parish of Warrandyte - --  
County of Evelyn - - - - -

DATED the 16th day of May 1973

*B.R. Hall*  
Assistant Registrar of Titles



ENCUMBRANCES REFERRED TO

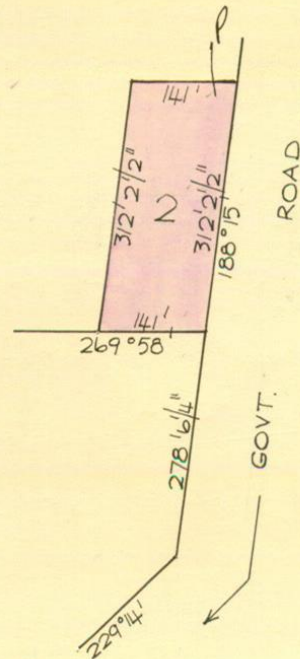

MEASUREMENTS ARE IN Feet And Inches

Derived from Vol.6971 Fol.048  
E814898



# MORTGAGE

to THE RESI PERMANENT  
BUILDING SOCIETY  
Registered 16th May 1978  
No. E814899

DISCHARGED  
12 JAN 1979



CAVEAT NO. H 288356 Lapsed 31st Oct 1978

CAVEAT Lapsed - 2 FEB 1979



KEITH WILLIAM RITCHIE Shop Proprietor and  
FOTINA RITCHIE Married Woman both of  
Flat 21 No.86 Graham Road Rosanna are  
now JOINT PROPRIETORS  
Registered 9th January 1979  
No. H365281



# MORTGAGE

to THE COMMISSIONERS  
OF THE STATE SAVINGS BANK OF VICTORIA  
Registered 9th January 1979  
No. H365282

DISCHARGED  
15 FEB 1980

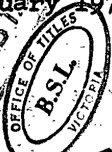

# MORTGAGE TO AUSTRALIA AND NEW ZEALAND BANKING GROUP LIMITED

Registered 31 MAR 1982

No. J 874326

DISCHARGED  
- 9 MAR 1994



MORTGAGE  
NATIONAL AUSTRALIA BANK LIMITED  
5976184P 09/03/94



T08981-077-1-8

V.8981

F.077