



Imaged Document Cover Sheet

The document following this cover sheet is an imaged document supplied by LANDATA®, Secure Electronic Registries Victoria.

Document Type	Cancelled Title
Document Identification	8056/743
Number of Pages (excluding this cover sheet)	2
Document Assembled	15/06/2024 13:58

Copyright and disclaimer notice:

© State of Victoria. This publication is copyright and includes confidential information. No part may be reproduced by any process except in accordance with the provisions of the Copyright Act or pursuant to a written agreement. The State of Victoria does not warrant the accuracy or completeness of the information in this publication and any person using or relying upon such information does so on the basis that the State of Victoria shall bear no responsibility or liability whatsoever for any errors, faults, defects or omissions in the information.

The document is invalid if this cover sheet is removed or altered.

ORIGINAL
NOT TO BE TAKEN FROM
THE OFFICE OF TITLES



VICTORIA

CANCELLED
Entered in the Register Book

Vol. 8056 Fol. 743

Certificate of Title
UNDER THE "TRANSFER OF LAND ACT 1928"

Clive Olaf Hill of Henley Estate Lilydale Farmer is -----
now the proprietor -----
of an Estate in Fee-simple subject to the Encumbrances notified hereunder in

All that piece of Land, delineated and coloured on the map in the margin containing One hundred and fifty-one acres Two roods and Twenty-four perches or ----- thereabouts being Crown Allotment A³ and part of Crown Allotments A^{One} and A² ----- Parish of Sutton County of Evelyn - Together with a right to enter into and upon the land coloured yellow on the said map and to erect and maintain thereon an engine windmill or pump for the pumping of water from the River Yarra and to build or ----- construct water pipes at least 2 feet under the surface of the said land coloured -- yellow and for that purpose to dig cut and excavate and do all things necessary for the laying building and construction of the said pipes and the erection of the said engine windmill or pump and with full power all times hereafter to use the said land coloured yellow for the carrying or conveying of water as aforesaid and to enter --- upon the said land coloured yellow for the purpose of replacing repairing altering-- cleansing or maintaining such pipes and such engine windmill or pump as occasion may arise -----

Dated the Sixth day of April One thousand nine hundred and fifty-one.

J. J. Murney
Assistant Registrar of Titles



ENCUMBRANCES REFERRED TO

CHARGE (under the Wire Netting Act-- 1928) No. 773969 in the Register Book

The above Charge is
DISCHARGED
A18505
1 MAR 1963



ORIGINAL ONLY
Amended Discharged
No. 773969
24-6-99

DUPLICATE AMENDED
Olaf Hill
ASSISTANT REGISTRAR (3142867)
OF TITLES DATE 11-9-80

NO DEALING TO BE REGISTERED UNTIL
PLAN IS AMENDED ON DUPLICATE
SEE S.B. 16113

AO IN SB 16113
10-9-80

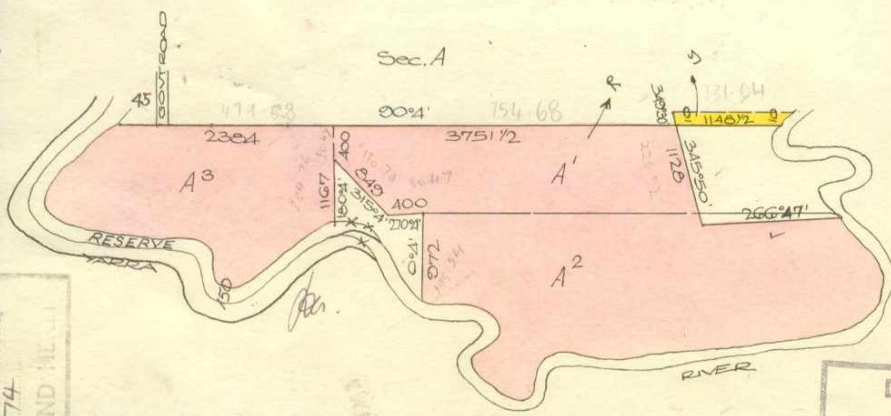

THE MEASUREMENTS ARE IN links



BETHAL NOMINEES PTY. LIMITED of 3rd Floor.
44 Market Street Melbourne is now the
proprietor
Registered 15th January 1981
No. J307174



MORTGAGE

JUDY MICHELLE TAUBER
U885953A 22/7/97



MORTGAGE TO NATIONAL AUSTRALIA BANK LIMITED

Registered 26 APR 1989

No. N4168304

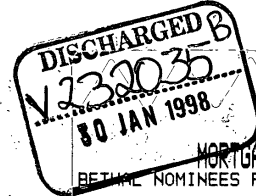

MORTGAGE
BETHAL NOMINEES PTY. LTD.

UB91407E 24/07/97



MORTGAGE
STATE BANK OF VICTORIA
REGISTERED 8/5/89
P173910H.

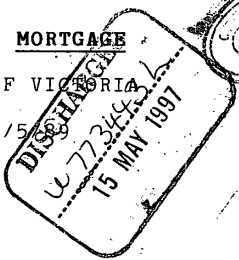

CANCELLED

NO. PS 415064K



CAVEAT
CAVEATOR: YARRA VALLEY GOLF PTY. LTD.
CAPACITY: SEE CAVEAT
LODGED BY: DEACONS GRAHAM & JAMES
NOTICE TO: LEVEL 24/385 BOURKE ST. MELBOURNE 3000
NO.: U46111L
DATE: 17/1/96



CAVEAT WILL LAPSE ON

REGISTRATION OF 4885949K
16 SEP 1997



CAVEAT
CAVEATOR: YARRA VALLEY GOLF PTY. LTD.
CAPACITY: PURCHASER/FEE SIMPLE
LODGED BY: DEACONS GRAHAM & JAMES
NOTICE TO: 24TH FLOOR 385 BOURKE ST.
MELBOURNE 3000

NO: U551934F
DATE: 12/12/96



CAVEAT WILL LAPSE ON

REGISTRATION OF 4885949K
16 SEP 1997



PROPRIETOR
YARRA VALLEY GOLF PTY. LTD.
LEVEL 3/410 COLLINS ST. MELBOURNE 3000
U885949K 22/7/97



48056 743

Delivered by LANDATA®
This document provides an electronic copy of the original document. It is not a replacement for the original document. The original document must be presented to the land to be registered.