



Imaged Document Cover Sheet

The document following this cover sheet is an imaged document supplied by LANDATA®, Secure Electronic Registries Victoria.

Document Type	Cancelled Title
Document Identification	8064/677
Number of Pages (excluding this cover sheet)	4
Document Assembled	20/11/2024 09:55

Copyright and disclaimer notice:

© State of Victoria. This publication is copyright and includes confidential information. No part may be reproduced by any process except in accordance with the provisions of the Copyright Act or pursuant to a written agreement. The State of Victoria does not warrant the accuracy or completeness of the information in this publication and any person using or relying upon such information does so on the basis that the State of Victoria shall bear no responsibility or liability whatsoever for any errors, faults, defects or omissions in the information.

The document is invalid if this cover sheet is removed or altered.

Vol. 3968 Fol. 405

Transfer 270 2344

Application

TRANSFER AS TO PART to *Peter James Barr*
and *Sydney Helen Barr* registered
on 2 MAY 1956 numbered *A 149559*
CANCELLED AS TO PART See Certificate of
Title Vol. 8110 Fol. 56

Aua 7^A 3^R 38 Assistant Registrar of Titles

TRANSFER AS TO BALANCE No. *E 144544*
registered *27th August 1971*
CANCELLED See Vol. 8901 Fol. 244



CANCELLED



Delivered
LANDATA®
WARNING
The document provides an indication of the Registrar. It is not a statement
from the register or containing information in relation to the land to which it refers.

SCALE: *3 Chains* to one inch.

Vol. *8064* Fol. *~677*

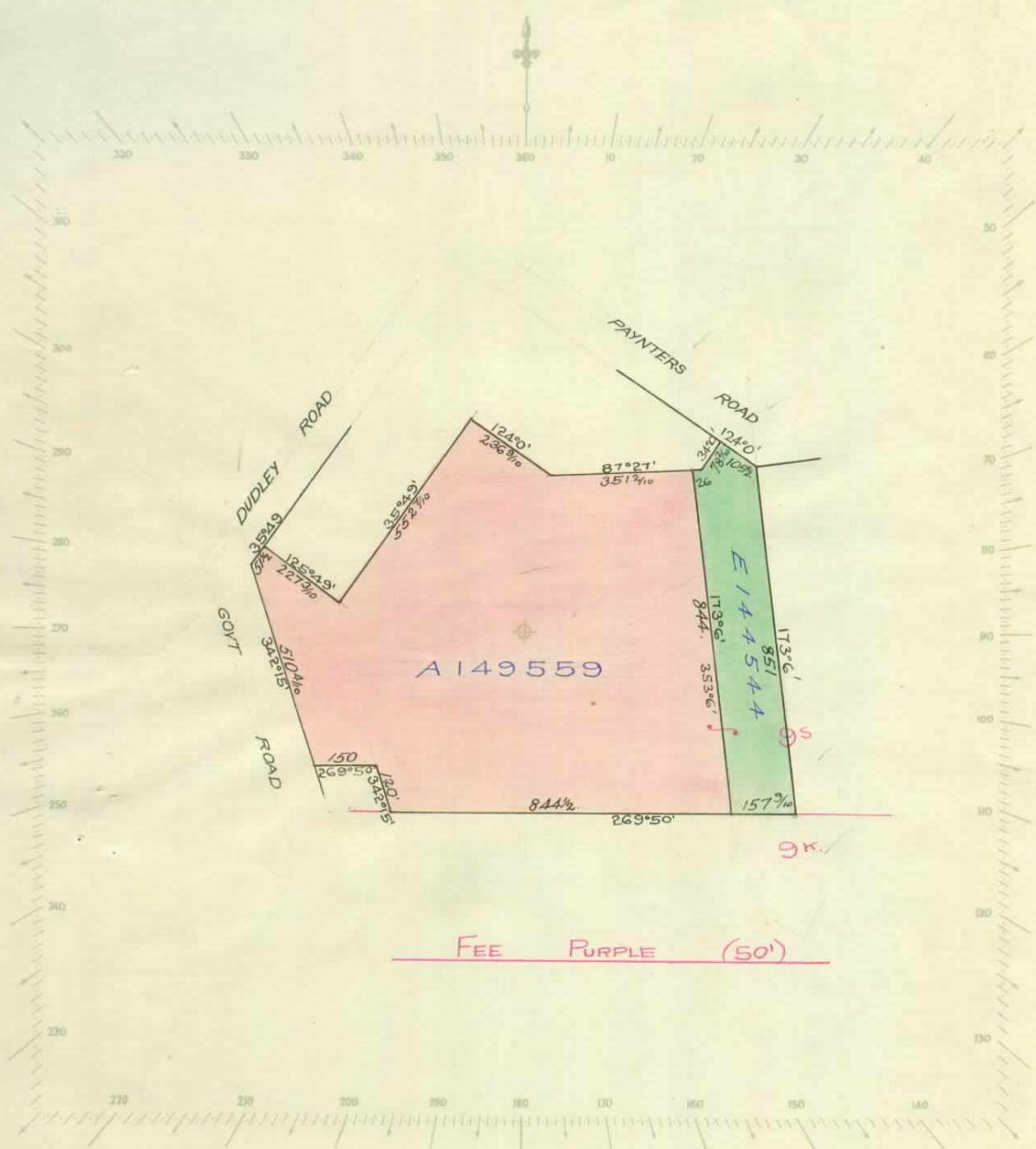

Delivered on-line by LANDATA®

WARNING This document provides an image of a cancelled folio of the Register. It is not a statement from the register of subsisting information in relation to the land to which it refers.

Handwritten notes: 2-1-17, 7-3-38, 1-11-19

Handwritten signature and date: 27-7-76.

Natural Resources and Environment
AGRICULTURE, FORESTRY, FISHERIES, SOIL, MARINE AND LAND MANAGEMENT

INTERNATIONAL
CLARK

Delivered by LANDATA®
WARNING: This document contains information in relation to the land to which it refers.

