

HISTORICAL SEARCH STATEMENT

Land Use Victoria

Produced 23/11/2024 04:13 PM

Volume 9073 Folio 710

Folio Creation: Created as paper folio continued as computer folio

Parent title Volume 08061 Folio 949

THE IMAGE OF THE FOLIO CEASED TO BE THE DIAGRAM LOCATION ON 14/09/2002 05:01:26 AM

RECORD OF HISTORICAL DEALINGS

Date Lodged for Registration	Date Recorded on Register	Dealing	Imaged	Dealing Type and Details
------------------------------	---------------------------	---------	--------	--------------------------

RECORD OF VOTS DEALINGS

Date Lodged for Registration	Date Recorded on Register	Dealing	Imaged
------------------------------	---------------------------	---------	--------

12/09/2016	12/09/2016	AN093974W (E)	N
------------	------------	---------------	---

CONVERT PCT AND NOMINATE ECT TO LODGEMENT CASE
LC Id: 801746
Removed by Dealing AN094343E

12/09/2016	12/09/2016	AN094343E (E)	N
------------	------------	---------------	---

DISCHARGE OF MORTGAGE
AFFECTED ENCUMBRANCE(S) AND REMOVED MORTGAGE(S)
MORTGAGE W585119X

STATEMENT END

VOTS Snapshot

VOLUME 09073 FOLIO 710
124062347663E
Produced 12/09/2016 12:18 pm

LAND DESCRIPTION

Lot 1 on Title Plan 146386V (formerly known as Lot 2 on Plan of Subdivision 021576).

PARENT TITLE Volume 08061 Folio 949

Created by instrument F463772 18/09/1974

REGISTERED PROPRIETOR

Estate Fee Simple

Joint Proprietors

ALAN JOHN ALEXANDER HASSAN

HISTORICAL SEARCH STATEMENT

Land Use Victoria

Page 2 of 4

KATHLEEN MARIE HASSAN both of 26 DUDLEY RD WONGA PARK
U298189L 08/07/1996

ENCUMBRANCES, CAVEATS AND NOTICES

MORTGAGE W585119X 09/02/2000
NATIONAL AUSTRALIA BANK LTD

Any encumbrances created by Section 98 Transfer of Land Act 1958 or Section 24 Subdivision Act 1988 and any other encumbrances shown or entered on the plan set out under DIAGRAM LOCATION below.

DIAGRAM LOCATION

SEE TP146386V FOR FURTHER DETAILS AND BOUNDARIES

Paper Title Images

9073/710 - Version 1, Date 25/02/2000

ORIGINAL

**NOT TO BE TAKEN FROM THE OFFICE
OF TITLES**



VICTORIA

REGISTER BOOK

VOL. 9073 FOL. 710

Certificate of Title

UNDER THE "TRANSFER OF LAND ACT"

ROSENBERG & ASSOCIATES PTY. LTD. of 245 Dorset Road Boronia is now the -
proprietor of an estate in fee simple subject to the encumbrances notified -
hereunder in so much as lies above the depth of 15.24 metres below the - - -
surface of ALL THAT piece of land delineated and coloured purple and blue --
on the map hereon being Lot 2 on Plan of Subdivision No.21576 Parish of - - -
Warrandyte County of Evelyn - - - - -

FOL.

VOL.

DATED the 18th day of September 1974

Assistant Registrar of Titles



ENCUMBRANCES REFERRED TO

As to the land coloured blue - - - -
THE EASEMENTS (if any) existing over
the same by virtue of Section 98 of
the Transfer of Land Act - - - -

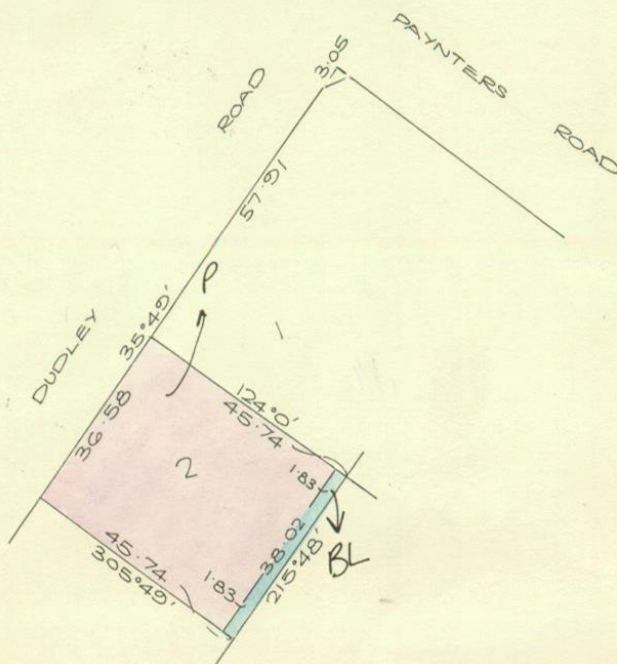

MEASUREMENTS ARE IN METRES

Derived from Vol.8061 Fol.949
F463772

MORTGAGE to GENERAL CREDITS

(FINANCE) PROPRIETARY LIMITED

Registered 18th September 1974

No. F4623

Discharged as to part of the within Land being the within Land
29 JAN 1976



MORTGAGE to AUSTRALIA AND NEW ZEALAND BANKING GROUP LIMITED

Registered 6th December 1975

No. F5142

Discharged as to part of the within Land being the within Land
29 JAN 1976

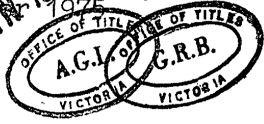

RALPH CECIL YORKE of 10 Waverley Avenue
Ivanhoe Company Director is now the
proprietor

Registered 29th January 1976

No. G12428



MORTGAGE TO COMMONWEALTH SAVINGS BANK OF AUSTRALIA

Registered 8 JUL 1985

No. G 225003

DISCHARGED
25 JAN 1985



JOINT PROPRIETORS
ALAN JOHN ALEXANDER HASSAN &
KATHLEEN MARIE HASSAN
26 DUDLEY RD. WONGA PARK
U298189L 08/07/96

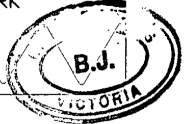

MORTGAGE
PERPETUAL TRUSTEES AUSTRALIA
LIMITED
U298190L 08/07/96

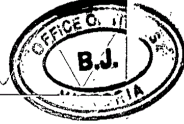

DISCHARGED
W5851183
-9 FEB 2000

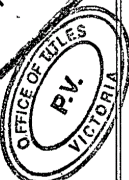

MORTGAGE
NATIONAL AUSTRALIA BANK LIMITED
W585119X 09/02/00

