



# Imaged Document Cover Sheet

The document following this cover sheet is an imaged document supplied by LANDATA®, Secure Electronic Registries Victoria.

Document Type	<b>Plan</b>
Document Identification	<b>PS346507J</b>
Number of Pages (excluding this cover sheet)	<b>3</b>
Document Assembled	<b>22/11/2024 10:22</b>

**Copyright and disclaimer notice:**

© State of Victoria. This publication is copyright. No part may be reproduced by any process except in accordance with the provisions of the Copyright Act 1968 (Cth) and for the purposes of Section 32 of the Sale of Land Act 1962 or pursuant to a written agreement. The information is only valid at the time and in the form obtained from the LANDATA® System. None of the State of Victoria, LANDATA®, Secure Electronic Registries Victoria Pty Ltd (ABN 86 627 986 396) as trustee for the Secure Electronic Registries Victoria Trust (ABN 83 206 746 897) accept responsibility for any subsequent release, publication or reproduction of the information.

The document is invalid if this cover sheet is removed or altered.

<b>PLAN OF SUBDIVISION</b>		STAGE NO. /	LTO use only <b>EDITION 2</b>	Plan Number <b>PS 346507J</b>
<b>Location of Land</b> Parish: <b>WARRANTYTE</b> <del>Township:</del> <del>Section:</del> Crown Allotment: <b>9S (PART)</b> <del>Crown Portion:</del>  LTO Base Record: <b>CHART 20 (3753)</b> Title Reference: <b>VOL.9635 FOL.598</b>  Last Plan Reference: <b>LP 200888Y (LOT 1)</b> Postal Address: <b>10 PAYNTERS ROAD</b> (at time of subdivision) <b>WONGA PARK, 3115.</b>  AMG Co-ordinates <b>E 347 950</b> Zone: <b>55</b> (of approx. centre of land in plan) <b>N 5822 150</b>		<b>Council Certificate and Endorsement</b> Council Name: <b>MANNINGHAM CITY COUNCIL</b> Ref: <b>247-3365</b> 1. This plan is certified under section 6 of the Subdivision Act 1988. <del>2. This plan is certified under section 11(7) of the Subdivision Act 1988.</del> <del>Date of original certification under section 6 / /</del> 3. This is a statement of compliance issued under section 21 of the Subdivision Act 1988. <b>OPEN SPACE</b> (i) A requirement for public open space under section 18 of the Subdivision Act 1988 <del>has/has not been made.</del> <del>(ii) The requirement has been satisfied.</del> <del>(iii) The requirement is to be satisfied in Stage.....</del> Council delegate <del>Council seal</del> Date <b>18 / 8 / 95</b> <del>Re-certified under section 11(7) of the Subdivision Act 1988</del> <del>Council Delegate</del> <del>Council Seal</del> <del>Date / /</del>		
<b>Vesting of Roads and/or Reserves</b>				
Identifier	Council/Body/Person			
NIL	NIL			
<b>Notations</b>				
<b>Staging</b>		This <del>is</del> /is not a staged subdivision Planning Permit No. <b>7738</b>		
<b>Depth Limitation</b>		15-24m BELOW THE SURFACE APPLIES TO ALL THE LAND IN THIS PLAN.		
<b>Survey</b> This plan <del>is/</del> is based on survey This survey has been connected to permanent marks no(s) — In Proclaimed Survey Area No. —				
<b>Easement Information</b>				<b>LTO use only</b>
<b>Legend:</b> E - Encumbering Easement or Condition in Crown Grant in the Nature of an Easement A - Appurtenant Easement R - Encumbering Easement (Road)				Statement of Compliance/ Exemption Statement
				Received <input checked="" type="checkbox"/> Date <b>21 / 8 / 95</b>
Easement Reference	Purpose	Width (Metres)	Origin	Land Benefited/In Favour Of
E-1	DRAINAGE	SEE DIAG	C/E R743869N	SHIRE OF LILLYDALE
E-2	DRAINAGE		THIS PLAN	MANNINGHAM CITY COUNCIL
				<b>LTO use only</b> PLAN REGISTERED TIME <b>11:35 AM.</b> DATE <b>29 / 8 / 95</b> <i>[Signature]</i> Assistant Registrar of Titles
				Sheet <b>1</b> of <b>2</b> Sheets
<b>Millar &amp; Merrigan Pty. Ltd.</b> <small>TOWN PLANNERS LAND SURVEYORS &amp; CONSULTING ENGINEERS A.C.N. 005 541 668 21 COOLSTORE ROAD, CROYDON, 3136. P.O. BOX 247 (FAX. 725 2710) PH. 725 8866</small>		LICENSED SURVEYOR (PRINT) <b>G.J. EDWARDS</b> SIGNATURE..... DATE / / REF <b>984051</b> VERSION <b>2 : 2/8/95</b>		DATE / / COUNCIL DELEGATE SIGNATURE Original sheet size A3

**PLAN OF SUBDIVISION**

Stage No.

Plan Number

**PS 346507J**

ROAD

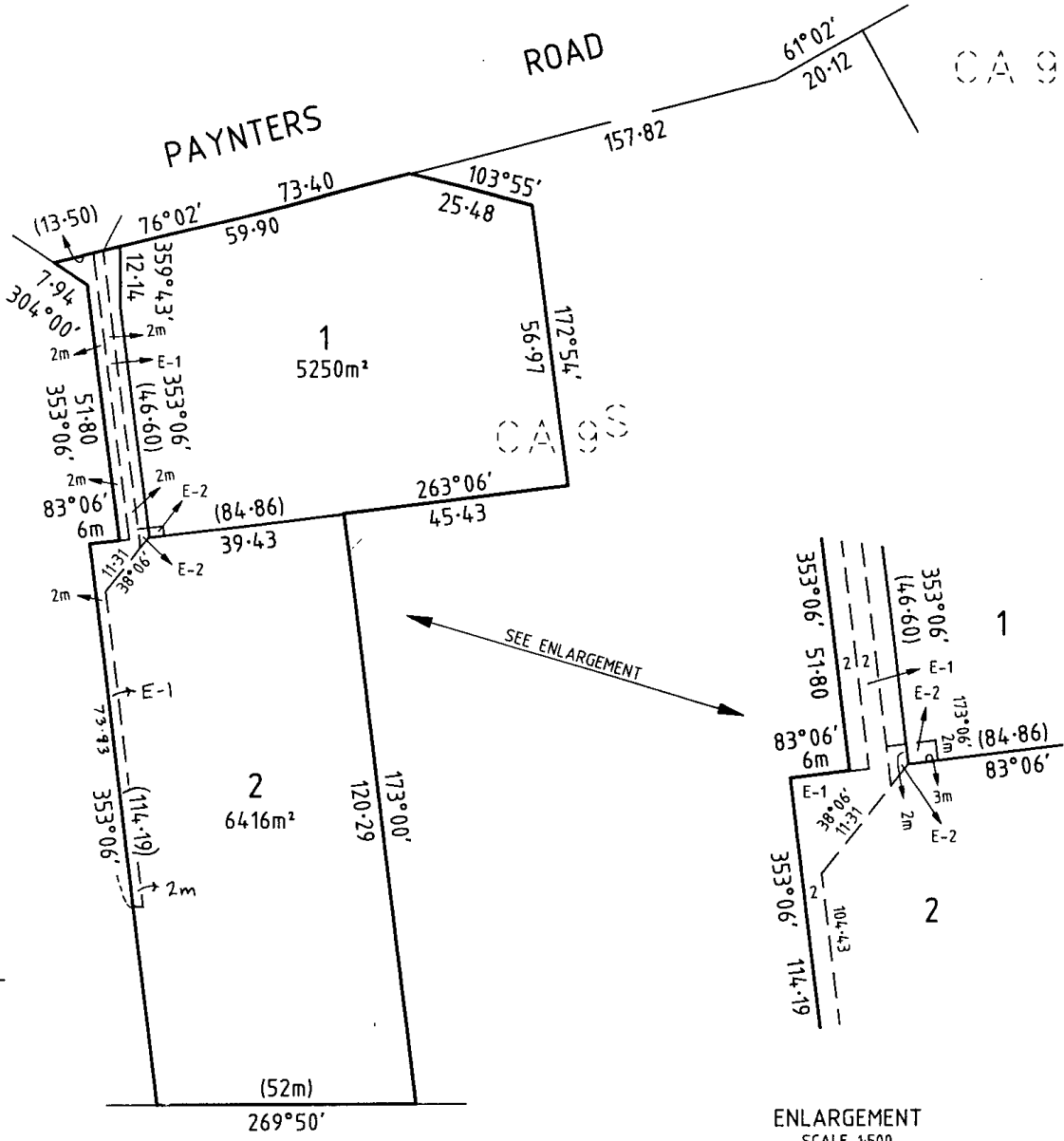

SEE ENLARGEMENT

ENLARGEMENT  
SCALE 1:500

5 0 5 10 15 20  
LENGTHS ARE IN METRES

SCALE 1:1000  
10 0 10 20 30 40  
LENGTHS ARE IN METRES

APPROX TRUE NORTH

0 10 20 30 40 50 60 70 80 90 100 110 120 130 140 150 mm

**Millar & Merrigan Pty. Ltd.**

TOWN PLANNERS LAND SURVEYORS & CONSULTING ENGINEERS  
A.C.N. 005 541 868  
21 GOOLSTORE ROAD, CROYDON, 3136, P.O. BOX 247  
(FAX. 725 2710) PH. 725 8866

Sheet 2 of 2 sheets

LICENSED SURVEYOR (PRINT) **G.J. EDWARDS**

SIGNATURE..... DATE / /

REF **984051** VERSION 2

DATE / /

COUNCIL DELEGATE SIGNATURE

Original sheet size A3

ORIGINAL  
SCALE AS SHOWN SHEET SIZE A3

SCALE  
LENGTHS ARE IN METRES

# MODIFICATION TABLE

RECORD OF ALL ADDITIONS OR CHANGES TO THE PLAN

PLAN NUMBER

PS346507J

AFFECTED LAND / PARCEL	LAND / PARCEL IDENTIFIER CREATED	MODIFICATION	DEALING NUMBER	DATE	TIME	EDITION NUMBER	ASSISTANT REGISTRAR OF TITLES
Lot 2		Partial -Removal of Easement	PS433744J	7/8/01		2	