



Imaged Document Cover Sheet

The document following this cover sheet is an imaged document supplied by LANDATA®, Secure Electronic Registries Victoria.

Document Type	Cancelled Title
Document Identification	8108/205
Number of Pages (excluding this cover sheet)	6
Document Assembled	05/12/2024 07:15

Copyright and disclaimer notice:

© State of Victoria. This publication is copyright and includes confidential information. No part may be reproduced by any process except in accordance with the provisions of the Copyright Act or pursuant to a written agreement. The State of Victoria does not warrant the accuracy or completeness of the information in this publication and any person using or relying upon such information does so on the basis that the State of Victoria shall bear no responsibility or liability whatsoever for any errors, faults, defects or omissions in the information.

The document is invalid if this cover sheet is removed or altered.

CANCELLED

Entered in the Register Book

ORIGINAL
NOT TO BE TAKEN FROM
THE OFFICE OF TITLES



Vol. 8108 Fol. 205

VICTORIA

Certificate of Title

UNDER THE "TRANSFER OF LAND ACT 1954"

A.H.
21.8.56

Nellie Joan Raby of 16 Maple Crescent Camberwell Married Woman is -----
 now the proprietor -----
 of an Estate in Fee-simple subject to the Encumbrances notified hereunder in
 the surface and down to the depth of Fifty feet below the surface of -
 All that piece of Land, delineated and coloured purple, ^{blue hatched} and blue on the map
 on the sheet annexed hereto containing ~~Nineteen acres Two roods One perch and~~ ^{7.90ha} -----
~~one-half of a perch or thereabouts being Lots Eleven and 29 on Plan of Subdivision-~~
 No. 32864 lodged in the Office of Titles and being part of Crown Allotment 9^K -----
 Parish of Warrandyte County of Evelyn -----

Dated the Twenty-ninth day of July One
 thousand nine hundred and fifty-two.

W.P. Burgess
 Assistant Registrar of Titles



ENCUMBRANCES REFERRED TO

As to the land coloured blue ^{and blue hatched}
 THE EASEMENTS (if any) existing over
 the same by virtue of Section 98 of
 the Transfer of Land Act 1954 -----

The encumbrance notified hereon has
 ceased to affect the land coloured blue hatched
 Vide Ap60531C Soc. 73 *A.H.*
 7-10-1985
 Assistant Registrar of Titles

Ap 60531 C / 73
 AFFECTS LAND HEREIN

Delivered
on-line by
LANDATA®

WARNING
This document provides an image of a cancelled folio of the Register. It is not a statement
from the register of subsisting information in relation to the land to which it refers.

7.90ha

Vol. 6714 Fol. 624

Transfer 2509367

Application

CAVEAT No. 125493 LODGED 6 April 1955

CAVEAT LAPPED

FREDERICK JAMES KNEE of Yarra Road Croydon
Orchardist is now the proprietor by
Transfer A908336
Registered 15th February 1960



TRANSFER AS TO PART No. B37590
registered 17 August 1960
CANCELLED AS TO PART See Vol. 8326 Fol. 468



TRANSFER AS TO PART No. J47339
registered 10th APRIL 1981
CANCELLED AS TO PART
See Vol. 9435 Fol. 795



CREATION OF EASEMENT

Registered 28th May 1984
No. L58018L



CAVEAT No. M359802 LODGED - 9 JUL. 1980

Affecting part of the land herein
(PLAN)

CAVEAT WITHDRAWN
19.1.87



CAVEAT No. M402650 LODGED 4 AUG 1986

AFFECTING PART OF THE LAND HEREIN PLAN

Caveat transferred to new C/T



CANCELLED AS TO BALANCE.

The following Titles have been issued
Pursuant to Regulation 10 of the
Transfer of Land Act

on 20/2/87 Fol. 899
Lots A to B in Vol. 9727 Fol. 900
in Vol. 9727 Fol. 900

on LP 206469N



CANCELLED

V.8108 E.205



T08108-205-1-4

Delivered by LANDATA® The Government of Victoria. From the register of existing titles in relation to the land to which it refers.

This is the Annexed Sheet referred to in
Certificate of Title entered in the Register
Book, Vol. 810 Fol. 205

W. B. Morrison
Assistant Registrar of Titles.

Delivered
on-line by
LANDATA®

WARNING
This document provides an image of a cancelled folio of the Register. It is not a statement
from the register of subsisting information in relation to the land to which it refers.

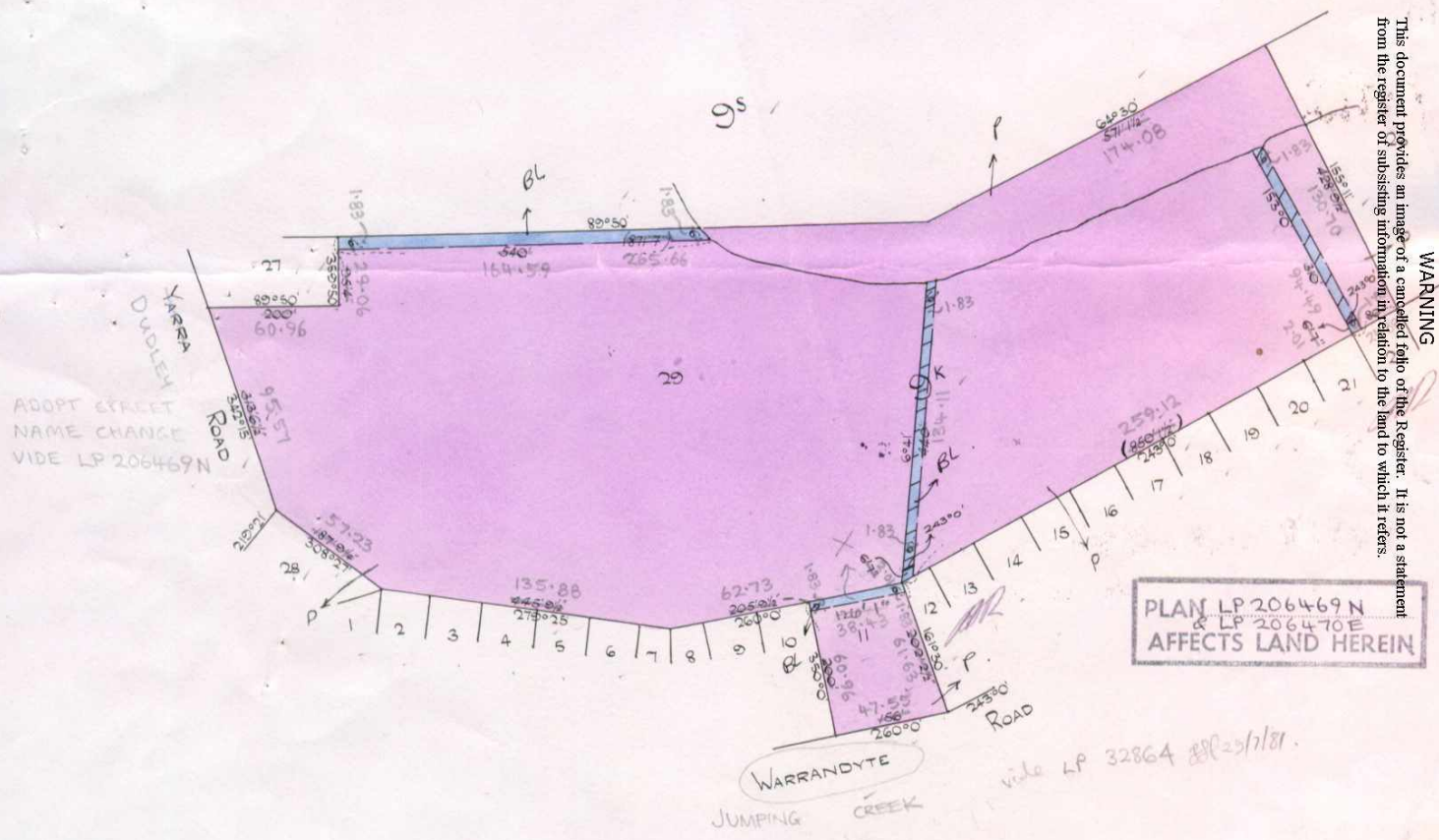

METRES
THE MEASUREMENTS ARE IN FEET AND INCHES

Delivered by LANDATA®
The document provided is being delivered to you by LANDATA®
from the register of submitted information in relation to the land to which it refers.

Natural Resources and Environment
AGRICULTURE • RESOURCES • CONSERVATION • LAND MANAGEMENT

**INTENTIONALLY
BLANK**



SCALE: 200 Feet

Vol. 8108 Pl. 205

LP 206469N
CANCELS THIS TITLE
2 CERTS TO ISSUE

C/E L58018L
TO SHIRE OF LILLYDALE



Delivered on-line by LANDATA®

This document provides an image of a cancelled folio of the Register. It is not a statement from the register of subsisting information in relation to the land to which it refers.

WARNING

Delivered
on-line by
LANDATA®
This document provides an image of a certified color of the Register. It is not a statement
from the register. Some information in relation to the land to which it refers
WARNING

Natural Resources and Environment
AGRICULTURE • SURVEYS • CONSERVATION • LAND MANAGEMENT

**INTENTIONALLY
BLANK**

