

HISTORICAL SEARCH STATEMENT

Land Use Victoria

Produced 11/12/2024 10:17 AM

Volume 9577 Folio 551

Folio Creation: Created as paper folio continued as computer folio

Parent title Volume 08054 Folio 201

THE IMAGE OF THE FOLIO CEASED TO BE THE DIAGRAM LOCATION ON 20/03/2006 02:03:34 PM

RECORD OF HISTORICAL DEALINGS

Date Lodged for Registration	Date Recorded on Register	Dealing	Imaged	Dealing Type and Details
------------------------------	---------------------------	---------	--------	--------------------------

RECORD OF VOTS DEALINGS

Date Lodged for Registration	Date Recorded on Register	Dealing	Imaged
------------------------------	---------------------------	---------	--------

16/08/2007	16/08/2007	AF276814W	Y
------------	------------	-----------	---

DISCHARGE OF MORTGAGE
MORTGAGE(S) REMOVED
V138186Q

16/08/2007	16/08/2007	AF276815U	Y
------------	------------	-----------	---

MORTGAGE OF LAND
MORTGAGE AF276815U 16/08/2007
PEPPER FINANCE CORPORATION LIMITED

03/05/2016	03/05/2016	AM742040X	Y
------------	------------	-----------	---

DISCHARGE OF MORTGAGE
AFFECTED ENCUMBRANCE(S) AND REMOVED MORTGAGE(S)
MORTGAGE AF276815U

21/07/2022	21/07/2022	AV878804E (E)	N
------------	------------	---------------	---

CAVEAT

CAVEAT AV878804E 21/07/2022

Caveator

JASMINE MAY TURNER

JOSHUA STEPHEN TURNER

Grounds of Claim

PURCHASERS' CONTRACT WITH THE FOLLOWING PARTIES AND DATE.

Parties

THE REGISTERED PROPRIETOR(S)

Date

02/07/2022

Estate or Interest

FREEHOLD ESTATE

Prohibition

ABSOLUTELY

Lodged by

BELMAR CONVEYANCING SERVICES

Notices to

BELINDA BERNARDINI of 159 MAIN STREET CROYDON VIC 3136

HISTORICAL SEARCH STATEMENT

Land Use Victoria

Page 2 of 5

14/10/2022 14/10/2022 AW160781J (E) N

CONVERT PCT AND NOMINATE ECT TO LODGEMENT CASE

LC Id: 534671514

Removed by Dealing AW162743G

14/10/2022 14/10/2022 AW162743G (E) N

TRANSFER OF LAND BY ENDORSEMENT AND REMOVAL OF CAVEAT AV878804E

FROM:

DAVID GRANT ANDERSON

WENDY ELIZABETH ANDERSON

TO:

JASMINE MAY TURNER

JOSHUA STEPHEN TURNER

RESULTING PROPRIETORSHIP:

Estate Fee Simple

Joint Proprietors

JASMINE MAY TURNER

JOSHUA STEPHEN TURNER both of 16 HARTLEY ROAD WONGA PARK VIC 3115

AW162743G 14/10/2022

14/10/2022 14/10/2022 AW162744E (E) N

MORTGAGE OF LAND

MORTGAGE AW162744E 14/10/2022

NATIONAL AUSTRALIA BANK LTD

STATEMENT END

VOTS Snapshot

Volume 09577 Folio 551

124023001290C

Produced 16/08/2007 11:18 am

LAND DESCRIPTION

Lot 1 on Plan of Subdivision 146745W.

PARENT TITLE Volume 08054 Folio 201

Created by instrument LP146745W 30/10/1984

REGISTERED PROPRIETOR

Estate Fee Simple

Joint Proprietors

DAVID GRANT ANDERSON

WENDY ELIZABETH ANDERSON both of 114 JUMPING CREEK RD WONGA PARK 3115

V138185T 08/12/1997

ENCUMBRANCES, CAVEATS AND NOTICES

MORTGAGE V138186Q 08/12/1997

PERPETUAL TRUSTEES AUSTRALIA LIMITED

Any encumbrances created by Section 98 Transfer of Land Act 1958 or Section 24 Subdivision Act 1988 and any other encumbrances shown or entered on the

plan or imaged folio set out under DIAGRAM LOCATION below.

DIAGRAM LOCATION

SEE LP146745W FOR FURTHER DETAILS AND BOUNDARIES

Paper Title Images

9577/551 - Version 0, Date 15/03/1999

ORIGINAL

**NOT TO BE TAKEN FROM THE OFFICE
OF TITLES**



VICTORIA

REGISTER BOOK

VOL. **9577** FOL. **551**

Certificate of Title

UNDER THE "TRANSFER OF LAND ACT"

JOHN MEREDITH VERGERS and ELIZABETH ANNE VERGERS both of Hartley Road Wonga Park are JOINT PROPRIETORS of an estate in fee simple subject to the encumbrances notified hereunder in so much as lies above the depth of 15.24 METRES below the surface of all that land in the Parish of Warrandyte County of Evelyn being Lot 1 on Plan of Subdivision No. 146745W which land is shown enclosed by continuous lines on the map hereon and identified by that lot number

Issued under Regulation 10 -

Derived From
VOL. 8054 FOL. 201

30/10/84



Assistant Registrar of Titles

ENCUMBRANCES REFERRED TO

MORTGAGE F219684 and L163482 U -

As to any part of the land marked E-1 on the map that lies within the above-mentioned Lot -

THE EASEMENTS (if any) existing over the same by virtue of Section 98 of the Transfer of Land Act -

**THE ABOVE MORTGAGES
ARE DISCHARGED AS TO
PART BEING THE WITHIN
LAND.**

4 DEC 1985

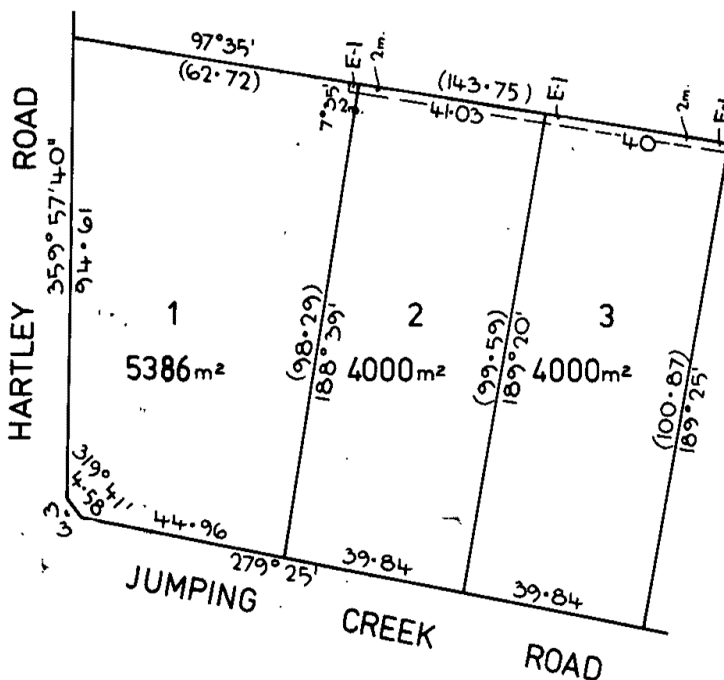

MEASUREMENTS ARE IN METRES



T09577-551-1-3

JOINT PROPRIETORS
ONE JOSEPH PARKINSON & CAROL MAY PARKINSON
OF SHEEP STATEION CREEK RD. YELLINGBO
REGISTERED 4/12/85
M24969B



MORTGAGE
NATIONAL AUSTRALIA BANK LIMITED
REGISTERED 4/12/88
M24970B

DISCHARGED
-8 DEC 1997
V138185T



JOINT PROPRIETORS
~~-GRANT-~~
DAVID ~~GRANTED~~ ANDERSON &
WENDY ELIZABETH ANDERSON
114 JUMPING CREEK RD. WONGA PARK 3115
V138185T 8/12/97

ORIGINAL ONLY
Amended (NAME)
No. V154131P
27 JAN 1998



MORTGAGE

PERPETUAL TRUSTEES AUSTRALIA LIMITED
V138186Q 8/12/97

