

Produced 12/12/2024 10:51 PM

Volume 9666 Folio 202

Folio Creation: Created as paper folio continued as computer folio

Parent title Volume 09204 Folio 391

RECORD OF HISTORICAL DEALINGS

Date Lodged for Registration	Date Recorded on Register	Dealing	Imaged	Dealing Type and Details
05/06/1997	12/06/1997	U808127K	N	DISCHARGE OF MORTGAGE T065571P
05/06/1997	12/06/1997	U808128G	Y	TRANSFER FROLLEY, PAULINE MARGARET
05/06/1997	12/06/1997	U808129D	Y	MORTGAGE NATIONAL AUSTRALIA BANK LIMITED

RECORD OF VOTS DEALINGS

Date Lodged for Registration	Date Recorded on Register	Dealing	Imaged
------------------------------	---------------------------	---------	--------

27/07/2011	05/10/2011	AJ095335H	Y
------------	------------	-----------	---

DISCHARGE OF MORTGAGE
AFFECTED ENCUMBRANCE(S) AND REMOVED MORTGAGE(S)
MORTGAGE U808129D

27/07/2011	05/10/2011	AJ095336F	Y
------------	------------	-----------	---

VARIATION OF COVENANT
COVENANT (as to whole or part of the land) in instrument P203767T
19/05/1989
VARIATION OF COVENANT AJ095336F 27/07/2011

STATEMENT END

VOTS Snapshot

VOLUME 09666 FOLIO 202
124039419316V
Produced 05/10/2011 10:02 am

LAND DESCRIPTION

Lot 1 on Plan of Subdivision 202454Y.
PARENT TITLE Volume 09204 Folio 391
Created by instrument LP202454Y 12/03/1986

REGISTERED PROPRIETOR

Estate Fee Simple
Sole Proprietor
PAULINE MARGARET FROLLEY of 106 JUMPING CREEK RD. WONGA PARK 3115
U808128G 05/06/1997

ENCUMBRANCES, CAVEATS AND NOTICES

MORTGAGE U808129D 05/06/1997
NATIONAL AUSTRALIA BANK LTD

COVENANT (as to whole or part of the land) in instrument P203767T 19/05/1989

Any encumbrances created by Section 98 Transfer of Land Act 1958 or Section 24 Subdivision Act 1988 and any other encumbrances shown or entered on the plan or imaged folio set out under DIAGRAM LOCATION below.

DIAGRAM LOCATION

SEE LP202454Y FOR FURTHER DETAILS AND BOUNDARIES

HISTORICAL REPRINT(S)

Volume 09666 Folio 202
63410357634X Page 1
Produced 11/12/1995 05:22 pm

LAND

LOT 1 on Plan of Subdivision 202454Y.
PARENT TITLE Volume 09204 Folio 391
Created by instrument LP202454Y 12/03/1986

REGISTERED PROPRIETOR

HISTORICAL SEARCH STATEMENT

Land Use Victoria

Page 3 of 6

ESTATE FEE SIMPLE

JOINT PROPRIETORS

MORRISS, JOHN ALAN; 6 LYNWOOD PLACE CASTLE HILL

MORRISS, SHERYL ANN; 6 LYNWOOD PLACE CASTLE HILL

Registered P203767T 19/05/1989

ENCUMBRANCES, CAVEATS AND NOTICES

MORTGAGES AND CHARGES IN PRIORITY RANKING

1 T065571P MORTGAGE

NATIONAL AUSTRALIA BANK LIMITED

COVENANT (as to whole or part of the land) in instrument P203767T 19/05/1989

SEE LP202454Y FOR FURTHER DETAILS AND BOUNDARIES

END OF CERTIFICATE

Volume 09666 Folio 202

81452346166X Page 1

Produced 12/06/1997 07:57 am

LAND

LOT 1 on Plan of Subdivision 202454Y.

PARENT TITLE Volume 09204 Folio 391

Created by instrument LP202454Y 12/03/1986

REGISTERED PROPRIETOR

ESTATE FEE SIMPLE

SOLE PROPRIETOR

FROLLEY, PAULINE MARGARET; 106 JUMPING CREEK RD. WONGA PARK 3115

Registered U808128G 05/06/1997

ENCUMBRANCES, CAVEATS AND NOTICES

MORTGAGES AND CHARGES IN PRIORITY RANKING

1 U808129D 05/06/1997 MORTGAGE

NATIONAL AUSTRALIA BANK LIMITED

COVENANT (as to whole or part of the land) in instrument P203767T 19/05/1989

SEE LP202454Y FOR FURTHER DETAILS AND BOUNDARIES

END OF CERTIFICATE

Paper Title Images

9666/202 - Version 0, Date 24/03/1999

ORIGINAL

NOT TO BE TAKEN FROM THE OFFICE OF TITLES



CONTINUED AS A COMPUTER FOLIO REGISTER BOOK

VOL. 9666 FOL. 202

Certificate of Title

UNDER THE "TRANSFER OF LAND ACT"

CHARLES EDWARD CLARKE and ELIZABETH JOY CLARKE both of Jumping Creek Road - - - - -
Wonga Park are JOINT PROPRIETORS of an estate in fee simple subject to the - - - - -
encumbrances notified hereunder in so much as lies above the depth of - - - - -
15.24 METRES below the surface of all that land in the Parish of Warrandyte - - - - -
County of Evelyn being Lot ① on Plan of Subdivision No. 202454Y - - - - -
which land is shown enclosed by continuous lines on the map hereon and - - - - -
identified by that lot number - - - - -

Issued under Regulation 10 -

Derived From
Vol. 9204 Fol. 391
12/3/'86

A Hamilton

Assistant Registrar of Titles



ENCUMBRANCES

MORTGAGE J200565 The - - -
Commercial Savings Bank -
of Australia Limited - - -
Registered 21/10/'80 -

MORTGAGE J200566 The - - -
Commercial Bank of - - -
Australia Limited - - -
Registered 21/10/'80 -

As to any part of the land
marked E-1 on the map that
lies within the - - - - -
above-mentioned Lot -

THE EASEMENTS (if any) - - -
existing over the same by -
virtue of Section 98 of --
the Transfer of Land Act -

AS TO THE WHOLE OF THE LAND

THE COVENANT CONTAINED IN
TRANSFER P203767T
REGISTERED 19/5/89



THE ABOVE MORTGAGE ~~SARE~~
DISCHARGED

79 11 1989



T09666-202-1-0

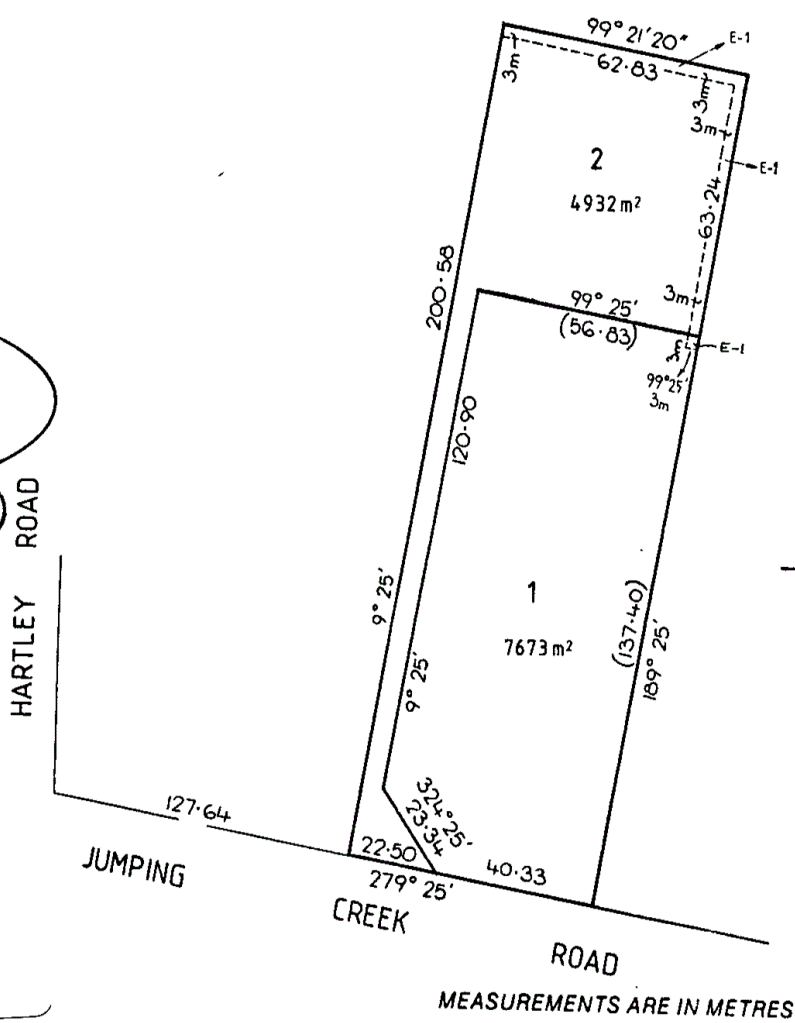

THE DIAGRAM CONTAINS

MEASUREMENTS ARE IN METRES

VOL. 9666 FOL. 202

P-1

JOINT PROPRIETORS

JOHN ALAN MORRISS & SHERYL ANN MORRISS

OF 6 LYNWOOD PL. CASTLE HILL

NEW SOUTH WALES

REGISTERED 19/5/89

P203767T



MORTGAGE

REPUBLIC

REPUBLIC NATIONAL BANK OF NEW YORK

(SINGAPORE) LIMITED

REGISTERED 19/5/89

P2037680

DISCHARGED
14 MAY 1991



M-4

MORTGAGE

Registered 14 MAY 1984

No. R339320

DISCHARGED
14 MAY 1984



MORTGAGE

NATIONAL AUSTRALIA BANK LIMITED

T65571P 4/5/94



20 JUL 1993

DATA VERIFIED
23 MAY 1994

CONTINUED AS A
COMPUTER FOLIO