

**HISTORICAL SEARCH STATEMENT**

**Land Use Victoria**

Produced 15/12/2024 08:51 AM

Volume 9786 Folio 394

Folio Creation: Created as paper folio continued as computer folio

Parent title Volume 08592 Folio 330

**RECORD OF HISTORICAL DEALINGS**

Date Lodged for Registration	Date Recorded on Register	Dealing	Imaged	Dealing Type and Details
26/04/1994	06/05/1994	T050433V	Y	TRANSFER AND LAPSING OF CAVEAT AIKMAN, SUZANNE LYNETTE AIKMAN, CLIVE LEONARD
26/04/1994	06/05/1994	T050433V	Y	TRANSFER AND LAPSING OF CAVEAT S019607R

**RECORD OF VOTS DEALINGS**

Date Lodged for Registration	Date Recorded on Register	Dealing	Imaged
21/04/2004	21/04/2004	AC808560S	Y

DISCHARGE OF MORTGAGE  
MORTGAGE(S) REMOVED  
L920765H  
R604162G

21/04/2004	21/04/2004	AC808561Q	Y
------------	------------	-----------	---

TRANSFER OF LAND BY ENDORSEMENT

FROM:

CLIVE LEONARD AIKMAN  
SUZANNE LYNETTE AIKMAN

TO:

SHANE RAYMOND FREEMAN  
LEANNE MARGARET FREEMAN

RESULTING PROPRIETORSHIP:

Estate Fee Simple

Joint Proprietors

SHANE RAYMOND FREEMAN

LEANNE MARGARET FREEMAN both of 18 HARTLEY ROAD WONGA PARK VIC 3115

AC808561Q 21/04/2004

21/04/2004	21/04/2004	AC808562N	Y
------------	------------	-----------	---

MORTGAGE OF LAND

MORTGAGE AC808562N 21/04/2004

GE MORTGAGE SOLUTIONS LIMITED

**HISTORICAL SEARCH STATEMENT**

**Land Use Victoria**

22/02/2006            22/02/2006            AE199057Y            Y

TRANSFER OF MORTGAGE  
MORTGAGE AC808562N 21/04/2004  
PERPETUAL TRUSTEE COMPANY LTD  
TRANSFER OF MORTGAGE AE199057Y 22/02/2006

15/05/2006            15/05/2006            AE353469S            Y

DISCHARGE OF MORTGAGE  
MORTGAGE(S) REMOVED  
AC808562N

15/05/2006            15/05/2006            AE353470J            Y

TRANSFER OF LAND BY ENDORSEMENT  
FROM:  
SHANE RAYMOND FREEMAN  
LEANNE MARGARET FREEMAN  
TO:  
LEANNE MARGARET FREEMAN

RESULTING PROPRIETORSHIP:  
Estate Fee Simple  
Sole Proprietor  
LEANNE MARGARET FREEMAN of 18 HARTLEY ROAD WONGA PARK VIC 3115  
AE353470J 15/05/2006

15/05/2006            15/05/2006            AE353471G            Y

MORTGAGE OF LAND  
MORTGAGE AE353471G 15/05/2006  
AUSTRALIA AND NEW ZEALAND BANKING GROUP LIMITED

29/10/2012            29/10/2012            AJ993787M (O)            Y

DISCHARGE OF MORTGAGE  
AFFECTED ENCUMBRANCE(S) AND REMOVED MORTGAGE(S)  
MORTGAGE AE353471G

28/04/2014            28/04/2014            AL040808G (O)            Y

TRANSFER OF LAND BY ENDORSEMENT  
FROM:  
LEANNE MARGARET FREEMAN  
TO:  
ANGELO JOHN LOMBARDO  
LEANNE MARGARET ATWOOD

RESULTING PROPRIETORSHIP:  
Estate Fee Simple  
TENANTS IN COMMON  
As to 1 of a total of 2 equal undivided shares  
Sole Proprietor  
ANGELO JOHN LOMBARDO of 18 HARTLEY ROAD WONGA PARK VIC 3115  
As to 1 of a total of 2 equal undivided shares  
Sole Proprietor  
LEANNE MARGARET ATWOOD of 18 HARTLEY ROAD WONGA PARK VIC 3115  
AL040808G 28/04/2014

STATEMENT END

**VOTS Snapshot**

Volume 09786 Folio 394  
124009953024Y  
Produced 21/04/2004 10:43 am

**LAND DESCRIPTION**

Lot 1 on Plan of Subdivision 209756T.  
PARENT TITLE Volume 08592 Folio 330  
Created by instrument LP209756T 23/12/1987

**REGISTERED PROPRIETOR**

Estate Fee Simple  
Joint Proprietors  
CLIVE LEONARD AIKMAN  
SUZANNE LYNETTE AIKMAN both of HARTLEY ROAD WONGA PARK 3115  
T050433V 26/04/1994

**ENCUMBRANCES, CAVEATS AND NOTICES**

MORTGAGE L920765H  
STATE BANK

MORTGAGE R604162G  
COMMONWEALTH BANK OF AUSTRALIA

Any encumbrances created by Section 98 Transfer of Land Act 1958 or Section 24 Subdivision Act 1988 and any other encumbrances shown or entered on the plan or imaged folio set out under DIAGRAM LOCATION below.

**DIAGRAM LOCATION**

SEE LP209756T FOR FURTHER DETAILS AND BOUNDARIES

**HISTORICAL REPRINT(S)**

Volume 09786 Folio 394  
51260717077N Page 1  
Produced 06/05/1994 09:53 am

**LAND**

Lot 1 on Plan of Subdivision 209756T.  
PARENT TITLE Volume 08592 Folio 330.  
Created by instrument LP209756T 23/12/1987

**REGISTERED PROPRIETOR**

ESTATE FEE SIMPLE

JOINT PROPRIETORS

AIKMAN, CLIVE LEONARD; HARTLEY ROAD WONGA PARK 3115

AIKMAN, SUZANNE LYNETTE; HARTLEY ROAD WONGA PARK 3115

Registered T050433V 26/04/1994

**ENCUMBRANCES, CAVEATS AND NOTICES**

MORTGAGES AND CHARGES IN PRIORITY RANKING

1 L920765H MORTGAGE

STATE BANK

2 R604162G MORTGAGE

COMMONWEALTH BANK OF AUSTRALIA

SEE LP209756T FOR FURTHER DETAILS AND BOUNDARIES

END OF CERTIFICATE

---

**Paper Title Images**

9786/394 - Version 0, Date 31/03/1999

REGISTER BOOK  
VOL. 9786 FOL. 394

**ORIGINAL**

**NOT TO BE TAKEN FROM THE OFFICE  
OF TITLES**



REGISTER BOOK

VOL. 9786 FOL. 394

# Certificate of Title

P-5

UNDER THE "TRANSFER OF LAND ACT"

CLIVE LEONARD AIKMAN of Hartley Road Wonga Park is the proprietor of an estate in fee simple subject to the encumbrances notified hereunder in all that land in the Parish of Warrandyte being Lot 1 on Plan of Subdivision No. 209756T which land is shown enclosed by continuous lines on the map hereon and identified by that lot number (being so much as lies above the depth of 15.24 METRES below the surface.)-

Issued under Regulation 10 -

Derived From  
Vol. 8592 Fol. 330

23/12/87

*M. Archer*



Assistant Registrar of Titles

### ENCUMBRANCES

**M-3** MORTGAGE L920765H-  
The Commissioners of the State Bank of Victoria-  
Registered 4/10/85-

As to any part of the land marked E-1 on the map that lies within the above-mentioned lot-  
**THE EASEMENTS** (if any) existing over the same by virtue of Section 98 of the Transfer of Land Act-

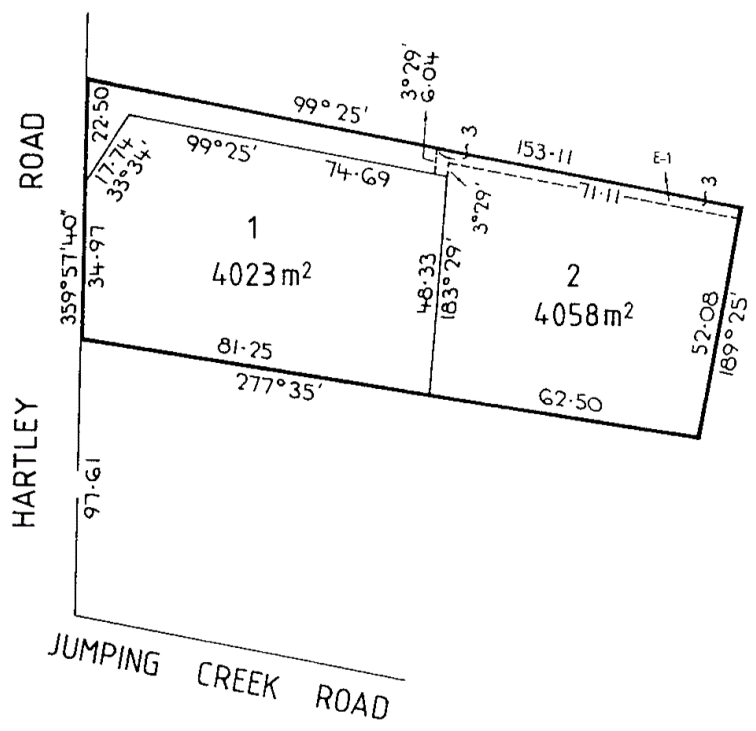

TEXT & DIAGRAM COVERED

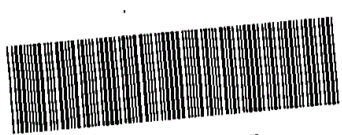

T09786-394-1-7

MEASUREMENTS ARE IN METRES

M-3

**MORTGAGE TO COMMONWEALTH  
BANK OF AUSTRALIA**

Registered 23 OCT 1991



No. R.604162 G

**A-N CAVEAT**

CAVEATOR: SUZANNE LYNETTE AIKMAN  
CAPACITY: FEE SIMPLE  
DATE OF CLAIM DOCUMENT: (SEE CAVEAT)  
LODGED BY: 1645T ROD TATCHELL & ASSOCIATES  
OF 7 MEADOWGATE DR. CHIRNSIDE PARK  
3116

NOTICE TO: AS ABOVE

NO: S19607R

DATE: 17/7/92



**DATA VERIFIED**  
**-4 SEP 1993**

CAVEAT WILL LAPSE ON  
REGISTRATION OF... T50433 ✓

CONTINUED AS A  
COMPUTER FOLIO

-6 MAY 1994

