

HISTORICAL SEARCH STATEMENT

Land Use Victoria

Produced 14/12/2024 03:53 PM

Volume 9841 Folio 594

Folio Creation: Created as paper folio continued as computer folio

Parent titles :

Volume 09726 Folio 957 to Volume 09726 Folio 958

RECORD OF HISTORICAL DEALINGS

Date Lodged for Registration	Date Recorded on Register	Dealing	Imaged	Dealing Type and Details
01/08/1996	12/08/1996	U338515U	N	DISCHARGE OF MORTGAGE P143067K
09/07/1998	21/07/1998	V516897N	N	DISCHARGE OF MORTGAGE P560746D
09/10/1998	10/11/1998	V685134G	Y	TRANSFER PEARCE, BEVERLEY JOAN
01/02/1999	16/02/1999	V867935U	Y	MORTGAGE AUSTRALIA AND NEW ZEALAND BANKING GROUP LIMITED
09/12/1999	22/12/1999	W456161C	Y	CAVEAT HANDS, RODNEY PETER HANDS, LISA JANE
24/02/2000	02/03/2000	W620575H	Y	DISCHARGE OF MORTGAGE V867935U
24/02/2000	02/03/2000	W620576E	Y	TRANSFER AND LAPSING OF CAVEAT RODNEY PETER & LISA JANE HANDS CAVEAT W456161C
24/02/2000	02/03/2000	W620577B	Y	MORTGAGE NATIONAL AUSTRALIA BANK LIMITED

RECORD OF VOTS DEALINGS

Date Lodged for Registration	Date Recorded on Register	Dealing	Imaged
02/03/2006	02/03/2006	AE217012D	Y

DISCHARGE OF MORTGAGE
MORTGAGE(S) REMOVED

HISTORICAL SEARCH STATEMENT

Land Use Victoria

W620577B

02/03/2006 02/03/2006 AE217013B Y

TRANSFER OF LAND BY ENDORSEMENT

FROM:

RODNEY PETER HANDS

LISA JANE HANDS

TO:

CHANTAL MARIE DENISE DAVIDSON

RESULTING PROPRIETORSHIP:

Estate Fee Simple

Sole Proprietor

CHANTAL MARIE DENISE DAVIDSON of 94 JUMPING CREEK ROAD WONGA PARK

VIC 3115

AE217013B 02/03/2006

14/06/2011 14/06/2011 AJ004302N (O) Y

MORTGAGE OF LAND

MORTGAGE AJ004302N 14/06/2011

COMMONWEALTH BANK OF AUSTRALIA

STATEMENT END

VOTS Snapshot

Volume 09841 Folio 594

124017055775S

Produced 02/03/2006 02:16 pm

LAND DESCRIPTION

Lot 1 on Plan of Subdivision 212773A.

PARENT TITLES :

Volume 09726 Folio 957 to Volume 09726 Folio 958

REGISTERED PROPRIETOR

Estate Fee Simple

Joint Proprietors

RODNEY PETER HANDS

LISA JANE HANDS both of 94 JUMPING CREEK RD. WONGA PARK 3115

W620576E 24/02/2000

ENCUMBRANCES, CAVEATS AND NOTICES

MORTGAGE W620577B 24/02/2000

NATIONAL AUSTRALIA BANK LIMITED

Any encumbrances created by Section 98 Transfer of Land Act 1958 or Section 24 Subdivision Act 1988 and any other encumbrances shown or entered on the plan or imaged folio set out under DIAGRAM LOCATION below.

DIAGRAM LOCATION

SEE LP212773A FOR FURTHER DETAILS AND BOUNDARIES

HISTORICAL REPRINT(S)

Volume 09841 Folio 594

70281384644D Page 1
Produced 07/02/1996 06:11 pm

LAND

LOT 1 on Plan of Subdivision 212773A.

PARENT TITLE(s):

Volume 09726 Folio 957 Volume 09726 Folio 958

REGISTERED PROPRIETOR

ESTATE FEE SIMPLE

JOINT PROPRIETORS

PEARCE, GEOFFREY RONALD; 94 JUMPING CREEK ROAD WONGA PARK 3115

PEARCE, BEVERLEY JOAN; 94 JUMPING CREEK ROAD WONGA PARK 3115

Registered P143066N

ENCUMBRANCES, CAVEATS AND NOTICES

MORTGAGES AND CHARGES IN PRIORITY RANKING

- 1 P143067K MORTGAGE
AUSTRALIA AND NEW ZEALAND SAVINGS BANK LIMITED
- 2 P560746D MORTGAGE
AUSTRALIA AND NEW ZEALAND BANKING GROUP LIMITED

SEE LP212773A FOR FURTHER DETAILS AND BOUNDARIES

END OF CERTIFICATE

Volume 09841 Folio 594

72250730387E Page 1
Produced 12/08/1996 03:26 pm

LAND

LOT 1 on Plan of Subdivision 212773A.

PARENT TITLE(s):

Volume 09726 Folio 957 Volume 09726 Folio 958

REGISTERED PROPRIETOR

ESTATE FEE SIMPLE

JOINT PROPRIETORS

PEARCE, GEOFFREY RONALD; 94 JUMPING CREEK ROAD WONGA PARK 3115

PEARCE, BEVERLEY JOAN; 94 JUMPING CREEK ROAD WONGA PARK 3115

Registered P143066N

ENCUMBRANCES, CAVEATS AND NOTICES

MORTGAGES AND CHARGES IN PRIORITY RANKING

1 P560746D MORTGAGE

AUSTRALIA AND NEW ZEALAND BANKING GROUP LIMITED

SEE LP212773A FOR FURTHER DETAILS AND BOUNDARIES

END OF CERTIFICATE

Volume 09841 Folio 594

91990862011V Page 1

Produced 21/07/1998 03:45 pm

LAND

LOT 1 on Plan of Subdivision 212773A.

PARENT TITLE(s):

Volume 09726 Folio 957 Volume 09726 Folio 958

REGISTERED PROPRIETOR

ESTATE FEE SIMPLE

JOINT PROPRIETORS

PEARCE, GEOFFREY RONALD; 94 JUMPING CREEK ROAD WONGA PARK 3115

PEARCE, BEVERLEY JOAN; 94 JUMPING CREEK ROAD WONGA PARK 3115

P143066N

ENCUMBRANCES, CAVEATS AND NOTICES

SEE LP212773A FOR FURTHER DETAILS AND BOUNDARIES

END OF CERTIFICATE

Volume 09841 Folio 594

93140710506A Page 1
Produced 10/11/1998 07:27 am

LAND

LOT 1 on Plan of Subdivision 212773A.

PARENT TITLE(s):

Volume 09726 Folio 957 Volume 09726 Folio 958

REGISTERED PROPRIETOR

ESTATE FEE SIMPLE

SOLE PROPRIETOR

PEARCE, BEVERLEY JOAN; 94 JUMPING CREEK RD. WONGA PARK 3115

V685134G 09/10/1998

ENCUMBRANCES, CAVEATS AND NOTICES

SEE LP212773A FOR FURTHER DETAILS AND BOUNDARIES

END OF CERTIFICATE

HISTORICAL SEARCH STATEMENT

Land Use Victoria

Page 6 of 11

Volume 09841 Folio 594

00470666082H Page 1
Produced 16/02/1999 11:12 am

LAND

LOT 1 on Plan of Subdivision 212773A.

PARENT TITLE(s):

Volume 09726 Folio 957 Volume 09726 Folio 958

REGISTERED PROPRIETOR

ESTATE FEE SIMPLE

SOLE PROPRIETOR

PEARCE, BEVERLEY JOAN; 94 JUMPING CREEK RD. WONGA PARK 3115
V685134G 09/10/1998

ENCUMBRANCES, CAVEATS AND NOTICES

MORTGAGES AND CHARGES IN PRIORITY RANKING

1 V867935U 01/02/1999 MORTGAGE
AUSTRALIA AND NEW ZEALAND BANKING GROUP LIMITED

SEE LP212773A FOR FURTHER DETAILS AND BOUNDARIES

END OF CERTIFICATE

Volume 09841 Folio 594

03560715639P Page 1
Produced 22/12/1999 10:59 am

LAND

HISTORICAL SEARCH STATEMENT

Land Use Victoria

LOT 1 on Plan of Subdivision 212773A.
PARENT TITLE(s):
Volume 09726 Folio 957 Volume 09726 Folio 958

REGISTERED PROPRIETOR

ESTATE FEE SIMPLE
SOLE PROPRIETOR
PEARCE, BEVERLEY JOAN; 94 JUMPING CREEK RD. WONGA PARK 3115
V685134G 09/10/1998

ENCUMBRANCES, CAVEATS AND NOTICES

MORTGAGES AND CHARGES IN PRIORITY RANKING
1 V867935U 01/02/1999 MORTGAGE
AUSTRALIA AND NEW ZEALAND BANKING GROUP LIMITED

CAVEAT W456161C 09/12/1999
Caveator
HANDS, RODNEY PETER
HANDS, LISA JANE
Capacity PURCHASER
Lodged by
METROPOLITAN SOLICITORS
Notices to
METROPOLITAN SOLICITORS; 3B/426 BURWOOD HY. WANTIRNA 3152

SEE LP212773A FOR FURTHER DETAILS AND BOUNDARIES

END OF CERTIFICATE

Volume 09841 Folio 594
10620678566S Page 1
Produced 02/03/2000 03:24 pm

LAND

LOT 1 on Plan of Subdivision 212773A.
PARENT TITLE(s):
Volume 09726 Folio 957 Volume 09726 Folio 958

REGISTERED PROPRIETOR

ESTATE FEE SIMPLE

HISTORICAL SEARCH STATEMENT

Land Use Victoria

Page 8 of 11

JOINT PROPRIETORS

HANDS, RODNEY PETER; 94 JUMPING CREEK RD. WONGA PARK 3115
HANDS, LISA JANE; 94 JUMPING CREEK RD. WONGA PARK 3115
W620576E 24/02/2000

ENCUMBRANCES, CAVEATS AND NOTICES

SEE LP212773A FOR FURTHER DETAILS AND BOUNDARIES

END OF CERTIFICATE

Volume 09841 Folio 594

10620680058V Page 1
Produced 02/03/2000 04:04 pm

LAND

LOT 1 on Plan of Subdivision 212773A.

PARENT TITLE(s):

Volume 09726 Folio 957 Volume 09726 Folio 958

REGISTERED PROPRIETOR

ESTATE FEE SIMPLE

JOINT PROPRIETORS

HANDS, RODNEY PETER; 94 JUMPING CREEK RD. WONGA PARK 3115
HANDS, LISA JANE; 94 JUMPING CREEK RD. WONGA PARK 3115
W620576E 24/02/2000

ENCUMBRANCES, CAVEATS AND NOTICES

MORTGAGES AND CHARGES IN PRIORITY RANKING

1 W620577B 24/02/2000 MORTGAGE
NATIONAL AUSTRALIA BANK LIMITED

SEE LP212773A FOR FURTHER DETAILS AND BOUNDARIES

END OF CERTIFICATE

Paper Title Images



Copyright State of Victoria. No part of this publication may be reproduced except as permitted by the Copyright Act 1968 (Cth), to comply with a statutory requirement or pursuant to a written agreement. The information is only valid at the time and in the form obtained from the LANDATA REGD TM System. None of the State of Victoria, its agents or contractors, accepts responsibility for any subsequent publication or reproduction of the information.

The Victorian Government acknowledges the Traditional Owners of Victoria and pays respects to their ongoing connection to their Country, History and Culture. The Victorian Government extends this respect to their Elders, past, present and emerging.

HISTORICAL SEARCH STATEMENT

Land Use Victoria

Page 9 of 11

9841/594 - Version 0, Date 07/04/1999

CONTINUED AS A
COMPUTER FOLIO

ORIGINAL

**NOT TO BE TAKEN FROM THE OFFICE
OF TITLES**



REGISTER BOOK

VOL 9841 FOL 594

Certificate of Title

UNDER THE "TRANSFER OF LAND ACT"

SUSAN ANN LE FEVRE of 92 Jumping Creek Road Wonga Park is the proprietor of an estate in fee simple subject to the encumbrances notified hereunder in all that land in the Parish of Warrandyte being Lot 1 on Plan of Subdivision No. 212773A which land is shown enclosed by continuous lines on the map hereon and identified by that lot number (being so much as lies above the depth of 15.24 METRES below the surface.)-

Issued under Regulation 10 -
Derived From
Vol. 9726 Fols. 957 and 958
27/10/88

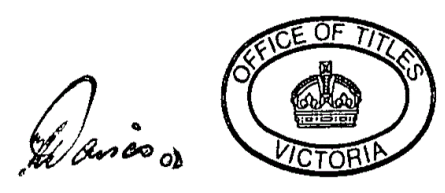

Assistant Registrar of Titles

ENCUMBRANCES

As to any part of the land marked E-1 or E-2 on the map that lies within the above-mentioned lot-
THE EASEMENTS (if any) existing over the same by virtue of Section 98 of the Transfer of Land Act-

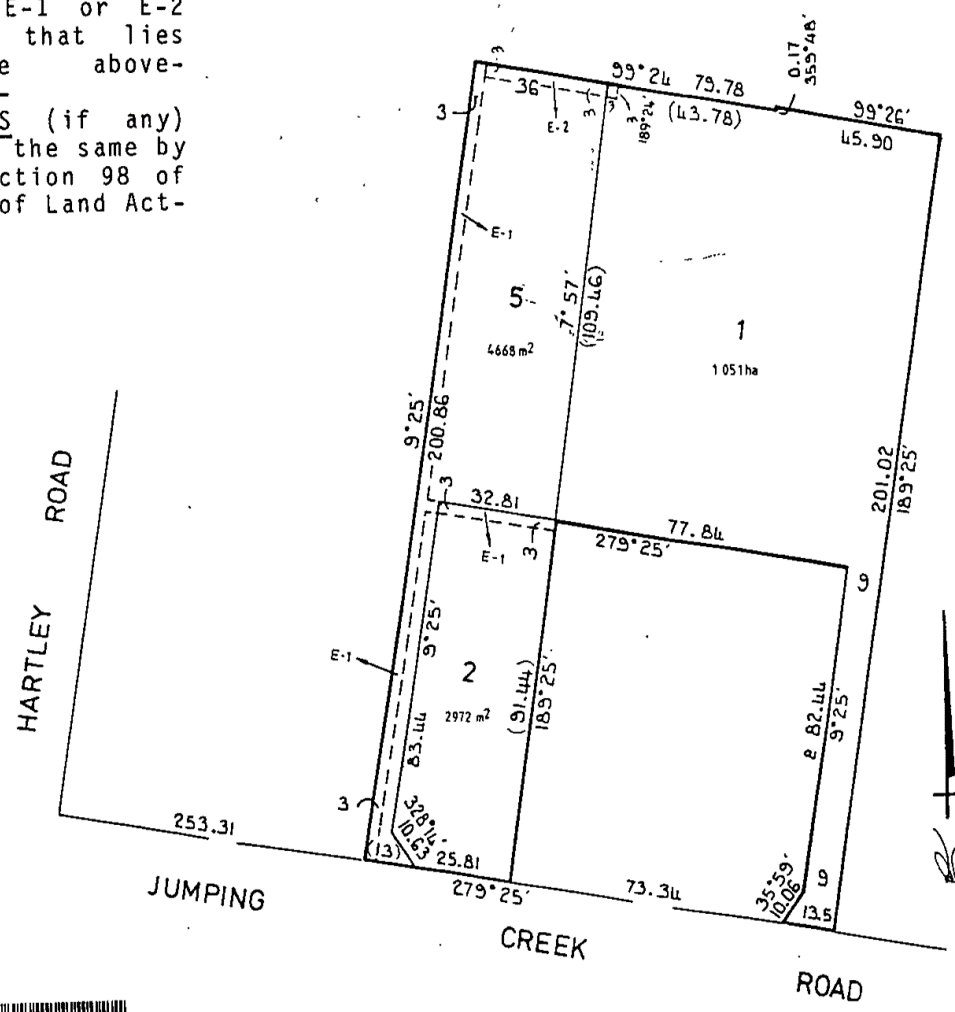

TEXT & DIAGRAM CONVERTED



T09841-594-1-2

MEASUREMENTS ARE IN METRES

CAVEAT

CAVEATOR: GEOFFREY RONALD PEARCE & BEVERLEY
JOAN PEARCE

CAPACITY: PURCHASER/FEE SIMPLE

LODGED BY: 2241P A.J. MAHON & ASSOCIATES OF
25 RAILWAY RD. BLACKBURN 3130

NOTICE TO: AS ABOVE

NO: N968982V

DATE: 23/1/89

CAVEAT WILL LAPSE ON
REGISTRATION OF P143066 D

11 MAY 1989

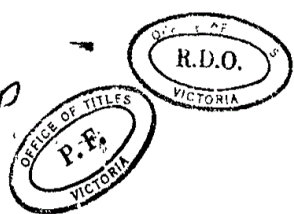

P-J

JOINT PROPRIETORS
GEOFFREY RONALD PEARCE & BEVERLEY JOAN
PEARCE OF 94 JUMPING CREEK RD. WONGA PARK
REGISTERED 20/4/89

P143066N



M-2

MORTGAGE

AUSTRALIA AND NEW ZEALAND SAVINGS BANK
LIMITED

REGISTERED 20/4/89

P143067K



M-1

MORTGAGE TO AUSTRALIA AND NEW ZEALAND
BANKING GROUP LTD

Registered -7 DEC 1989

No. P560746D



DATA VERIFIED
- 9 NOV 1989

CONTINUED AS A
COMPUTER FOLIO