



Imaged Document Cover Sheet

The document following this cover sheet is an imaged document supplied by LANDATA®, Secure Electronic Registries Victoria.

Document Type	Cancelled Title
Document Identification	3607/326
Number of Pages (excluding this cover sheet)	4
Document Assembled	03/01/2025 09:56

Copyright and disclaimer notice:

© State of Victoria. This publication is copyright and includes confidential information. No part may be reproduced by any process except in accordance with the provisions of the Copyright Act or pursuant to a written agreement. The State of Victoria does not warrant the accuracy or completeness of the information in this publication and any person using or relying upon such information does so on the basis that the State of Victoria shall bear no responsibility or liability whatsoever for any errors, faults, defects or omissions in the information.

The document is invalid if this cover sheet is removed or altered.

CANCELLED
Entered in the Register-Book,

Vol. 3607 Fol. 721326



5 JHS

Certificate of Title,

UNDER THE "TRANSFER OF LAND ACT 1890."

JHS

WILLIAM HUNTER of Wearing Street Footscray Manager is -----
now the proprietor of an Estate in Fee-simple, subject to the Encumbrances
notified hereunder in All that piece of Land, delineated and coloured
red on the map in the margin containing Fifteen acres Three roods and Thirty perches
or thereabouts being part of Lot 67 on Plan of Subdivision No. 4315 lodged in the Office
of Titles and being part of Crown Allotments Eleven^A and Eleven^B and part of a former -
Government Road Parish of Warrandyte County of Evelyn -----

ORIGINAL CERTIFICATE.
Not to be dealt with outside the Titles Office.

Dated the Eighteenth
thousand nine hundred and twelve.

day of June

Assistant Registrar of Titles

ENCUMBRANCES REFERRED TO.

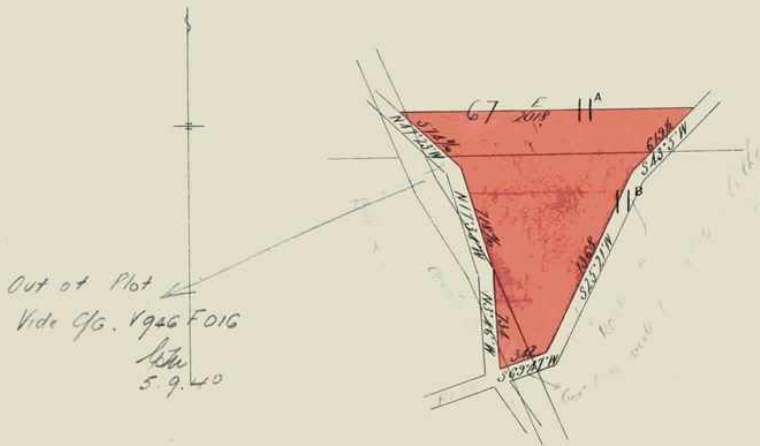

15-7-30
E-2-3-40



T03607-326-1-2

W.H.S.
The Measurements are Links
5/10

Delivered on-line by LANDATA®
This document provides an image of a cancelled folio of the Register. It is not a statement from the register of subsisting information in relation to the land to which it refers.
WARNING

Vol. 3304 Fol. 660741

Transfer.

Application

R. I. No. 1527044

Nature of Instrument	Day and Hour of its Production	Names of the Parties to it.	Number or Symbol of Person.
<p><i>James Edward Hooper of Yarra Road</i> <i>crocyden farmer is</i> <i>now the proprietor of the within-described estate and land pursuant to a</i> <i>transfer from within named William Hunter</i> <i>registered on the 11th day of February 1941 at 10 o'clock in the</i> <i>afternoon and numbered 737481</i></p> <p><i>J. Holmby</i> <i>Assistant Registrar of Titles.</i></p>			

TRANSFER AS TO PART to
David John Hooper
 on *28 May 1940*
 CANCELLED AS TO PART See Certificate of Title
 Vol. 6399 Fol. 1279734
J. Holmby
 Assistant Registrar of Titles

Assistant Registrar of Titles.

TRANSFER AS TO BALANCE to
Florence Hannah Isabel Hooper
 on *28 May 1940*
 CANCELLED See Certificate of Title
 Vol. 6399 Fol. 1279735
J. Holmby
 Assistant Registrar of Titles

Assistant Registrar of Titles.

✓ CANCELLED

OCT 1940

Assistant Registrar of Titles.

Assistant Registrar of Titles.

Assistant Registrar of Titles.

Delivered on-line by LANDATA®. This document provides an image of a cancelled folio of the Register. It is not a statement from the register of subsisting information in relation to the land to which it refers.

WARNING

SCALE: *8 Chains* to one inch.

Vol. 3607 fol. 326
Vol. 3607 fol. 325

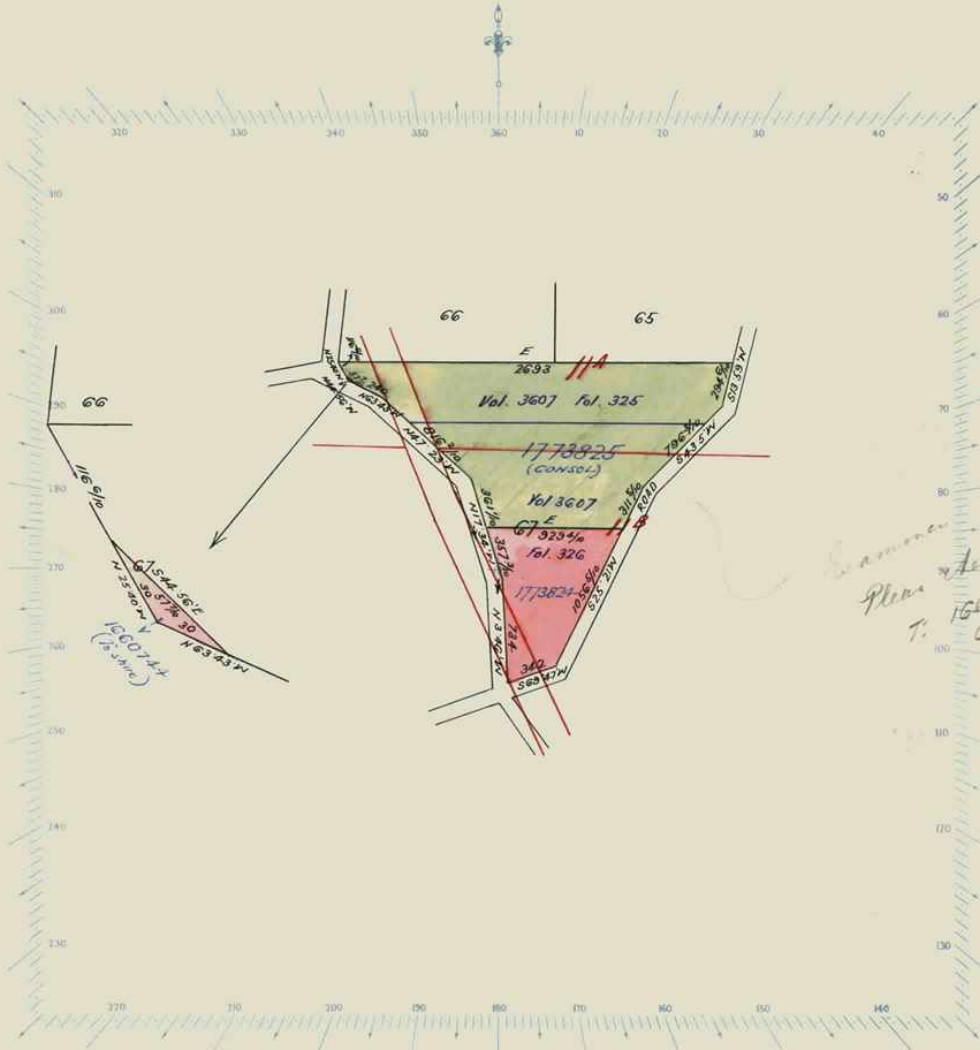

*See memo
Please refer to
T. 1660744
Ch. 3607-325*

*1055-3
311-3
16570
Crg 5
176
742-3*

Delivered on-line by LANDATA®. This document provides an image of a cancelled folio of the Register. It is not a statement from the register of subsisting information in relation to the land to which it refers.

WARNING



T03607-326-2-1

Handwritten mark

Delivered
on-line by
LANDATA®

WARNING
This document provides an image of a cancelled page of the Register. It is not a statement
from the register of subsisting information in relation to the land to which it refers.

Natural Resources and Environment
REGULATORY • REGULATED • CONSERVATION • LAND MANAGEMENT

INTENTIONALLY
BLANK