



# Imaged Document Cover Sheet

The document following this cover sheet is an imaged document supplied by LANDATA®, Secure Electronic Registries Victoria.

Document Type	<b>Cancelled Title</b>
Document Identification	<b>8956/469</b>
Number of Pages (excluding this cover sheet)	<b>4</b>
Document Assembled	<b>05/02/2025 19:50</b>

**Copyright and disclaimer notice:**

© State of Victoria. This publication is copyright and includes confidential information. No part may be reproduced by any process except in accordance with the provisions of the Copyright Act or pursuant to a written agreement. The State of Victoria does not warrant the accuracy or completeness of the information in this publication and any person using or relying upon such information does so on the basis that the State of Victoria shall bear no responsibility or liability whatsoever for any errors, faults, defects or omissions in the information.

The document is invalid if this cover sheet is removed or altered.

**CANCELLED**

REGISTER BOOK

VOL. **8956** FOL. **469**

**ORIGINAL**

**NOT TO BE TAKEN FROM THE OFFICE OF TITLES**



VICTORIA

# Certificate of Title

UNDER THE "TRANSFER OF LAND ACT"

VOL. **8956** FOL. **469**

DONALD STEWART MCKEE Technical Representative and JEAN MARGARET-MCKEE Married Woman both of 7 Angle Road Balwyn are joint --- proprietors of an estate in fee simple subject to the encumbrances -- notified hereunder in ALL THAT piece of land coloured on the map --- on the sheet annexed hereto being Lot 1 on Plan of Subdivision ---- No.96392 Parish of Warrandyte County of Evelyn - - -

Delivered on-line by LANDATA®

Issued under Regulation 12 on the approval of the --- above Plan of Subdivision-

*Johnnie*



Assistant Registrar of Titles

ENCUMBRANCES REFERRED TO

MORTGAGE E.175883 ---

As to any land coloured blue

THE EASEMENTS (if any) existing over the -- same by virtue of Section 98 of the - - - Transfer of Land Act -

*The above mortgage is discharged as to part being the within Land*

**1 DEC 1974**



WARNING  
This document provides an image of a cancelled folio of the Register. It is not a statement from the register of subsisting information in relation to the land to which it refers.

THE WHOLE/OR PART OF THE WITHIN LAND HAS BEEN SUBDIVIDED SEE Unregistered Plan **114448** Misc. Plan **114448** L.P. ---

DERIVED FROM VOL.8134 FOL.504 20/12/'72.

**SEE SKETCH ATTACHED TO C/T V.8956 F.470**

**CANCELLED**

Pursuant to Regulation 12 and Titles  
issued as set out hereunder

on 15<sup>TH</sup> MAY 1975  
Lots 5 to 9 in Vo 9084 Fol 813  
to Vo 9084 Fol 817

LP. 114448



**CANCELLED**

9084 - 817



*E. Harris*  
ASSISTANT REGISTRAR OF TITLES

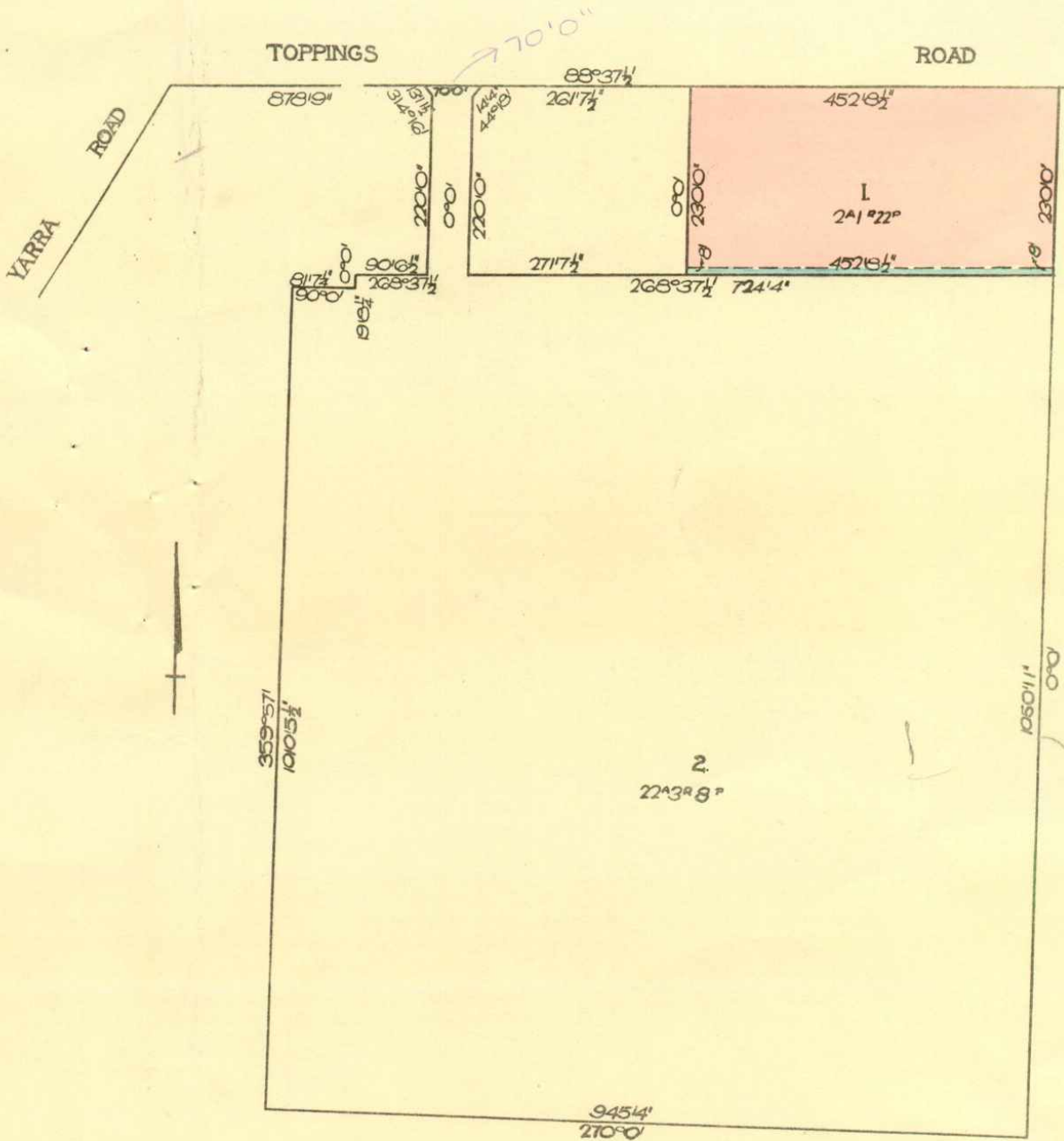

MEASUREMENTS ARE IN  
FEET AND INCHES

*W.S.*

Delivered  
on-line by  
LANDATA®

WARNING

This document provides an image of a cancelled folio of the Register. It is not a statement from the register of subsisting information in relation to the land to which it refers.

 **Natural Resources and Environment**  
AGRICULTURE • RESOURCES • CONSERVATION • LAND MANAGEMENT

**INTENTIONALLY  
BLANK**

Offline By LANDATA® This document provides an image of a scanned file of this document. It is not an original document. From the report of the scanning, no changes were made to the scan to which it is a scan.

