

**HISTORICAL SEARCH STATEMENT**

**Land Use Victoria**

Produced 05/02/2025 09:56 PM

Volume 9349 Folio 263

Folio Creation: Created as paper folio continued as computer folio

Parent title Volume 08956 Folio 470

THE IMAGE OF THE FOLIO CEASED TO BE THE DIAGRAM LOCATION ON 16/05/2003 05:13:46 AM

**RECORD OF HISTORICAL DEALINGS**

Date Lodged for Registration	Date Recorded on Register	Dealing	Imaged	Dealing Type and Details
------------------------------	---------------------------	---------	--------	--------------------------

**RECORD OF VOTS DEALINGS**

Date Lodged for Registration	Date Recorded on Register	Dealing	Imaged
09/08/2006	09/08/2006	AE533437E	Y

**SURVIVORSHIP APPLICATION**

FROM:

GAVIN FREDERICK HICKLING

LYNDA FLORENCE HICKLING

TO:

LYNDA FLORENCE HICKLING

**RESULTING PROPRIETORSHIP:**

Estate Fee Simple

Sole Proprietor

LYNDA FLORENCE HICKLING of 22 TOPPINGS ROAD WONGA PARK 3115

AE533437E 09/08/2006

STATEMENT END

**VOTS Snapshot**

Volume 09349 Folio 263

124018718764V

Produced 09/08/2006 10:06 am

**LAND DESCRIPTION**

Lot 13 on Plan of Subdivision 124963.

PARENT TITLE Volume 08956 Folio 470

Created by instrument LP124963 08/10/1979

**REGISTERED PROPRIETOR**

Estate Fee Simple

## **HISTORICAL SEARCH STATEMENT**

## **Land Use Victoria**

Page 2 of 4

Joint Proprietors

GAVIN FREDERICK HICKLING

LYNDA FLORENCE HICKLING both of TOPPINGS ROAD WONGA PARK

H898445 11/03/1980

## **ENCUMBRANCES, CAVEATS AND NOTICES**

COVENANT H898445 28/11/2001

Any encumbrances created by Section 98 Transfer of Land Act 1958 or Section 24 Subdivision Act 1988 and any other encumbrances shown or entered on the plan or imaged folio set out under DIAGRAM LOCATION below.

## **DIAGRAM LOCATION**

SEE TP626402B FOR FURTHER DETAILS AND BOUNDARIES

---

## **Paper Title Images**

9349/263 - Version 0, Date 25/09/1999

ORIGINAL

NOT TO BE TAKEN FROM THE OFFICE OF TITLES



REGISTER BOOK

VOL. 9349 FOL. 263

# Certificate of Title

UNDER THE "TRANSFER OF LAND ACT"

DONALD STEWART McKEE Technical Representative and JEAN MARGARET - - -  
 McKEE Married Woman both of 34 Maitland Avenue East Kew are - - -  
 joint proprietors of an estate in fee simple subject to the - - - - -  
 encumbrances notified hereunder in ALL THAT piece of land coloured on - - - -  
 the map hereon being Lot 13 on Plan of Subdivision No.124963 - - - - -  
 Parish of Warrandyte County of Evelyn - - - - -

Issued under Regulation 12 on the approval  
 of the above Plan of Subdivision -

DERIVED FROM  
 VOL.8956 FOL.470  
 8/10/'79

*B.T. Jones*



Assistant Registrar of Titles

ENCUMBRANCES REFERRED TO  
 As to any land coloured blue -

THE EASEMENTS (if any) existing over  
 the same by virtue of Section 98 of  
 the Transfer of Land Act -

As to the whole of the land - - -

THE COVENANT contained in - - - -  
 Transfer H898445 - - - - -  
 Registered 11th March 1980-

A Drainage Easement appurtenant to  
 the within land has been created by  
 Instrument H727683  
 Registered 17th October 1979

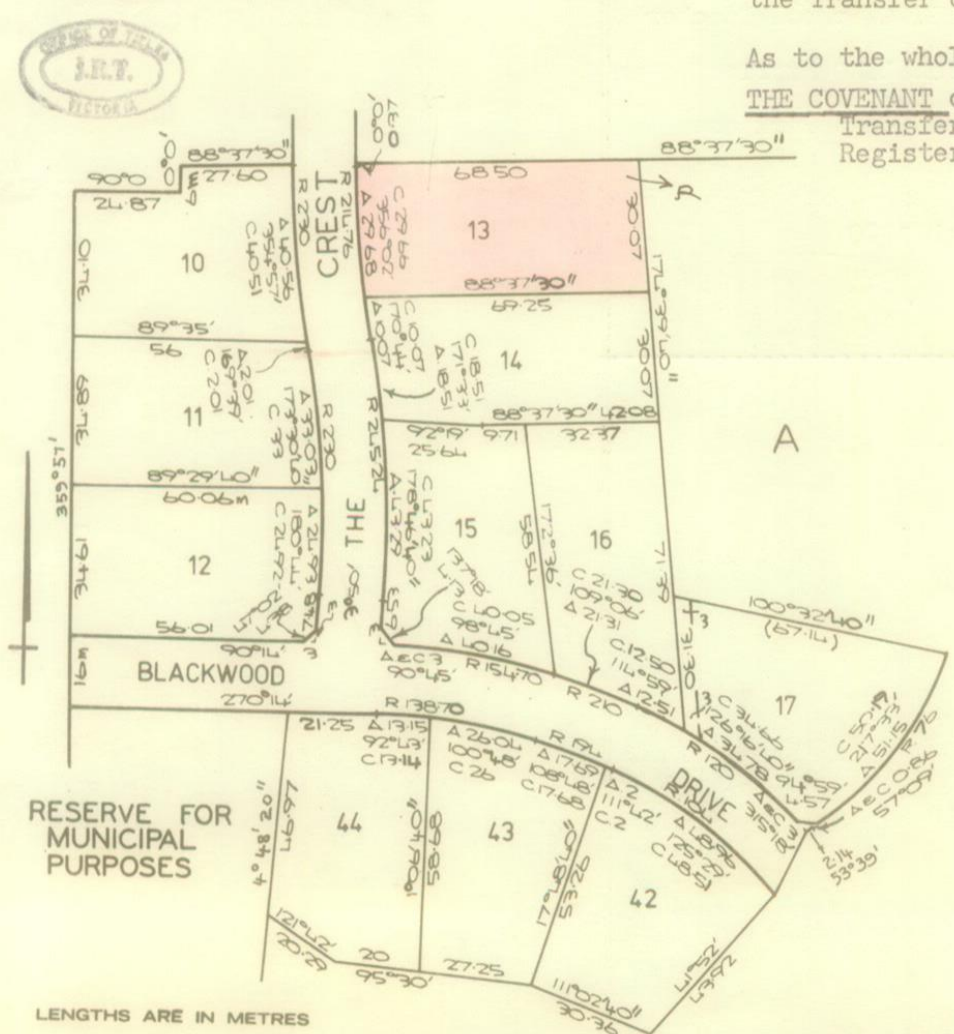

*DM*

~~GAVIN FREDERICK HICKLING School Teacher  
 and LYNDA FLORENCE HICKLING Married Woman  
 both of Toppings Road Wonga Park are  
 now JOINT PROPRIETORS  
 Registered 11th March 1980  
 No. H898445~~

**Endorsement Made in Error**

*14.4.80*

J. & D. McKEE PTY. LTD. of 34 Maitland Avenue  
 East Kew is now the proprietor  
 Registered 11th March 1980  
 No. H898443



GAVIN FREDERICK HICKLING School Teacher  
 and LYNDA FLORENCE HICKLING Married Woman  
 both of Toppings Road Wonga Park are  
 now JOINT PROPRIETORS  
 Registered 11th March 1980  
 No. H898445

