



Imaged Document Cover Sheet

The document following this cover sheet is an imaged document supplied by LANDATA®, Secure Electronic Registries Victoria.

Document Type	Cancelled Title
Document Identification	9001/074
Number of Pages (excluding this cover sheet)	2
Document Assembled	05/02/2025 14:40

Copyright and disclaimer notice:

© State of Victoria. This publication is copyright and includes confidential information. No part may be reproduced by any process except in accordance with the provisions of the Copyright Act or pursuant to a written agreement. The State of Victoria does not warrant the accuracy or completeness of the information in this publication and any person using or relying upon such information does so on the basis that the State of Victoria shall bear no responsibility or liability whatsoever for any errors, faults, defects or omissions in the information.

The document is invalid if this cover sheet is removed or altered.

ORIGINAL

NOT TO BE TAKEN FROM THE OFFICE OF TITLES



VICTORIA

CANCELLED REGISTER BOOK

VOL. 9001 FOL. 074

Certificate of Title

UNDER THE "TRANSFER OF LAND ACT"

HERBERT NEWTON READ of Toppings Road Wonga Park
 Orchardist is the proprietor of an estate in fee simple
 subject to the encumbrances notified hereunder in ALL THAT
 piece of land coloured on the map hereon being Lot 3 on
 Plan of Subdivision No. 99557 Parish of Warrandyte
 County of Evelyn

Issued under Regulation 12
 on the approval of the
 above Plan of Subdivision-

Edwards



Assistant Registrar of Titles

ENCUMBRANCES REFERRED TO

As to any land coloured blue

THE EASEMENTS (if any) existing over the same by virtue of Section 98 of the Transfer of Land Act

PLAN 3299/3T AFFECTS LAND HEREIN

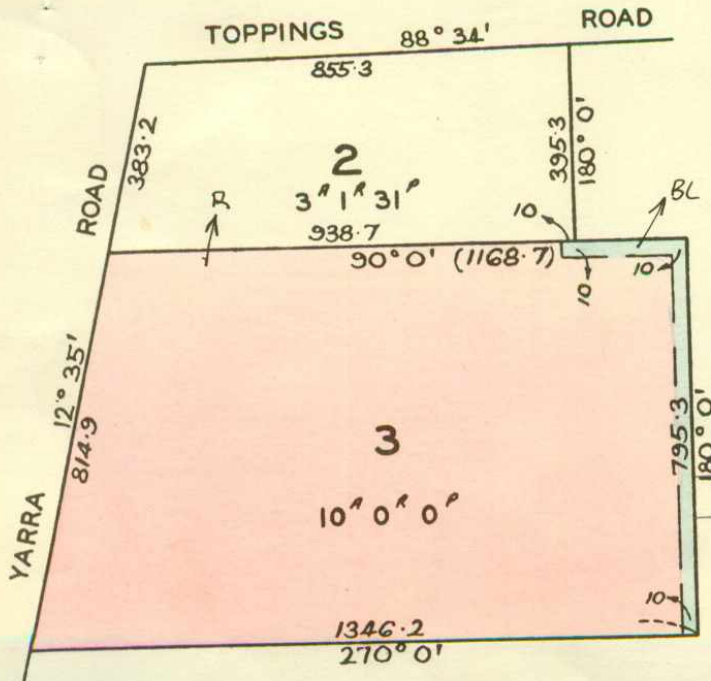

MEASUREMENTS ARE IN LINKS

DERIVED FROM VOL. 8726 FOL. 550 3/12/'73.

Delivered on-line by LANDATA®

WARNING This document provides an image of a cancelled folio of the Register. It is not a statement from the register of subsisting information in relation to the land to which it refers.

WARNING



llp

DELTA ENTERPRISES PTY. LTD. of 2 Woodland Avenue Croydon is now the proprietor Registered 4th September 1984 No.L241653N



MORTGAGE TO AUSTRALIA AND NEW ZEALAND BANKING GROUP LIMITED

Registered 21 DEC 1988

No. N202967J

DISCHARGED 18 MAY 1990



MORTGAGE TO COMMONWEALTH BANK OF AUSTRALIA

Registered 25 SEP 1988

No. R17899H

DISCHARGED 18 JAN 1994



MORTGAGE TO AUSTRALIA AND NEW ZEALAND BANKING GROUP LIMITED

Registered 30 JUL 1988

No. N40533H

DISCHARGED 18 JAN 1994



PROPRIETOR SOUFFI PTY. LTD. 398-424 HAMMOND RD. DANDENONG 3175 5888933J 18/1/94



CANCELLED as to Part PURSUANT TO SECTION 24 SUBDIVISION ACT 1988

REGISTERED. 20 JUL 1994

No. P5329912V



one to 4 in Vol 10177 Fol 729 to Vol 10179 Fol 732

CANCELLED as to Balance PURSUANT TO SECTION 24 SUBDIVISION ACT 1988

REGISTERED. 21-7-94

No. P5329913T



CANCELLED



T09001-074-1-9

V.9001 F.074

WARNING: This document provides a range of a cancelled folio of the register. It is not a statement on-line by LANDATA from the register of land in Victoria to which it refers.