

HISTORICAL SEARCH STATEMENT

Land Use Victoria

Produced 17/02/2025 09:05 AM

Volume 8133 Folio 948

Folio Creation: Created as paper folio continued as computer folio

Parent title Volume 04977 Folio 361

THE IMAGE OF THE FOLIO CEASED TO BE THE DIAGRAM LOCATION ON 04/09/2002 05:01:24 AM

RECORD OF HISTORICAL DEALINGS

Date Lodged for Registration	Date Recorded on Register	Dealing	Imaged	Dealing Type and Details
------------------------------	---------------------------	---------	--------	--------------------------

RECORD OF VOTS DEALINGS

Date Lodged for Registration	Date Recorded on Register	Dealing	Imaged
------------------------------	---------------------------	---------	--------

19/12/2003	06/01/2004	PS518021F	Y
------------	------------	-----------	---

PLAN OF SUBDIVISION, SUBDIVISION ACT 1988
Cancelled by PS518021F

STATEMENT END

VOTS Snapshot

Volume 08133 Folio 948
124008742773P
Produced 06/01/2004 10:23 am

LAND DESCRIPTION

Lot 1 on Title Plan 257740K (formerly known as part of Lot 45 on Plan of Subdivision 004315).

PARENT TITLE Volume 04977 Folio 361

Created by instrument A250430 13/11/1956

REGISTERED PROPRIETOR

Estate Fee Simple

Joint Proprietors

PHILLIP SCOTT ARROWSMITH

JANELLE KRISTEN ARROWSMITH both of 8 VENETIAN CT CROYDON 3136

T889394V 29/09/1995

ENCUMBRANCES, CAVEATS AND NOTICES

MORTGAGE T889395S 29/09/1995

NATIONAL AUSTRALIA BANK LIMITED

Any encumbrances created by Section 98 Transfer of Land Act 1958 or Section 24 Subdivision Act 1988 and any other encumbrances shown or entered on the plan set out under DIAGRAM LOCATION below.

DIAGRAM LOCATION

SEE TP257740K FOR FURTHER DETAILS AND BOUNDARIES

Paper Title Images

8133/948 - Version 0, Date 25/10/1999

ORIGINAL
NOT TO BE TAKEN FROM
THE OFFICE OF TITLES



Entered in the Register Book

Vol. 8133 Fol. 948

VICTORIA

Certificate of Title

UNDER THE "TRANSFER OF LAND ACT 1954"

16/5/57.

John Flavell Hull of Brysons Road Wonga Park Gentleman is -----
 now the proprietor -----
 of an Estate in Fee-simple subject to the Encumbrances notified hereunder in
 All that piece of Land, delineated and coloured red on the map in the ----
 margin being part of Lot 45 on Plan of Subdivision No.4315 lodged in the Office of-
 Titles and being part of Crown Allotment Eleven^B Parish of Warrandyte County of-
 Evelyn - Together with a right to use the land coloured yellow on the said map --
 for drainage purposes -----

Dated the Thirteenth day of November One
 thousand nine hundred and fifty-six.

D Jones

Assistant Registrar of Titles



ENCUMBRANCES REFERRED TO

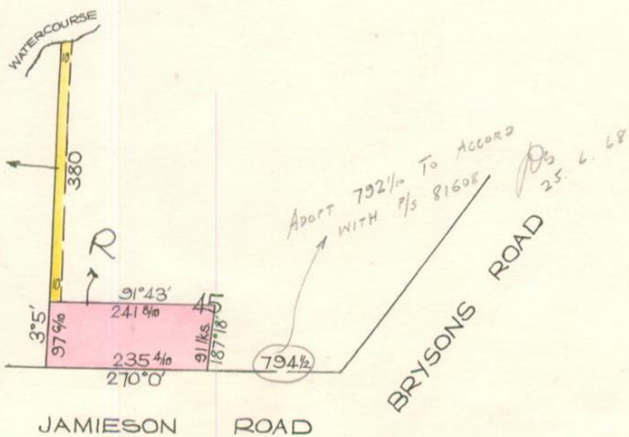

THE MEASUREMENTS ARE IN LINKS

JOINT PROPRIETORS
KENNETH SAMUEL JOHN JAMISON & ROBIN GAIL
JAMISON OF 23 PAYNTERS RD. WONGA PARK
REGISTERED 9/6/87
M880063F

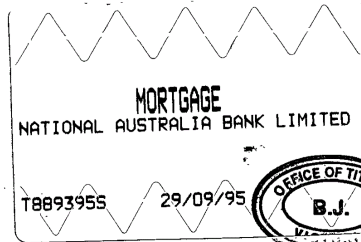

MORTGAGE TO COMMONWEALTH BANK OF AUSTRALIA

Registered 29 JUL 1989
No. N608181
EXCHARGE 11 DEC 1989



CAVEAT

CAVEATOR: JOHN EDWARD SNOWDEN & IVY MARY SNOWDEN
CAPACITY: PURCHASER/FEE SIMPLE
LODGED BY: 0500C ARNOLD BLOCH LEIBLER OF 380
LONSDALE ST. MELBOURNE 3000
NOTICE TO: AS ABOVE
NO: P427401W
DATE: 14/9/89



~~CAVEAT WILL LAPSE ON
REGISTRATION OF P566524Q
14 DEC 1989~~



JOINT PROPRIETORS
JOHN EDWARD SNOWDEN & IVY MARY SNOWDEN OF JAMIESON
RD. WONGA PARK
REGISTERED 11/12/89
P566524Q

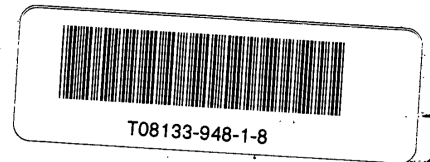
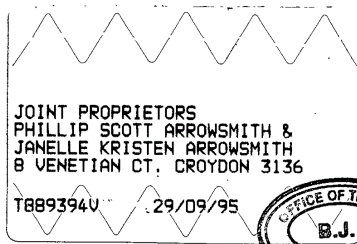
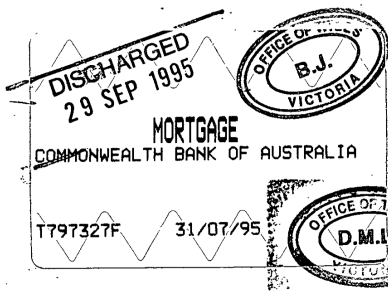

8133 F.948