

Lengths of Lines
and
Curves.

Index.

	Page		Page	
Victoria Bridge Extension	3.	3	Caulfield Loop	61-63
Barkers R ^d . High S ^t & Coltham R ^d		5	Glen Huntly Road	67-69-71-73.
Victoria Bridge to Strathalbyn S ^t & Mont Albert		7	Hawthorn Road. South	81
Strathalbyn S ^t to Depots		9	Commercial Road	85-87.
Cemetery (Kew) to Victoria Bridge		11	Malvern Road.	87-89-93-95.
Crossover Coltham R ^d to Esplanade & Deepdene		13	High S ^t to Punt Road.	97
Deepdene to Esplanade - Victoria Bridge & Depots		15	High S ^t	99-101-105-107.
Glenferrie Road.		5. 17-19. 21. 109	Glenferrie R ^d & Wattle Tree R ^d	109. 111-113.
Malvern Town Hall Crossover to Depot and to			Coldblo R ^d & Depot & Repair Shops.	115-117.
Esplanade, Dandenong R ^d & Darling R ^d		23	Kew Depot	119-121.
Dandenong Road.		33-35	White Horse Road	123-124.
Balaclava R ^d & Hawthorn R ^d North		37		
Balaclava R ^d Junction to Esplanade				
Darling R ^d & Depot		39		
Balaclava Road East		41		
Depot to Dandenong R ^d Curve		39		
Dandenong R ^d East & Waverley R ^d		45-47		
Carlisle S ^t		49		
Esplanade to Darling R ^d Depot.				
Balaclava R ^d Junction. Malvern Station Xover				
Hotham S ^t . Malvern Town Hall Xover. Deepdene				51
Glenferrie S ^t Xover. Coltham R ^d Xover.				
Esplanade Loop		55		

Cotham + Glenferrie Rds

Kew -
Extension to Victoria B^{dge}

Kew
Hawthorn
Collingwood
Richmond

Extension to Skrathalbyn St

Kew

Miles	
Route	Track
2.13182	4.375176013
.834878792	1.69228884
.22191445	.45143399
.03666746	.06203664
.03666746	.08079798
1.2823469	2.59338896
2.4124750757	4.87994641

including (Kew Cotham + Glenferrie Rds)

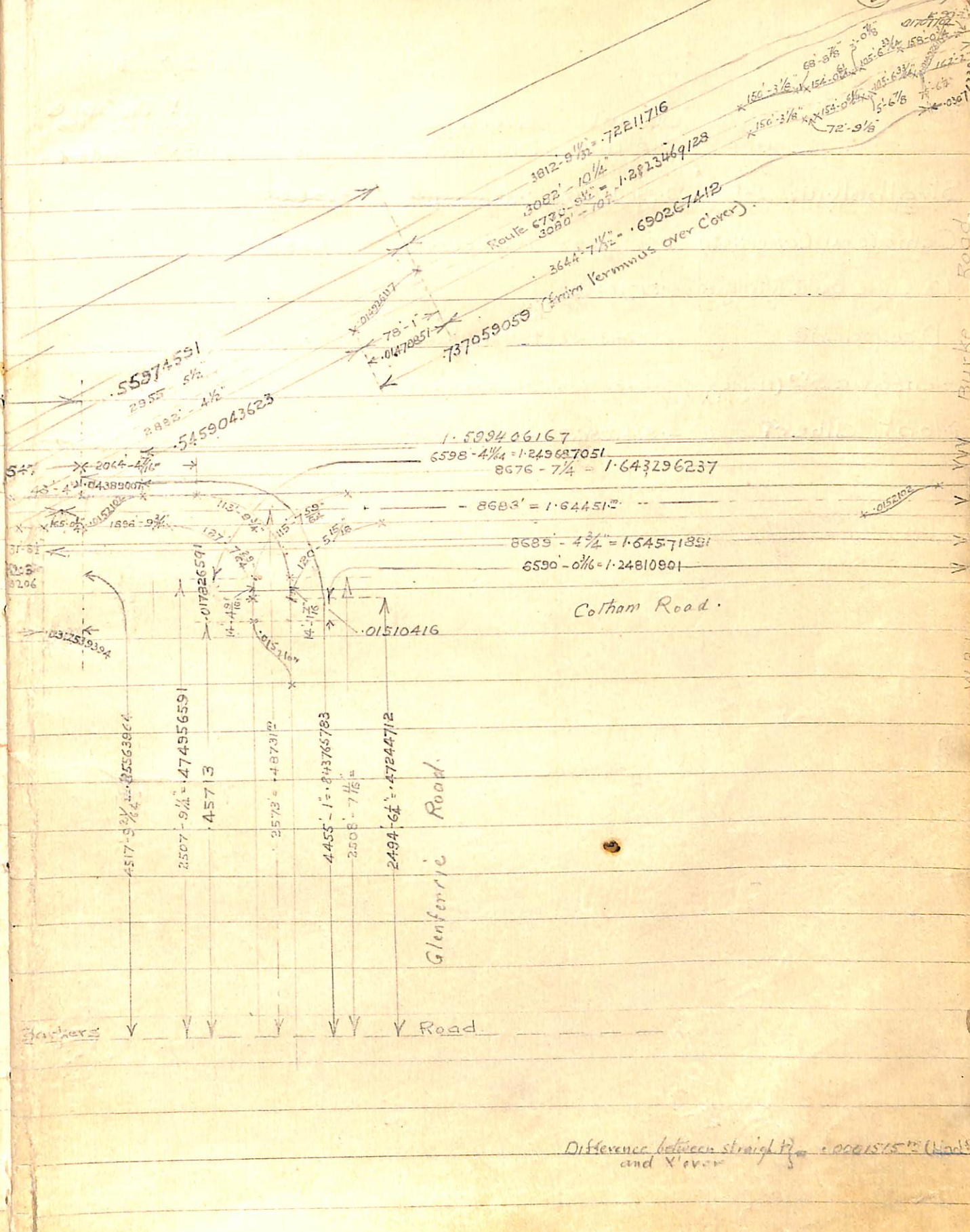
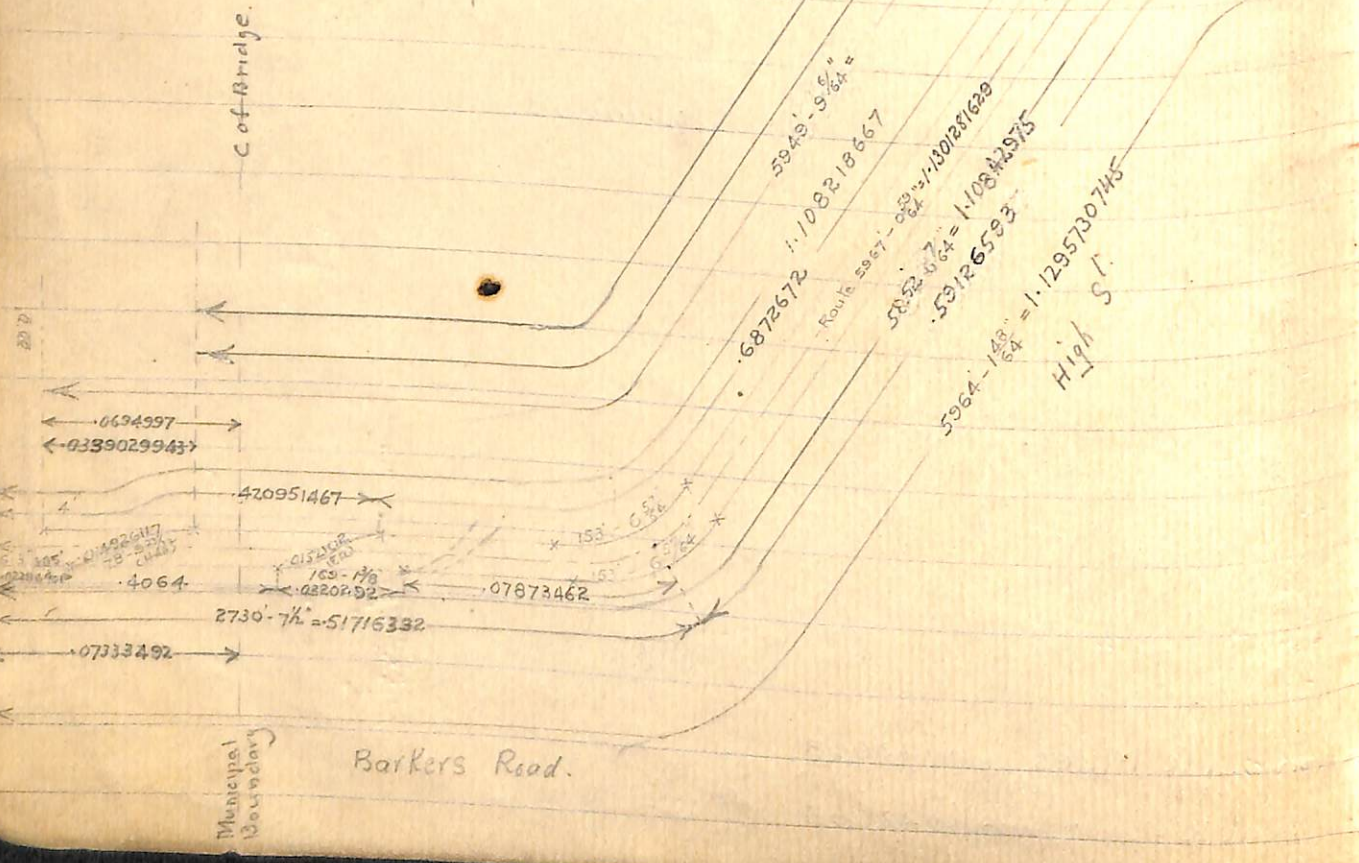

Difference between straight line and X over = 0.0001575 (inches)

Glenferrie Road

Hawthorn

Road

Barkers

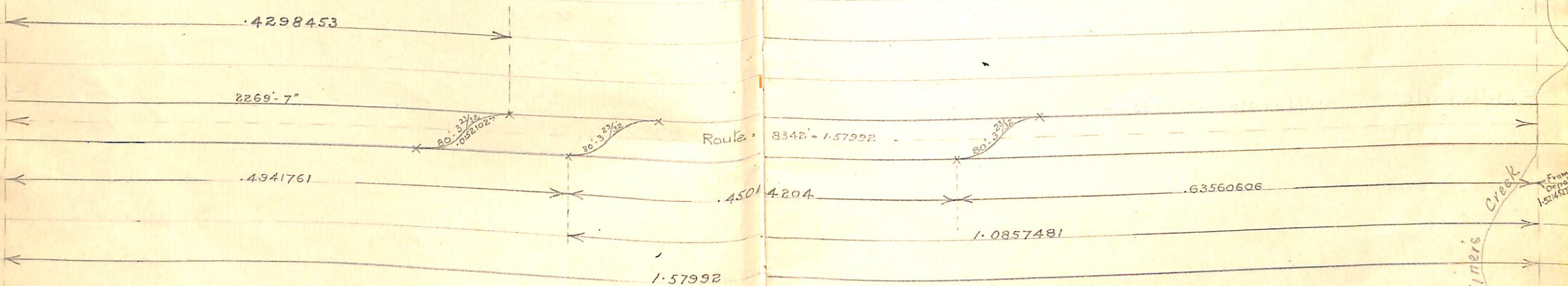

Difference between straight and Crossover = .0001515

Route Miles = 1.57992

Track " = 3.205479

Gardiners Creek
From Depot 1.5214571

Glenferrie Road.

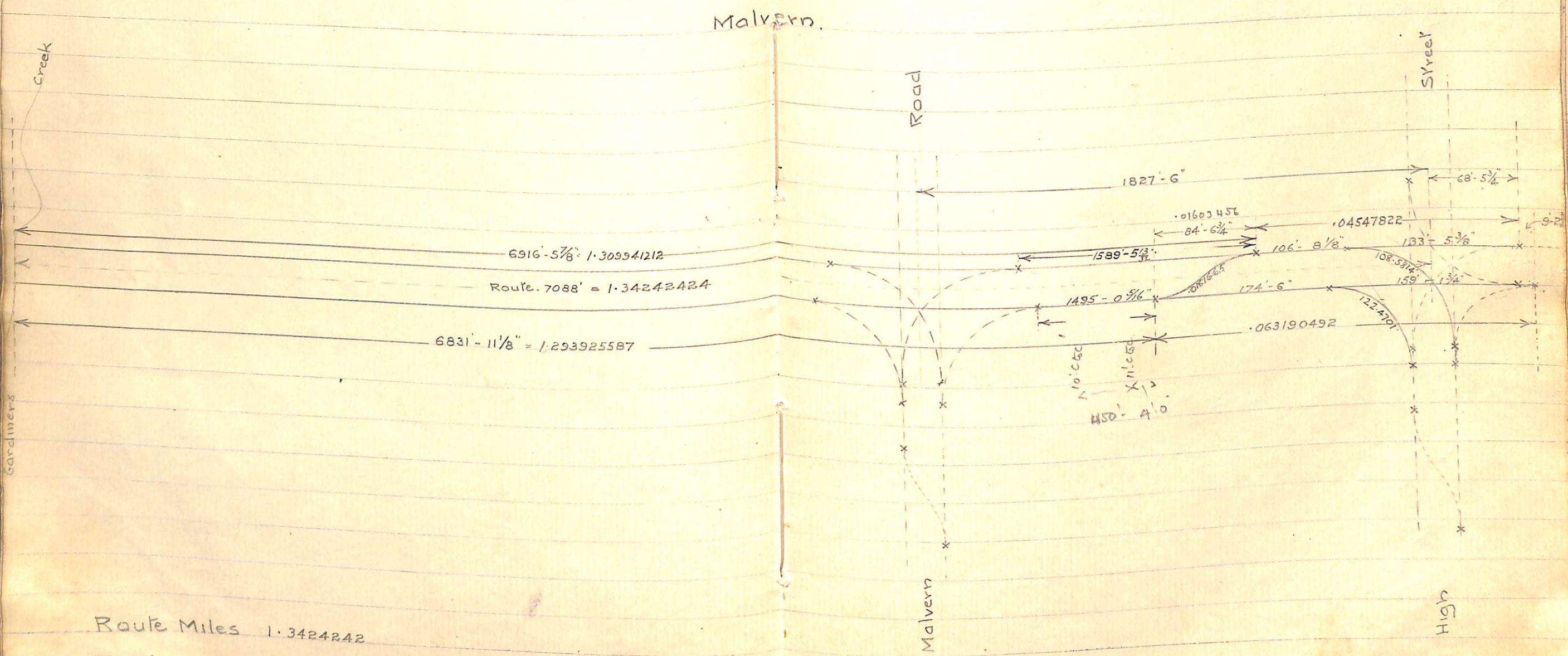

Route Miles 1.3424242

Track " 2.7724620

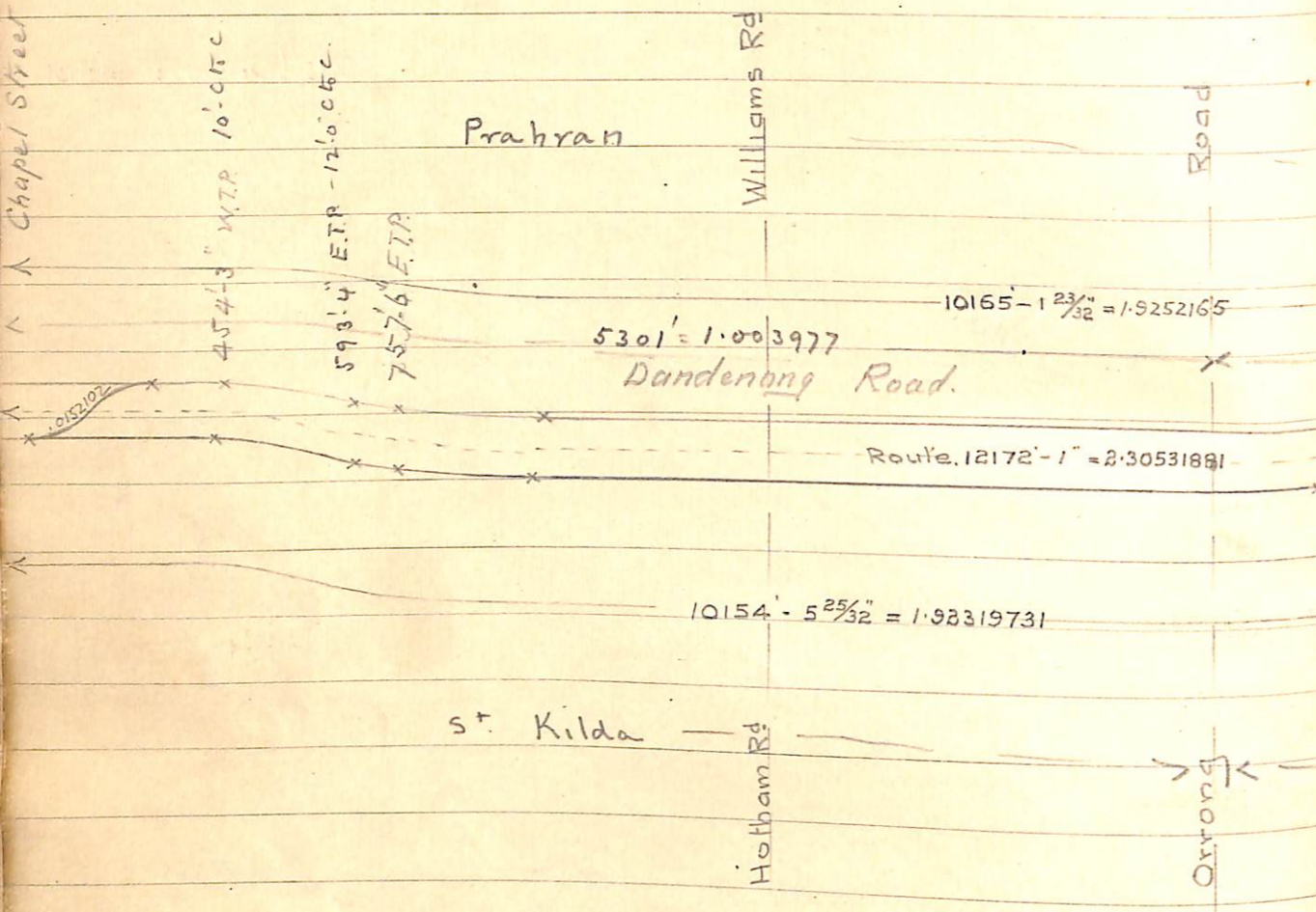

Route Miles = 2.30531881

Track " = 4.71922651

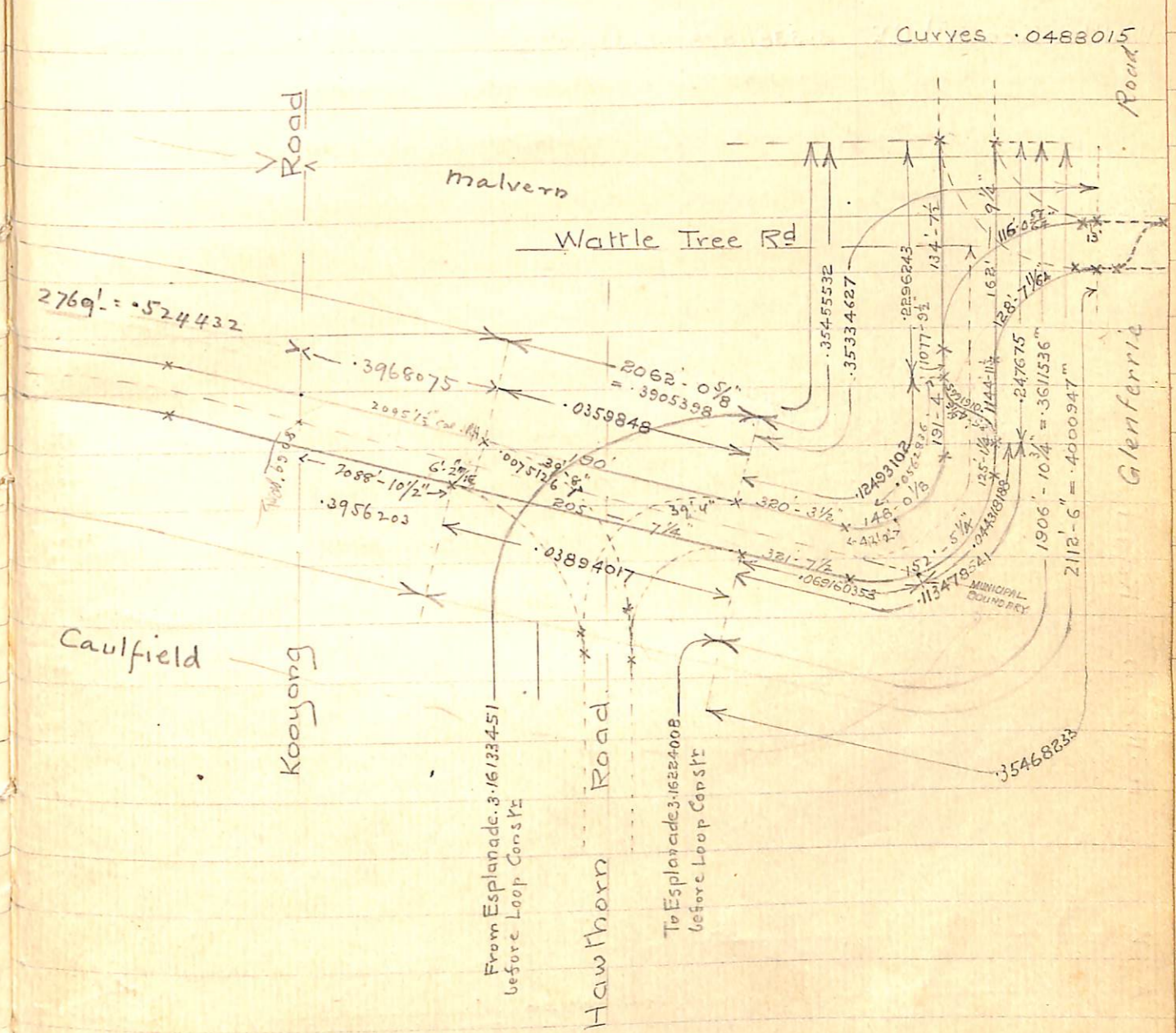

Dandenong

Holham Road

Balaclava Rd

Balaclava Rd

1.43449198^m

Route 7653 - 2" = 1.449463^m

2699 - 6 4/4" = .51128053
2733 - 11 25/64" = .51779341

2721 - 1" = .51535669^m
2413 - 3 7/64"

2602 - 0 1/2" = .49281093
2402 - 9 1/64"

2710 - 11 5/64" = .513445

2703 - 6 17/32" = .5120349^m

2682 - 0 1/64" = .507958731^m

Hawthorn Road.

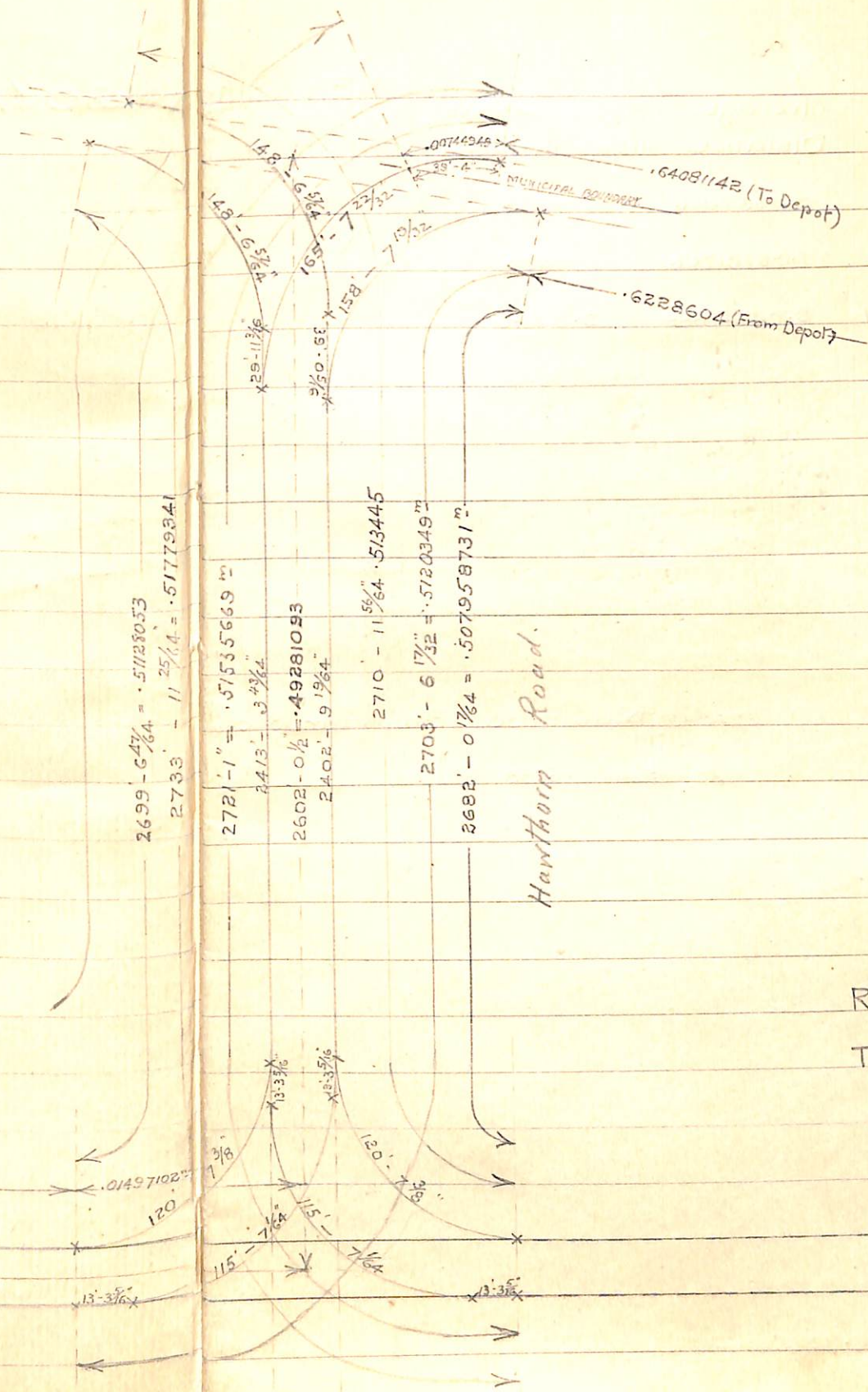

Route Miles 1.94227393

Track " 4.07128447

Road.

Hawthorn

Road

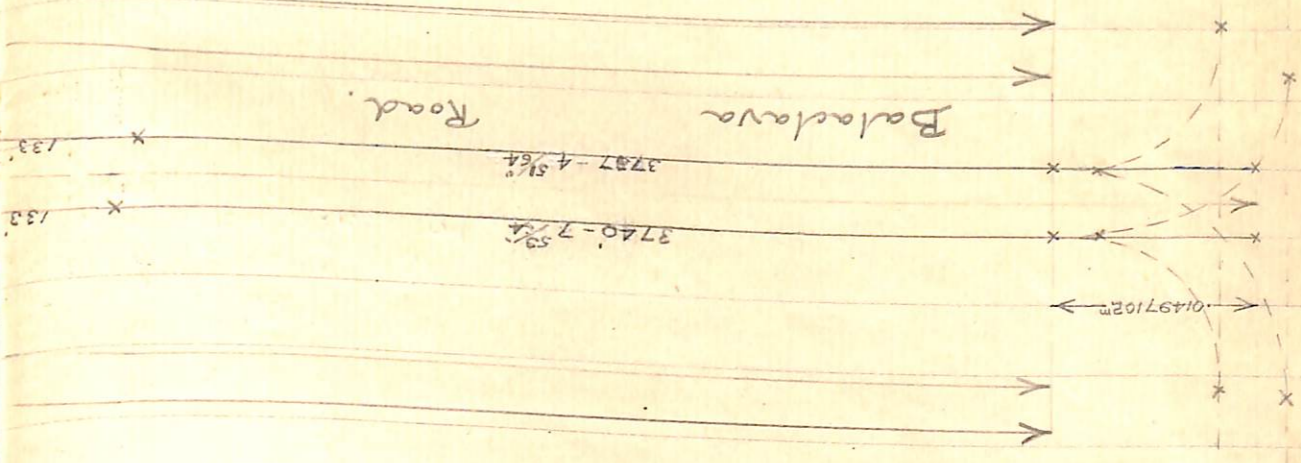

Route Miles .917235

Track " 1.80452968

MUNICIPAL BOUNDARY

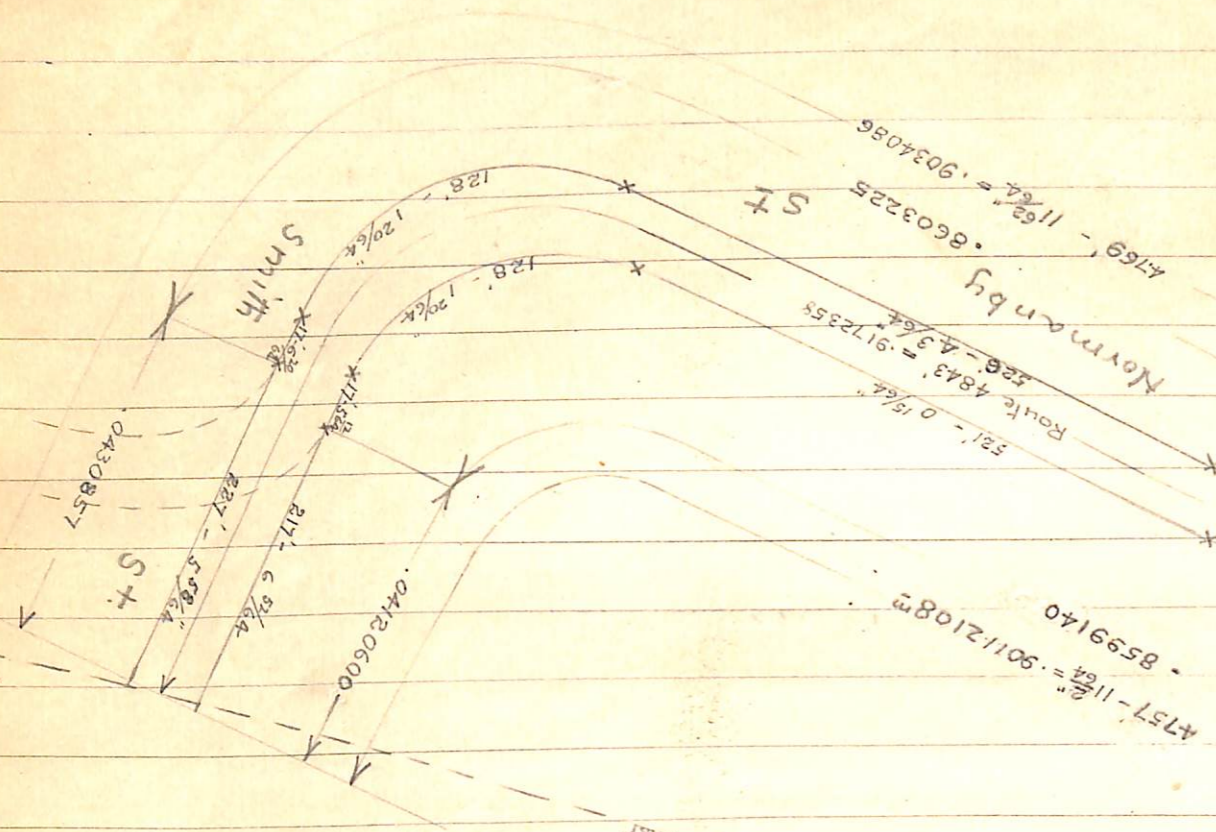

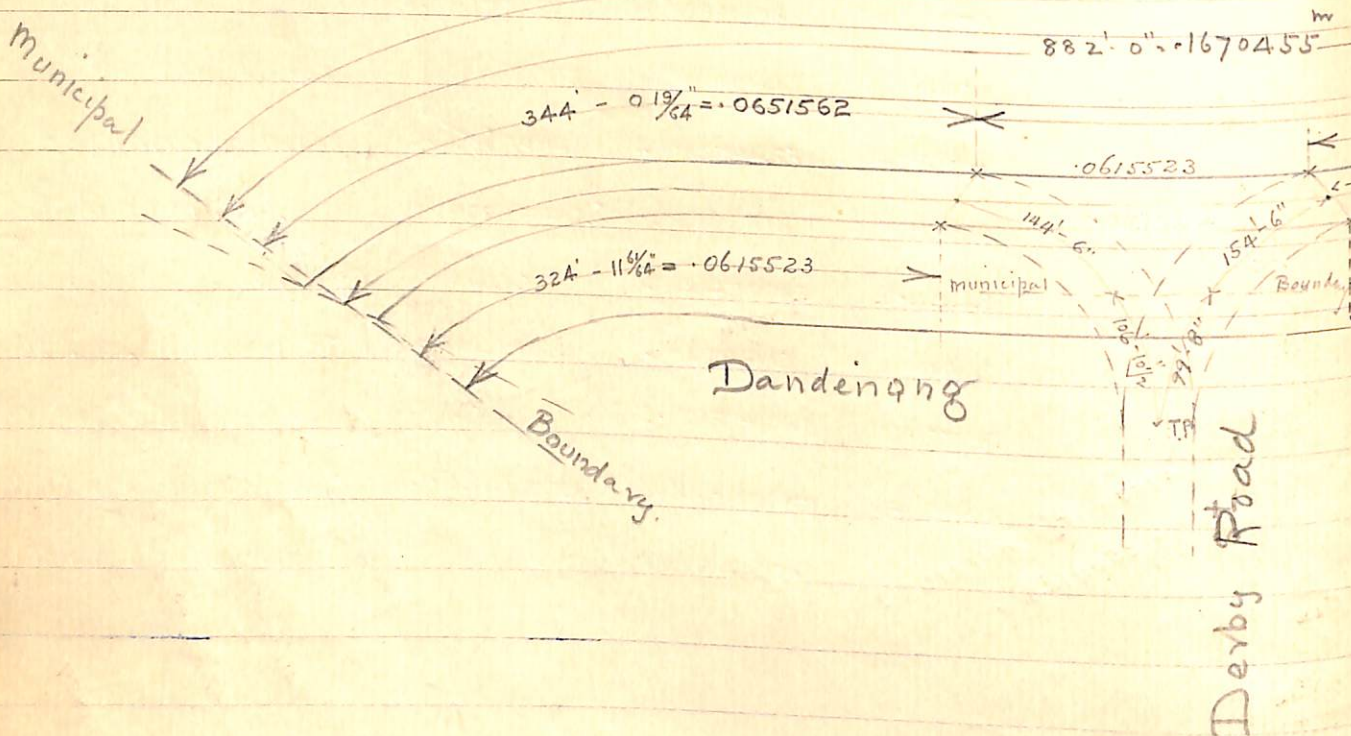

Route Miles 1.0437676
 Track " 1.26357435

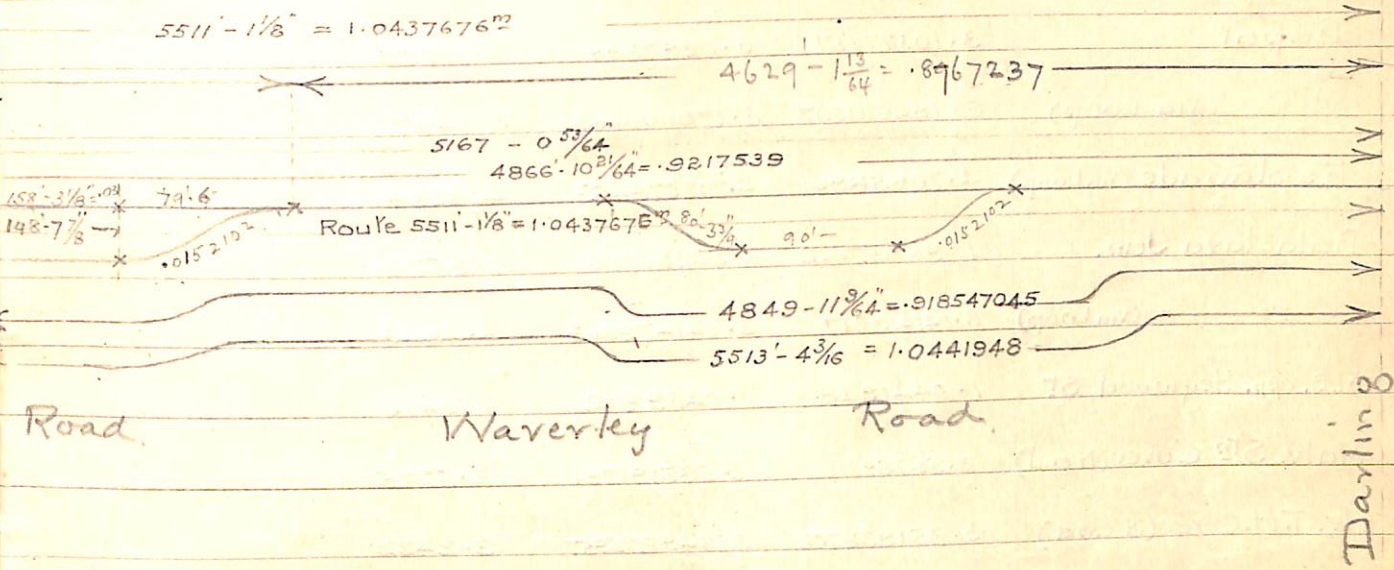

342

not

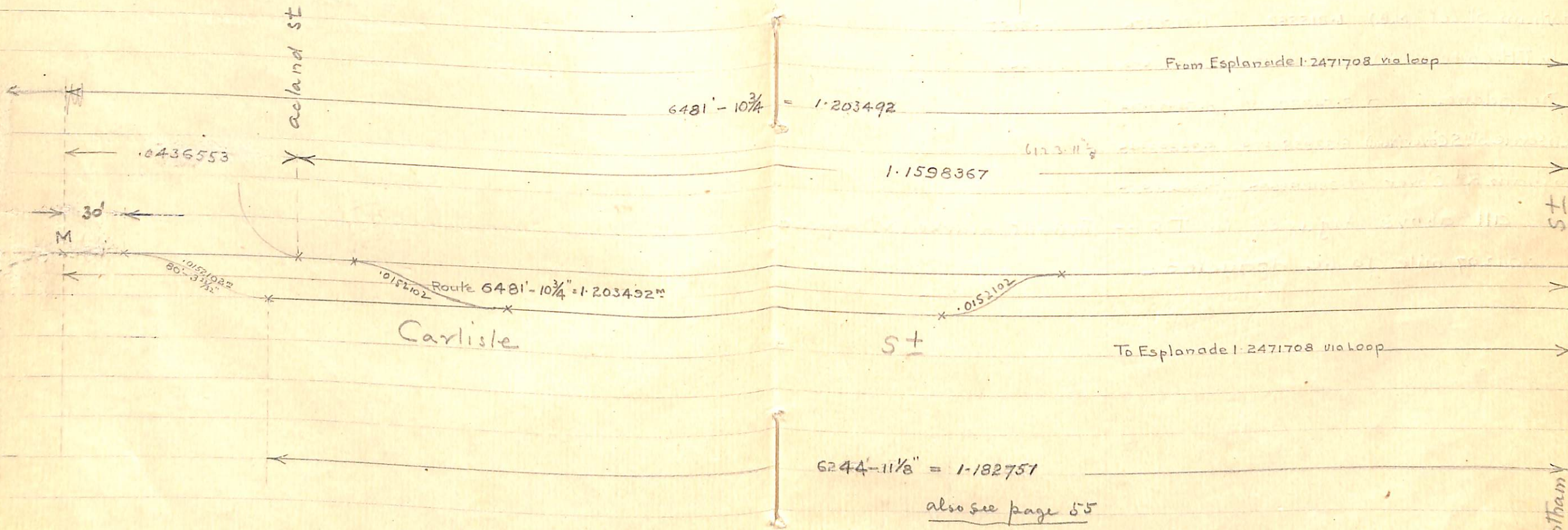

Route Miles 1.203492

Track 2.4318733

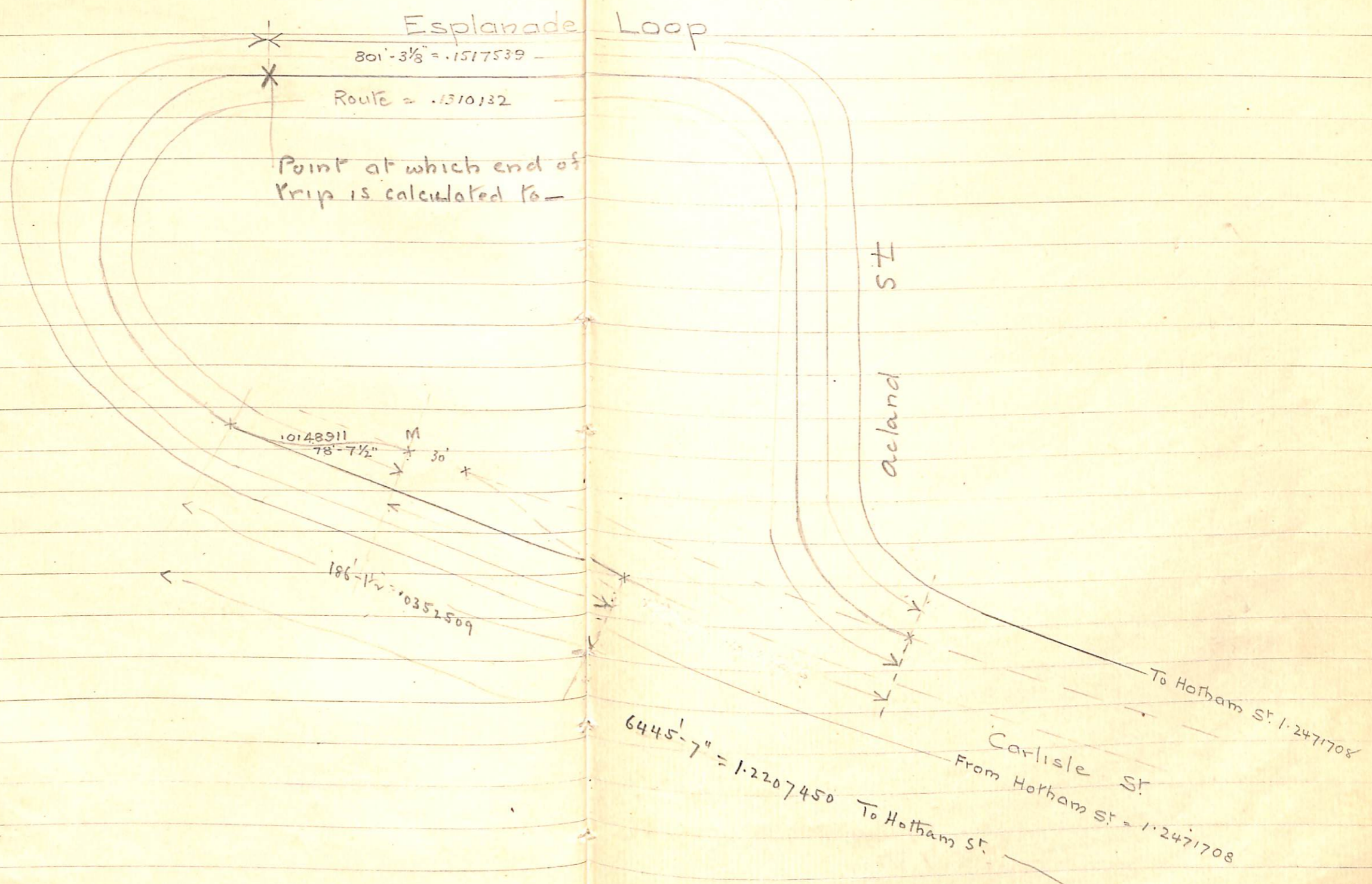

Route Miles = .1310132
 Track ' = .1666450

Route Miles } Caulfield .216719893
 Track " } Malvern .0136100
 Track " } Caulfield .472732932
 Track " } Malvern .118939394

From Depot 2.097096411

Dandenong Road
 MUNICIPAL

Caulfield Loop

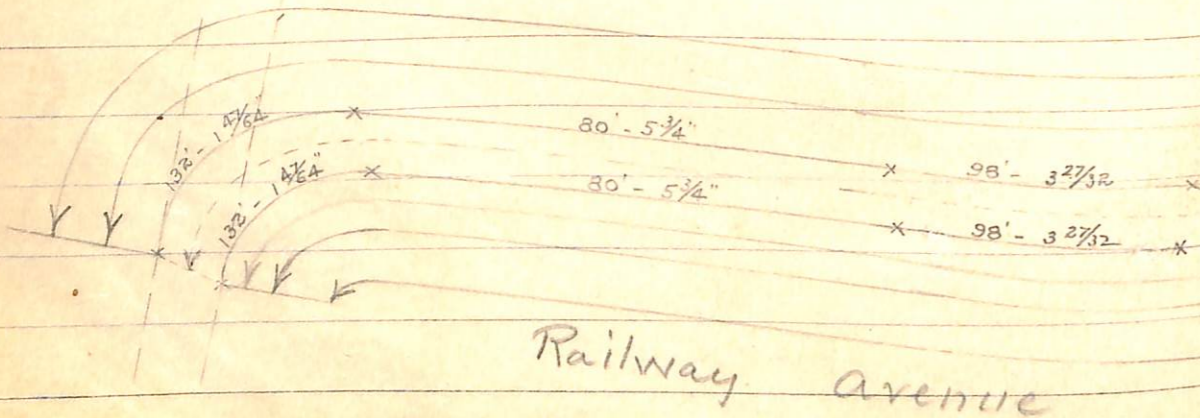

11-7-15

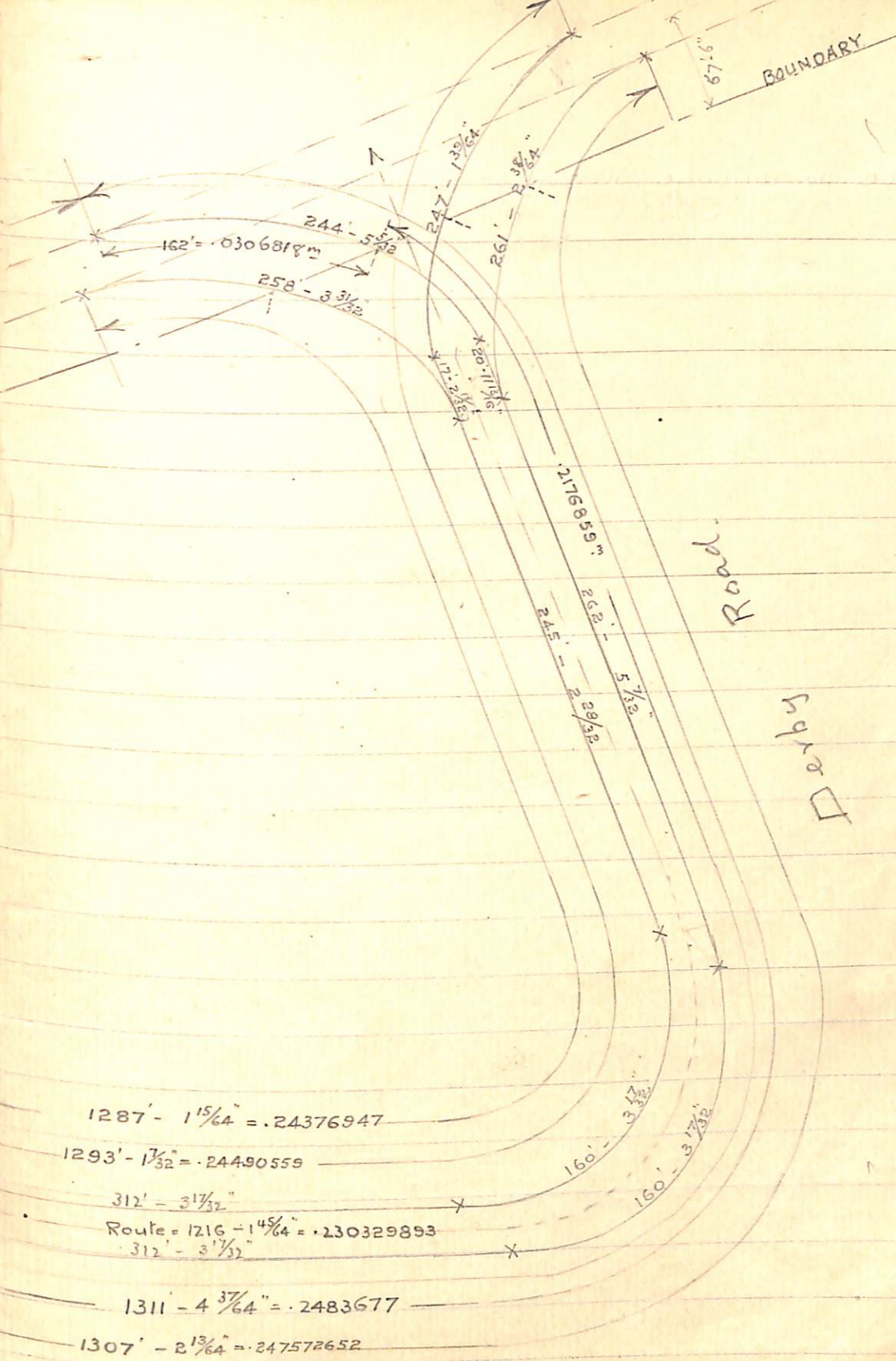

Point Ormond Extension.

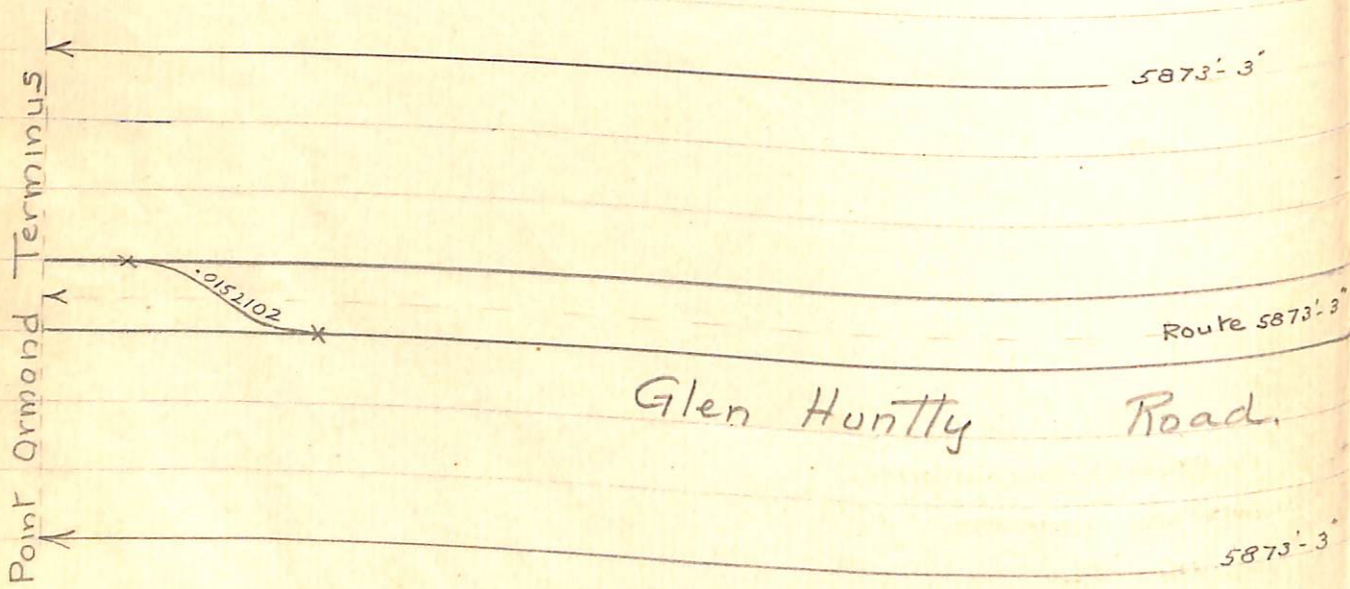

	Route	Track.
Brighton	.181385	.24277
Caulfield	.016855	.03371
St Kilda	.974115	1.9634402
Total	1.112355	2.2399202

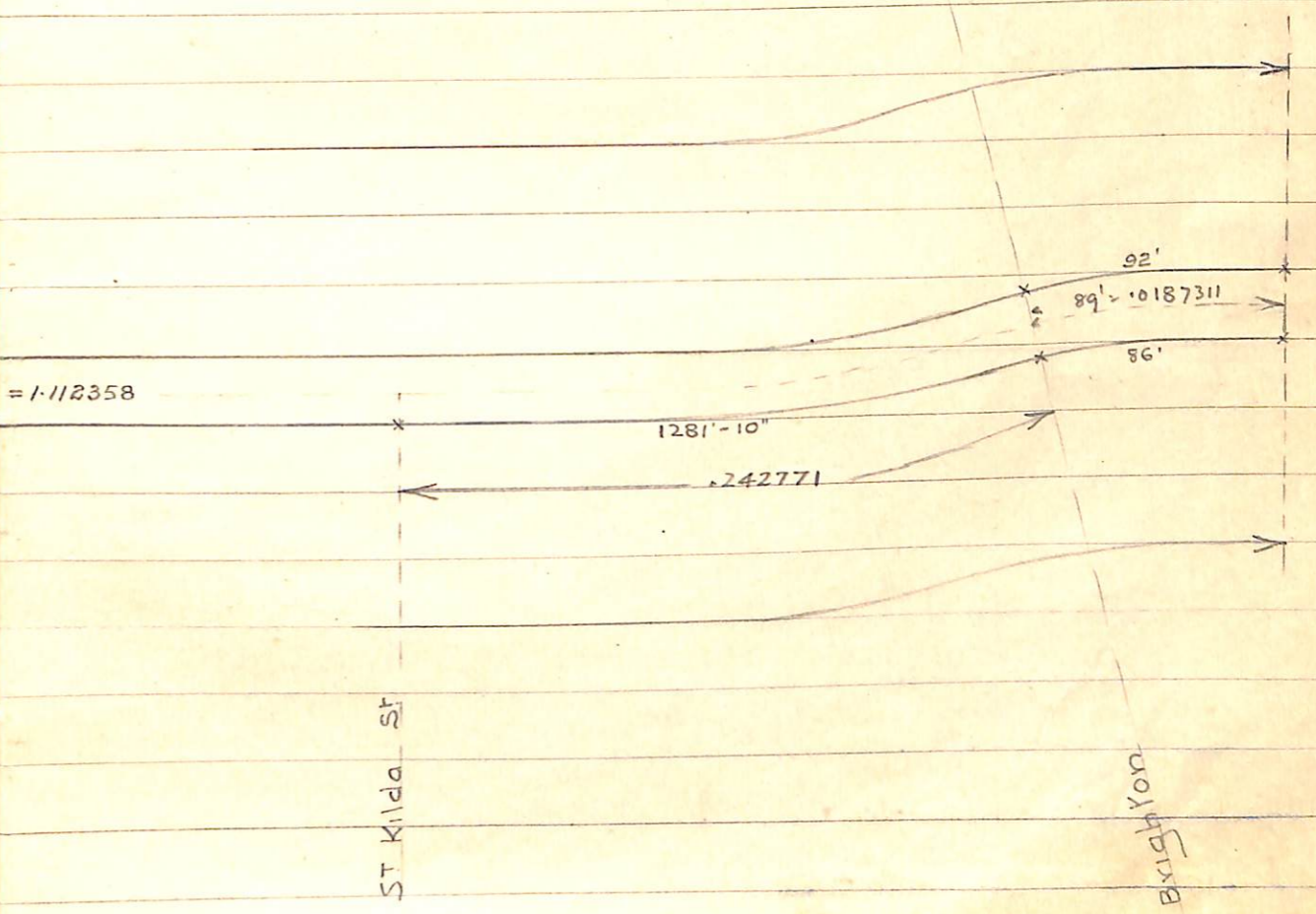

Glen Huntly Road.

Caulfield.

Hawthorn Road.

Railway

Brighton

Glen Huntly Road

Poplar St

E.B.L. Hawthorn Rd

Road.

Grange

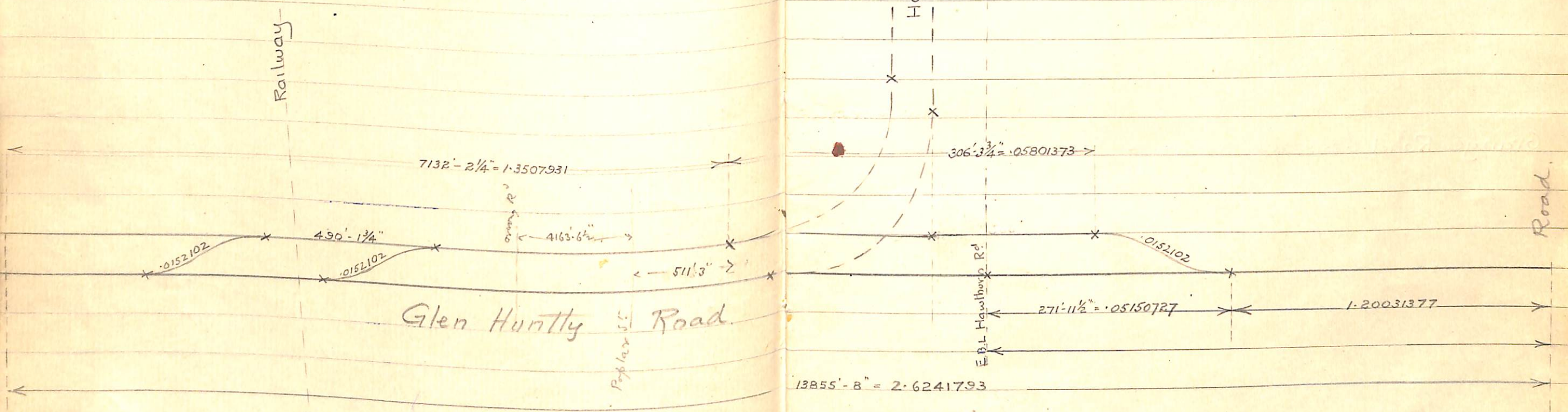

Route Miles 2.6241793

Track " 4.07861673

Balaclava

Hawthorn Road

Road

Special Work .0894694

Caulfield

Hawthorn Road

Curves .0492052

From Pt Ormond 13005' - 5 1/4" = 3.43473010

From Pt Ormond 18135' - 4 1/2" = 3.43473010

Glen Huntly Road

To Pt Ormond 18155' - 6" = 3.43854167
 .0001515 over Xover.
3.43869317

Route Miles .9933751

Track .0894694

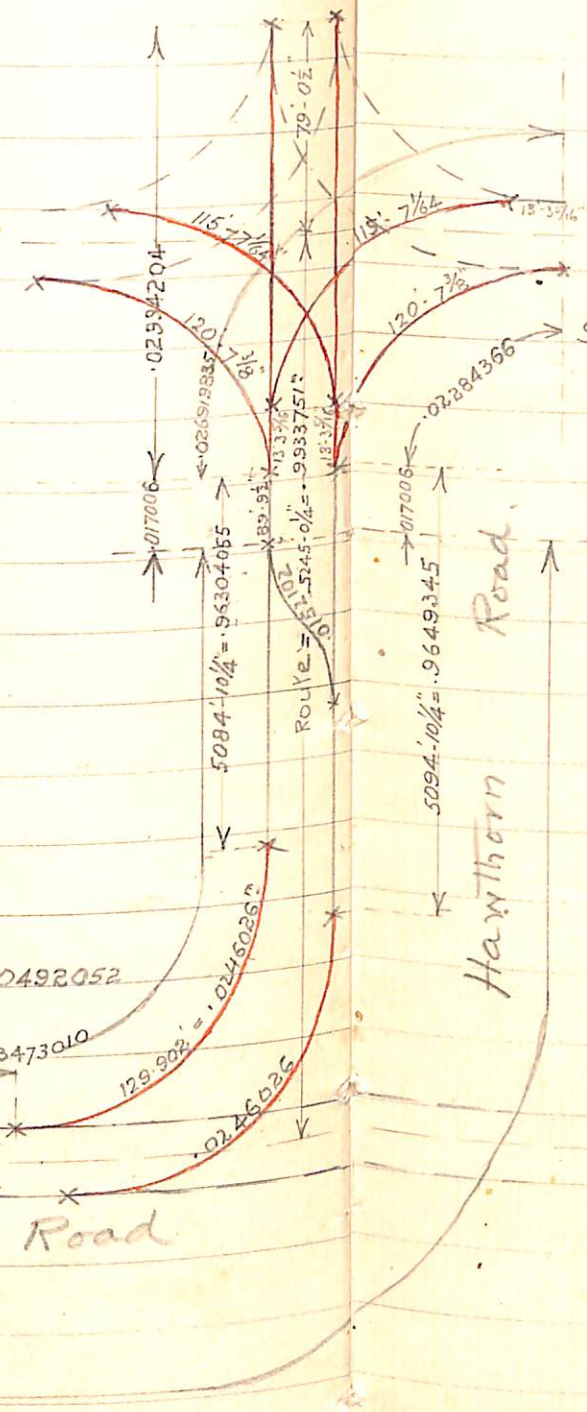

Commercial Road

Melbourne

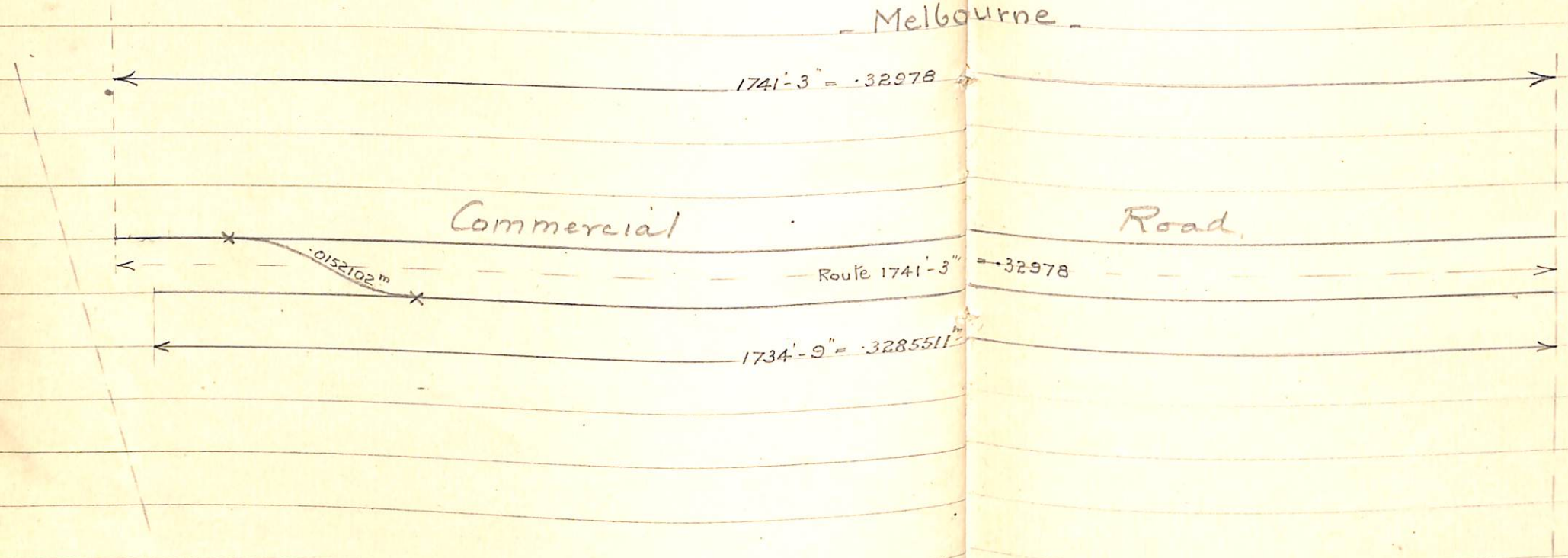

Double Track .329165

Route Miles .32978

Track " .6735413 (crossings included)

Malvern Road

Prabran

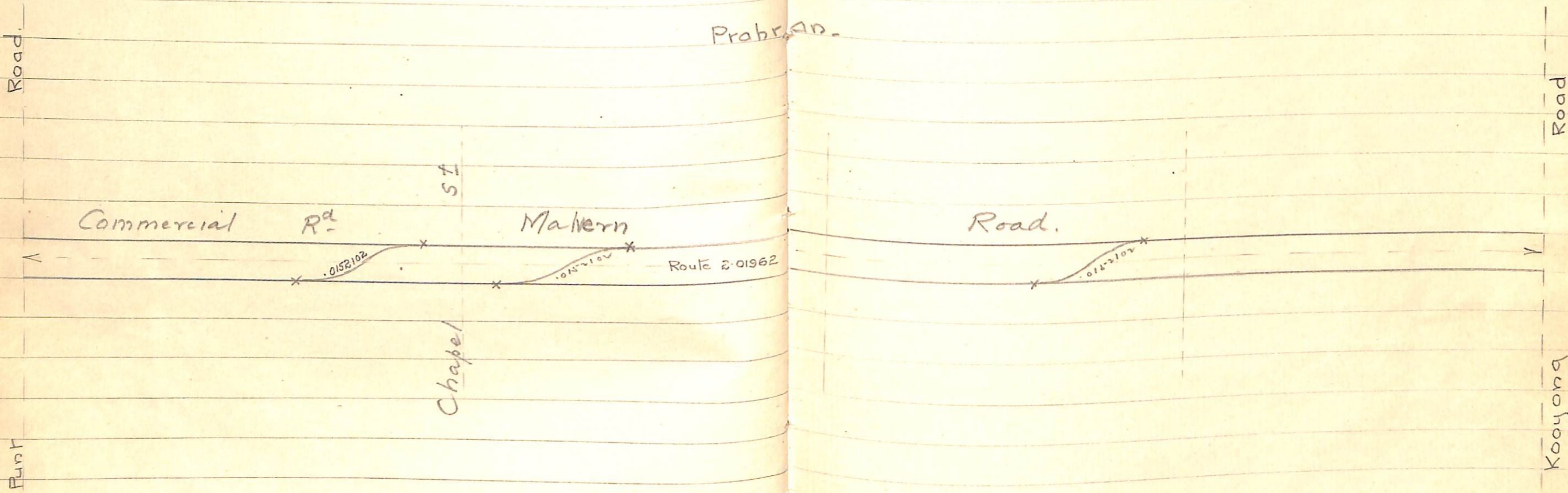

Route Miles 2.01962

Track " 4.0848706

Malvern Road.

08717077 = Curves at Glenferrie Rd

Malvern.

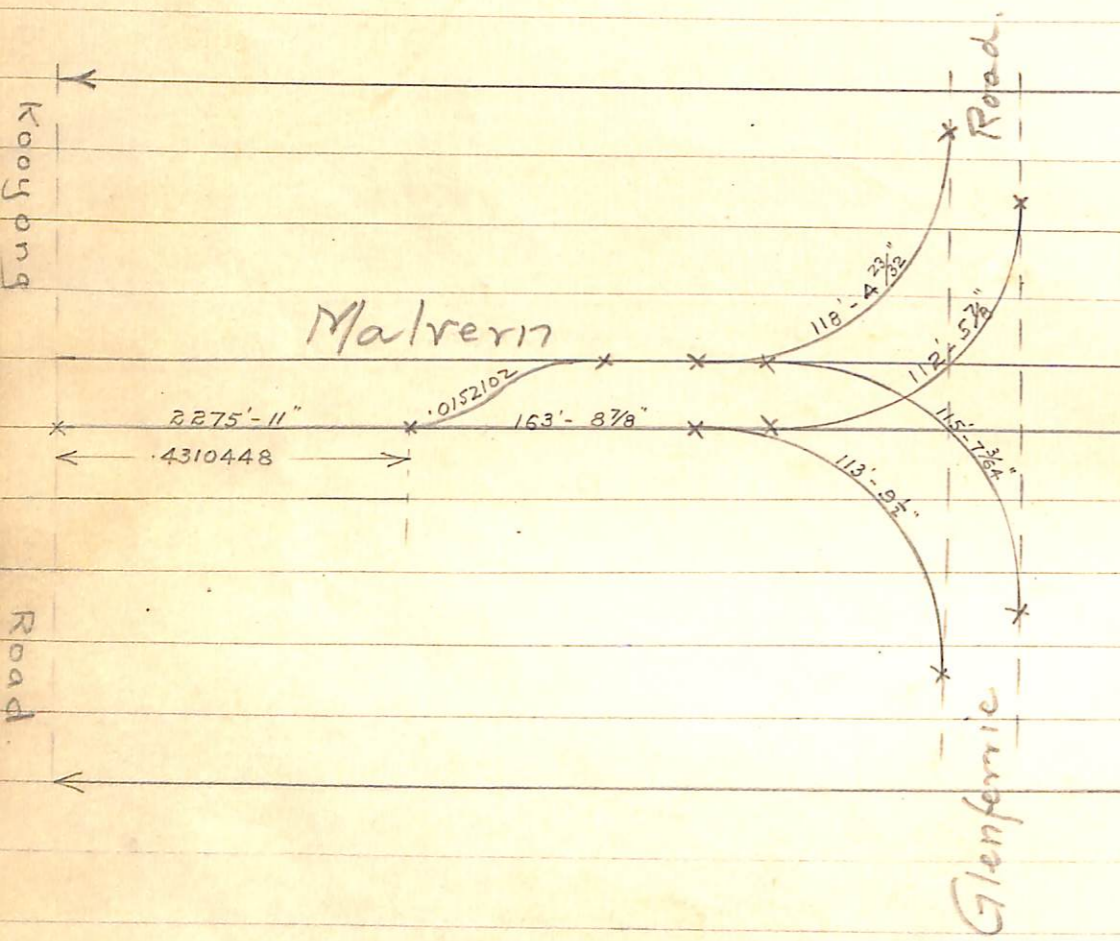

1.70103

Road.

1.68995

Route Miles 1.70103

Track " 3.50857117

High Street

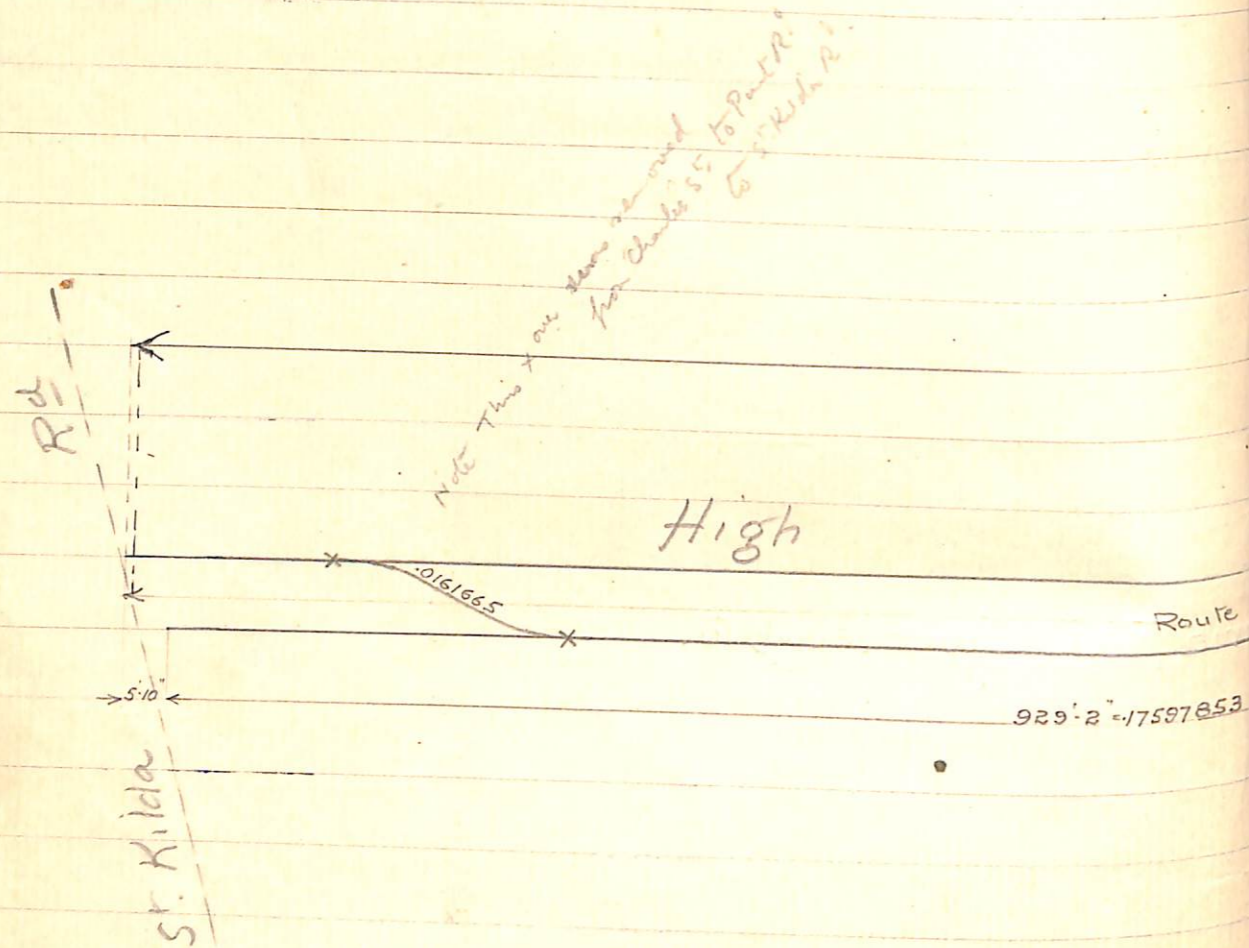

968' = 0.1833 miles

935' = 17708000 St

935' = 17708333

929.2 = 17597853

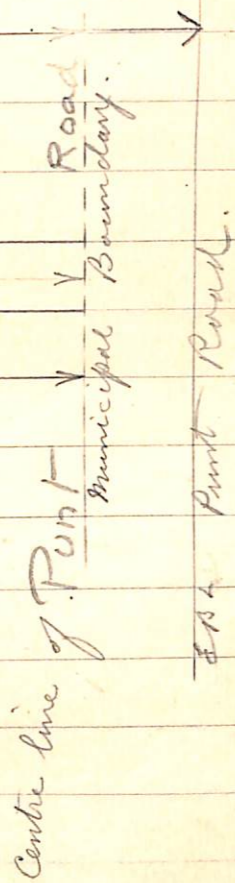

	Melbourne	St Kilda
Route Miles	.088541	.08854166
Track	.18616658 .18516656	.18406178

High Street

Prabran

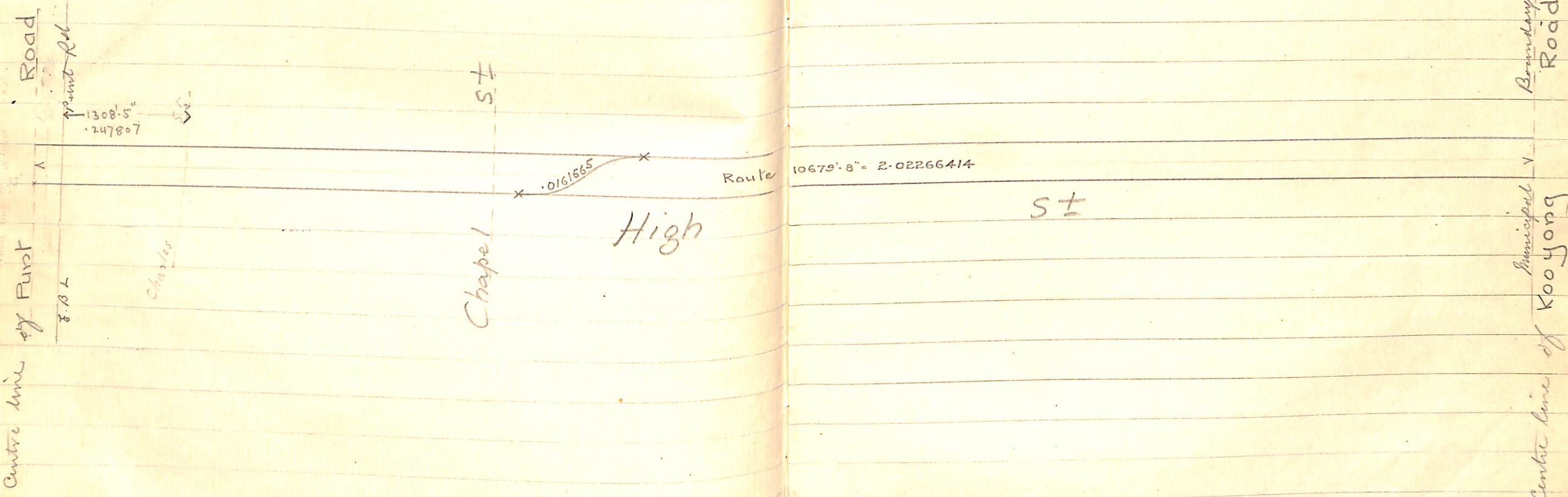

Route Miles = 2.02266414

Track = 4.06149478

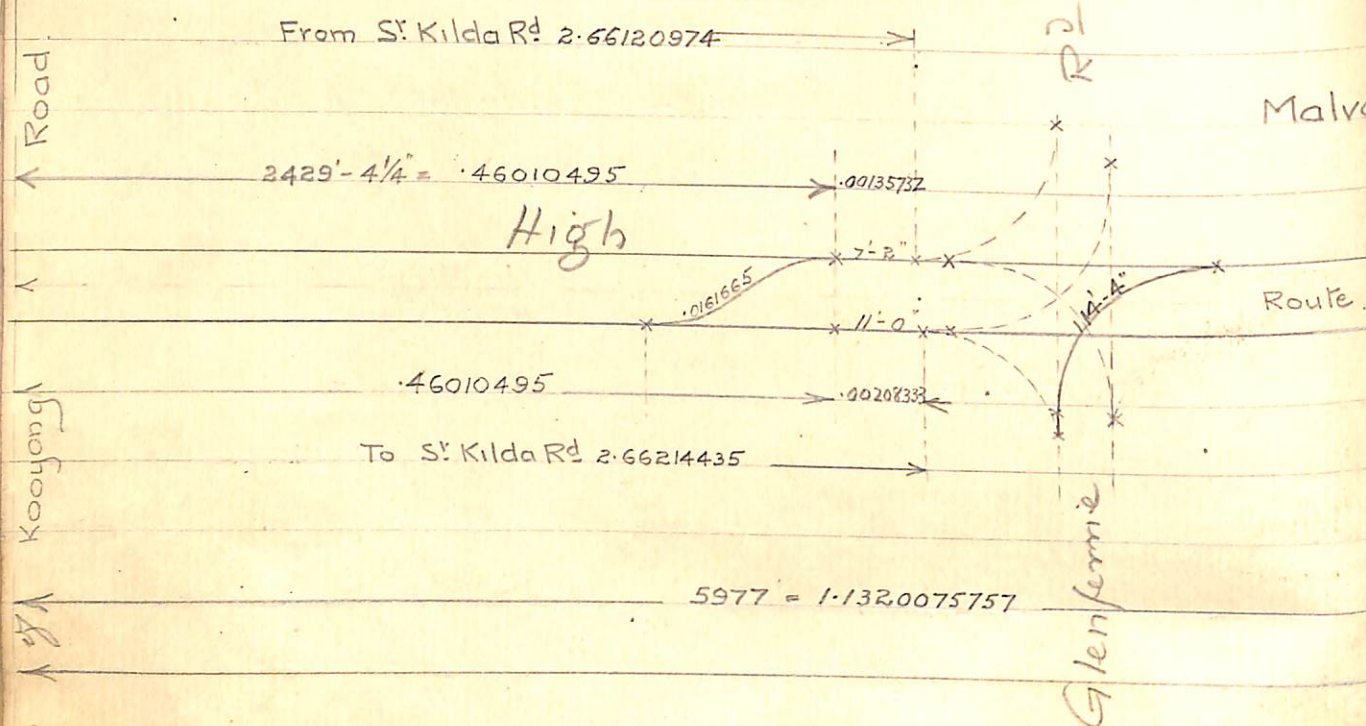

0.021654 Curve Glenferrie Rd to High St

11' Crossover difference between straight + Xover = .0002086

Route Miles 2.0098011

Track " 3.4215212928

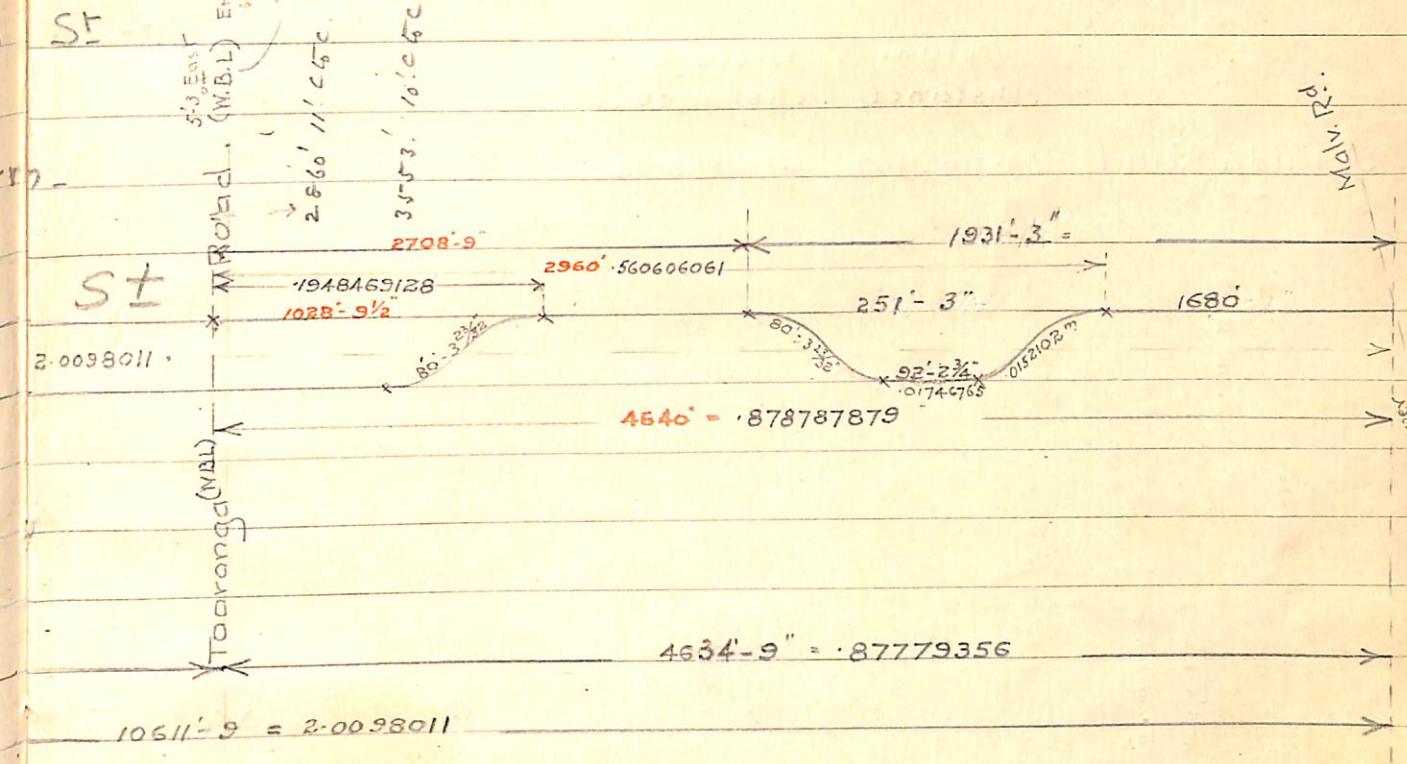

Note - All figures in red are surface measurements taken from Mr Henderson's Book No 10, page 35.

Difference between straight + Xover = .00015

Track Miles Car Shed = .58850714 = 3107' - 3 1/16"

Workshops = .26692116 = 1409' - 4 1/8"

.85542830^m

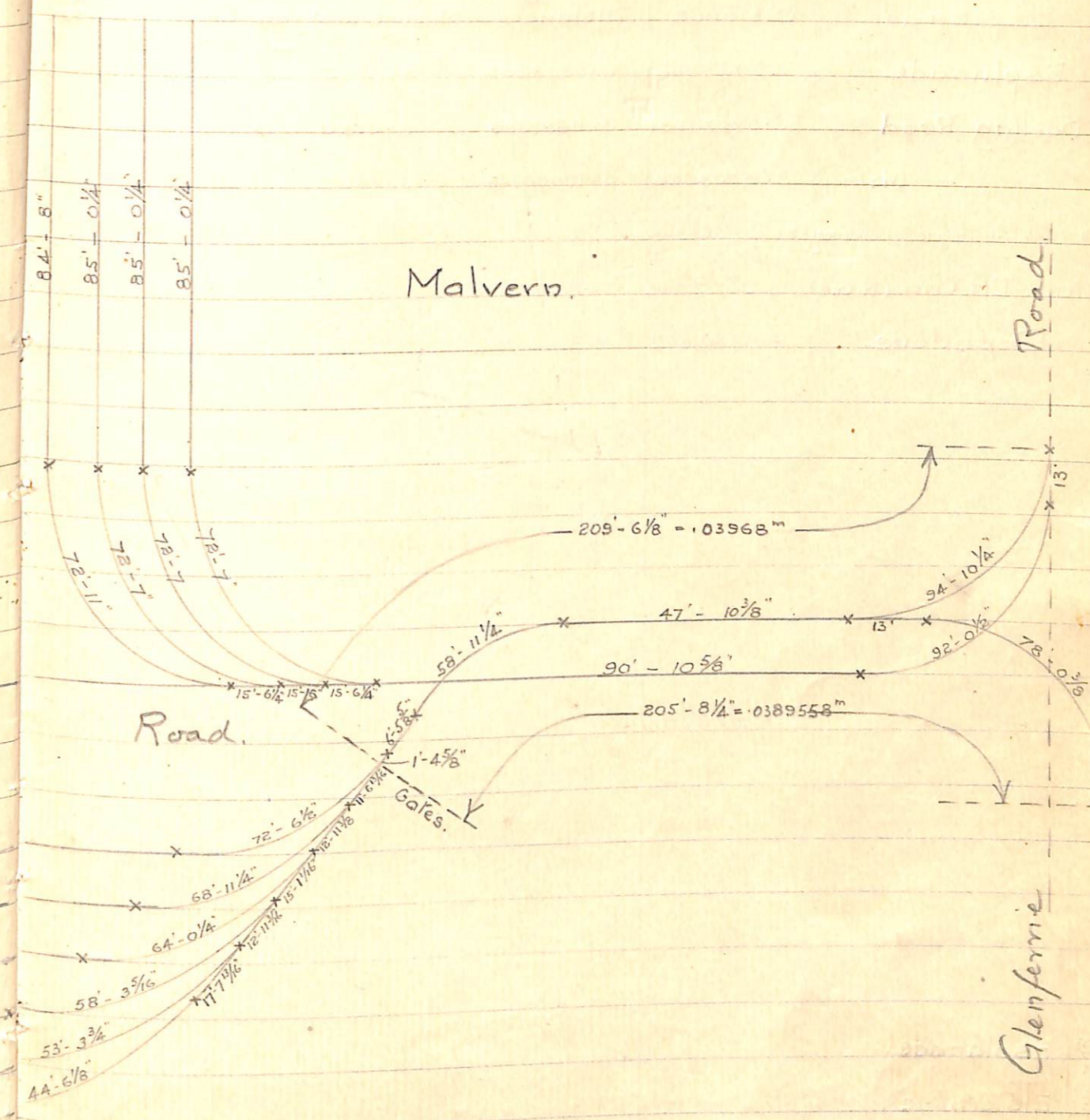
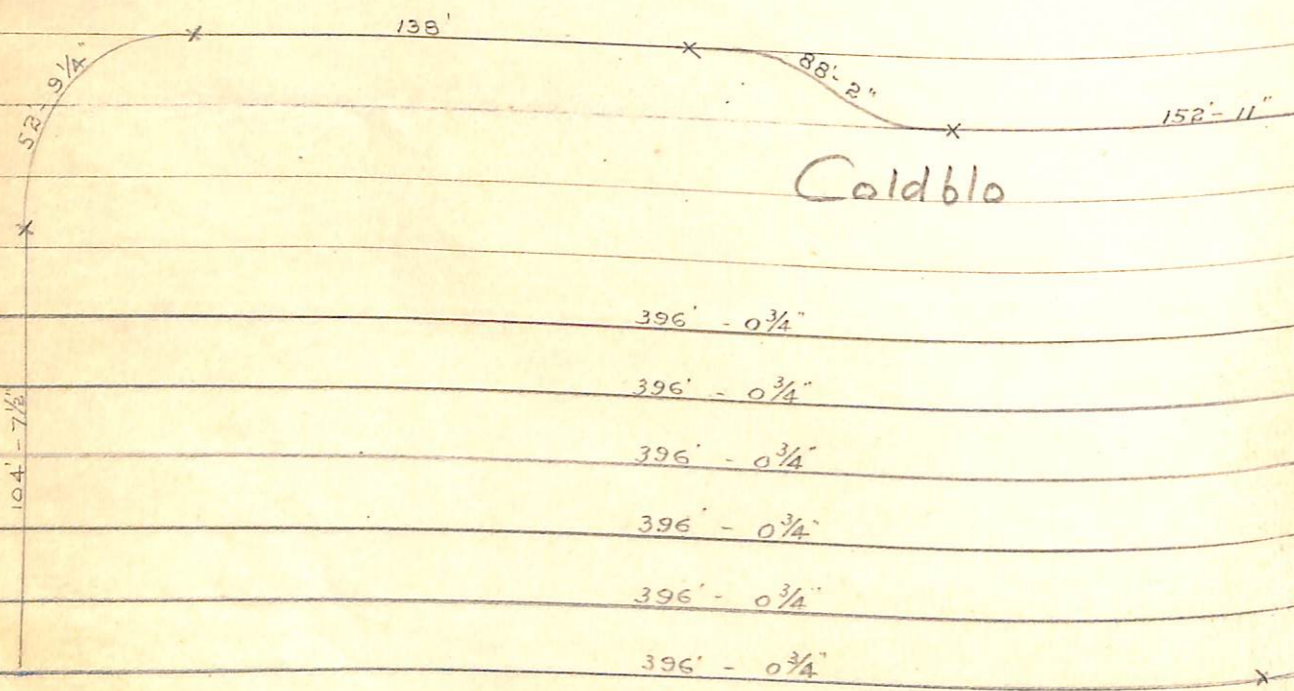

Kew Depot.

Bowen St

Barkers

Road.

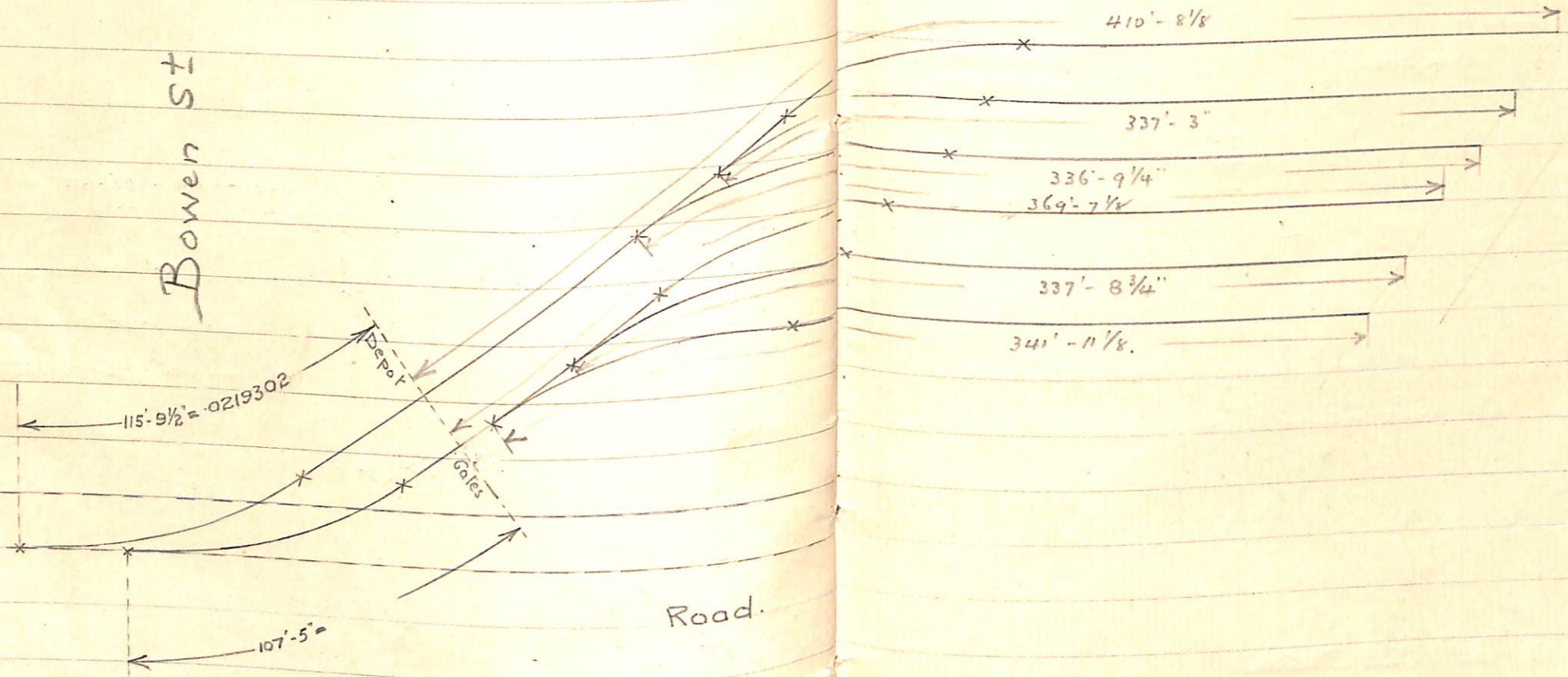

Track Miles	.40415679	(inside Gates)
	.02034406	
Total	<u>.42450085</u>	

White Horse Road

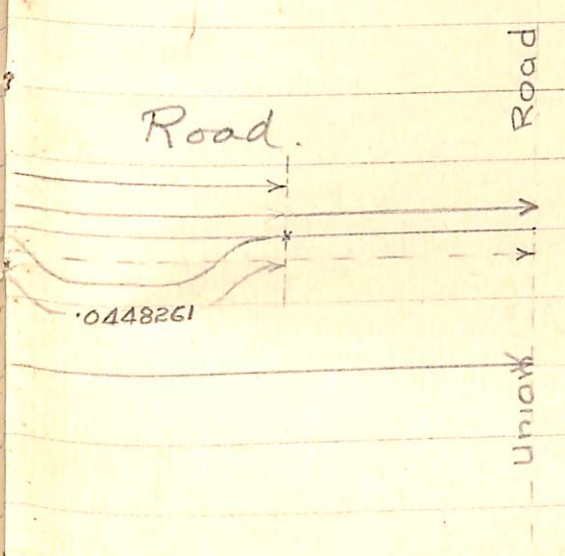
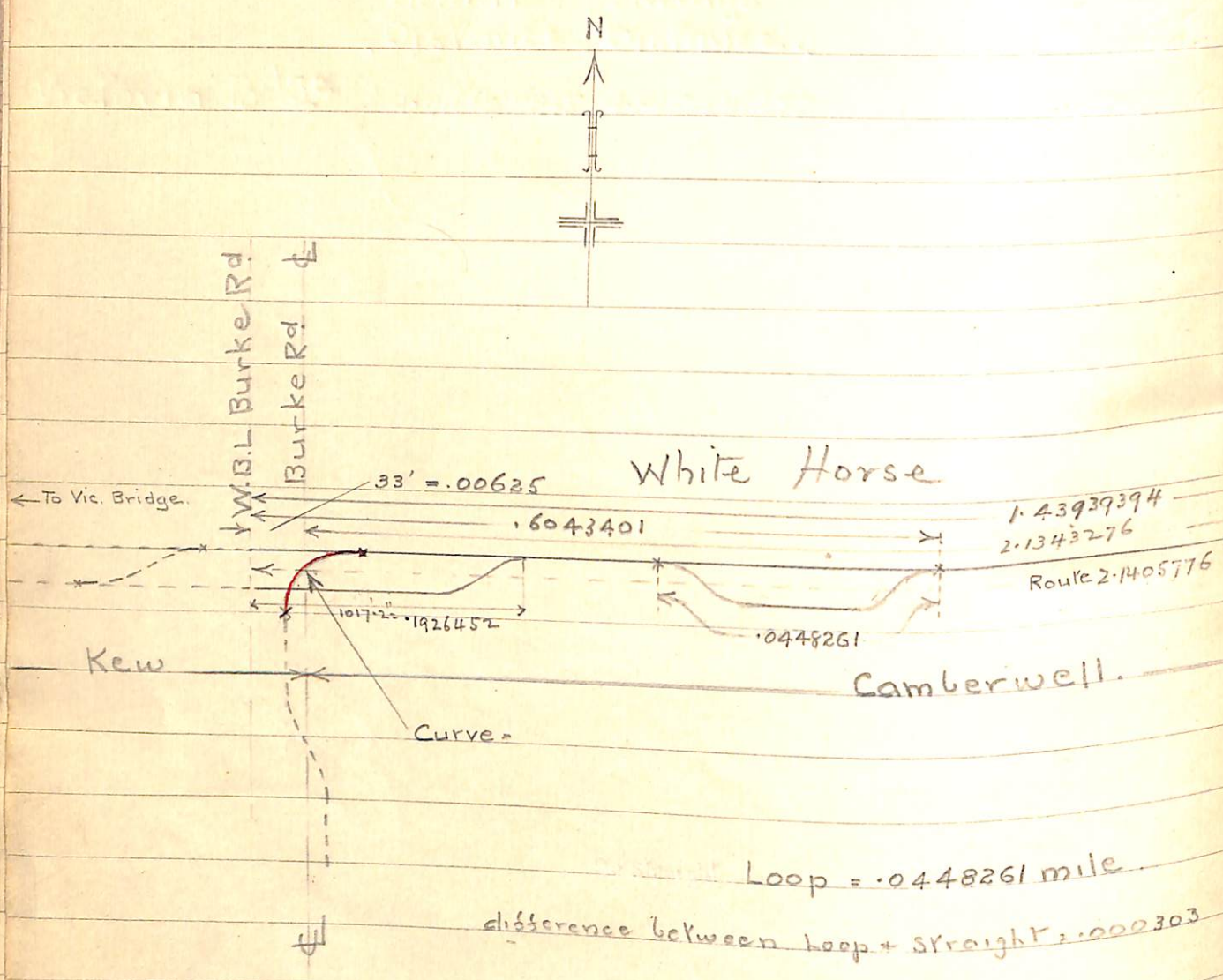

	Kew	Camberwell	Total
Route Miles =	.00625	2.1343276	2.1405776
Track Miles =	.00625	2.2239798	2.2302298

Curve excluded.